

2003 Eliminator 125 (Canada Only) PARTS DIAGRAM

Crankcase

E1411

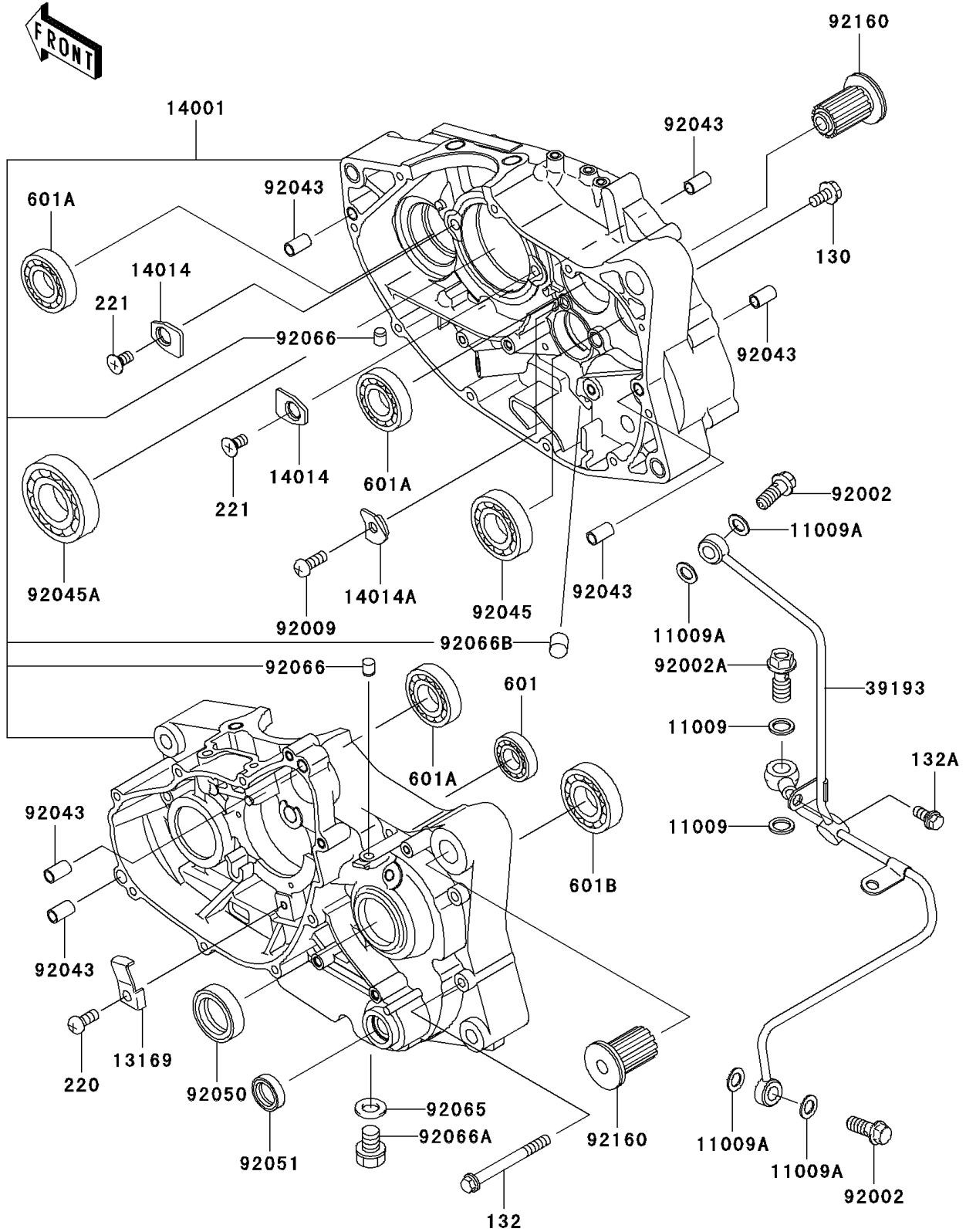

2003 Eliminator 125 (Canada Only) PARTS LIST

Crankcase

ITEM NAME	PART NUMBER	QUANTITY
BOLT-FLANGED (Ref # 130)	130J0612	1
BOLT-FLANGED-SMALL (Ref # 132)	132V0660	11
BOLT-FLANGED-SMALL (Ref # 132A)	132Y0612	1
SCREW-PAN-CROS,6X14 (Ref # 220)	220B0614	1
SCREW-CSK-CROS,6X12 (Ref # 221)	221B0612	2
BEARING-BALL (Ref # 601)	601A6202Z	1
BEARING-BALL,#6204 (Ref # 601A)	601A6204	3
BEARING-BALL (Ref # 601B)	601A6304Z	1
GASKET,10X14.5X1.5 (Ref # 11009)	11009-1105	2
GASKET,8.2X14X1.0 (Ref # 11009A)	11009-1344	4
PLATE (Ref # 13169)	13169-1691	1
SET-CRANKCASE (Ref # 14001)	14001-1271	1
PLATE-POSITION (Ref # 14014)	14014-1057	2
PLATE-POSITION,DRUM (Ref # 14014A)	14014-1113	1
PIPE-OIL (Ref # 39193)	39193-1025	1
BOLT,BANJO,8X20 (Ref # 92002)	92002-1618	2
BOLT,OIL,L=23 (Ref # 92002A)	92002-1975	1
SCREW (Ref # 92009)	92009-1266	1
PIN,6.2X8X14 (Ref # 92043)	92043-1263	6
BEARING-BALL,6202X19 (Ref # 92045)	92045-1169	1
BEARING-BALL (Ref # 92045A)	92045-1420	1
SEAL-OIL,SC25376 (Ref # 92050)	92050-013	1
SEAL-OIL,TB13225.5 (Ref # 92051)	92051-005	1
GASKET,12X22X2 (Ref # 92065)	92065-097	1
PLUG,OIL LINE,7.2X8 (Ref # 92066)	92066-1012	2
PLUG,OIL DRAIN,12X15 (Ref # 92066A)	92066-1174	1
PLUG,10.5MM (Ref # 92066B)	92066-1355	1
DAMPER (Ref # 92160)	92160-1423	2