

# 1986 454 LTD PARTS DIAGRAM

Rear Wheel/Chain

F2240

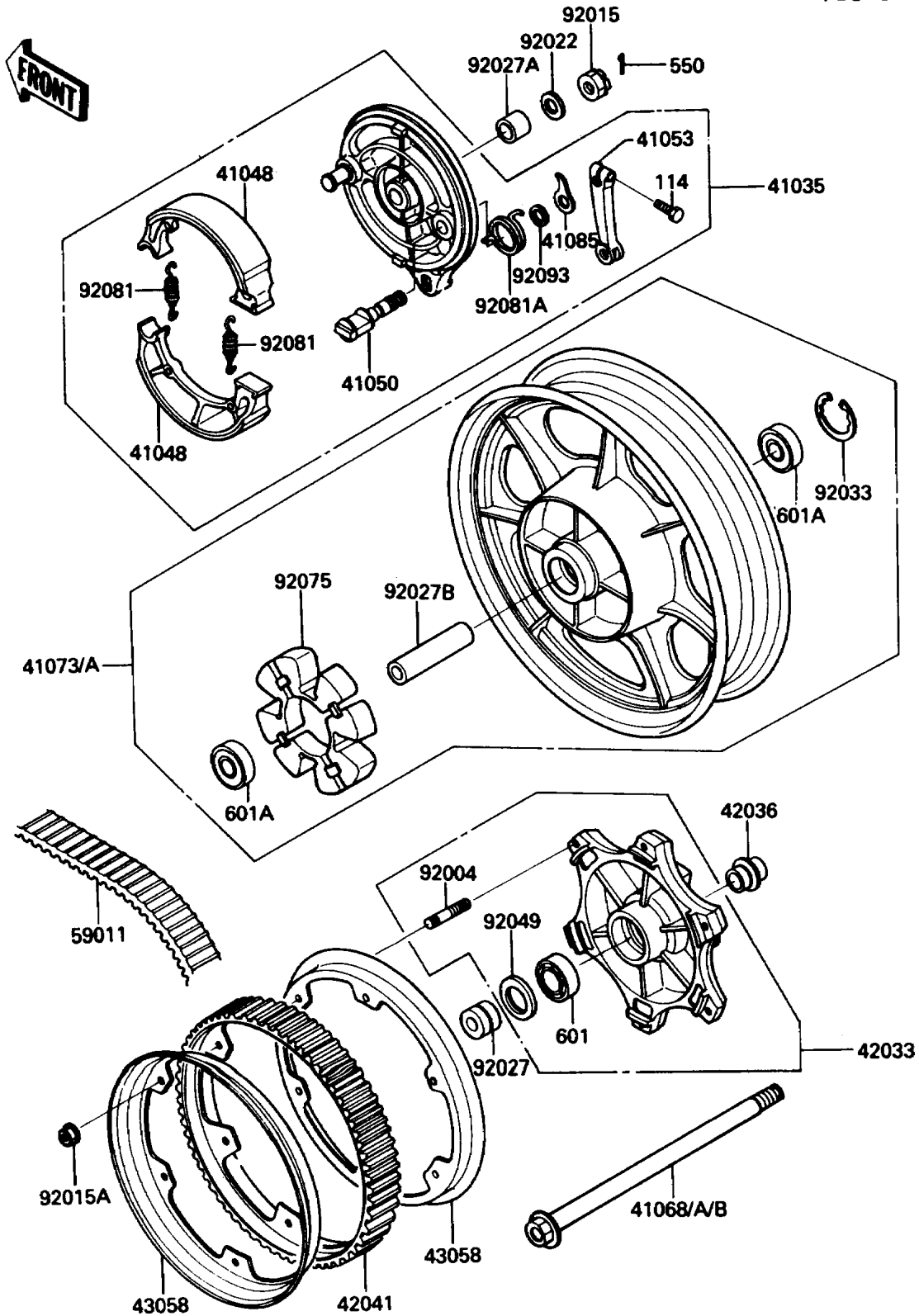

# 1986 454 LTD PARTS LIST

## Rear Wheel/Chain

| ITEM NAME                                    | PART NUMBER   | QUANTITY |
|--|---------------|----------|
| PANEL-ASSY-BRAKE,RR (Ref # 41035)            | 41035-1184    | 1        |
| SHOE-BRAKE (Ref # 41048)                     | 41048-1059    | 2        |
| CAM-BRAKE (Ref # 41050)                      | 41050-017     | 1        |
| LEVER-BRAKE CAM (Ref # 41053)                | 42029-039     | 1        |
| AXLE,RR (Ref # 41068A)                       | 41068-1205    | 1        |
| WHEEL-ASSY,RR,F.BLACK (Ref # 41073)          | 41073-1303-21 | 1        |
| INDICATOR (Ref # 41085)                      | 41085-1054    | 1        |
| COUPLING-ASSY,RR HUB (Ref # 42033)           | 42033-1113    | 1        |
| SLEEVE,RR HUB,L=33 (Ref # 42036)             | 42036-1146    | 1        |
| SPROCKET-HUB,68T (Ref # 42041)               | 42041-1195    | 1        |
| RING,HUB SPROCKET (Ref # 43058)              | 43058-1054    | 2        |
| BELT,DRIVE,128T (Ref # 59011)                | 59011-1051    | 1        |
| STUD,10X27 (Ref # 92004)                     | 92004-1145    | 6        |
| NUT,16MM (Ref # 92015)                       | 92015-055     | 1        |
| NUT,10MM (Ref # 92015A)                      | 92015-1502    | 6        |
| WASHER,17.3X32X3.2 (Ref # 92022)             | 42046-009     | 1        |
| COLLAR,REAR AXLE,LH,L=23.5 (Ref # 92027)     | 92027-1368    | 1        |
| COLLAR,REAR AXLE,RH,L=18.5 (Ref # 92027A)    | 92027-1484    | 1        |
| COLLAR,17.2X25X101 (Ref # 92027B)            | 92027-1863    | 1        |
| RING-SNAP,47MM (Ref # 92033)                 | 92033-1042    | 1        |
| SEAL-OIL,TWC35527 (Ref # 92049)              | 92052-006     | 1        |
| DAMPER,SHOCK,RR HUB (Ref # 92075)            | 92075-1687    | 1        |
| SPRING,BRAKE SHOE (Ref # 92081)              | 41049-007     | 2        |
| SPRING,BRAKE CAM LEVER RETURN (Ref # 92081A) | 92081-1814    | 1        |
| SEAL,BRAKE CAM (Ref # 92093)                 | 41051-003     | 1        |
| BOLT-SMALL,8X28 (Ref # 114)                  | 114G0828      | 1        |
| PIN-COTTER,4.0X35 (Ref # 550)                | 550D4035      | 1        |
| BEARING-BALL,#6205G (Ref # 601)              | 601B6205G     | 1        |
| BEARING-BALL,#6303ZZC3 (Ref # 601A)          | 601B6303ZZ    | 2        |