

1989 454 LTD PARTS DIAGRAM

Front Fork

F2340

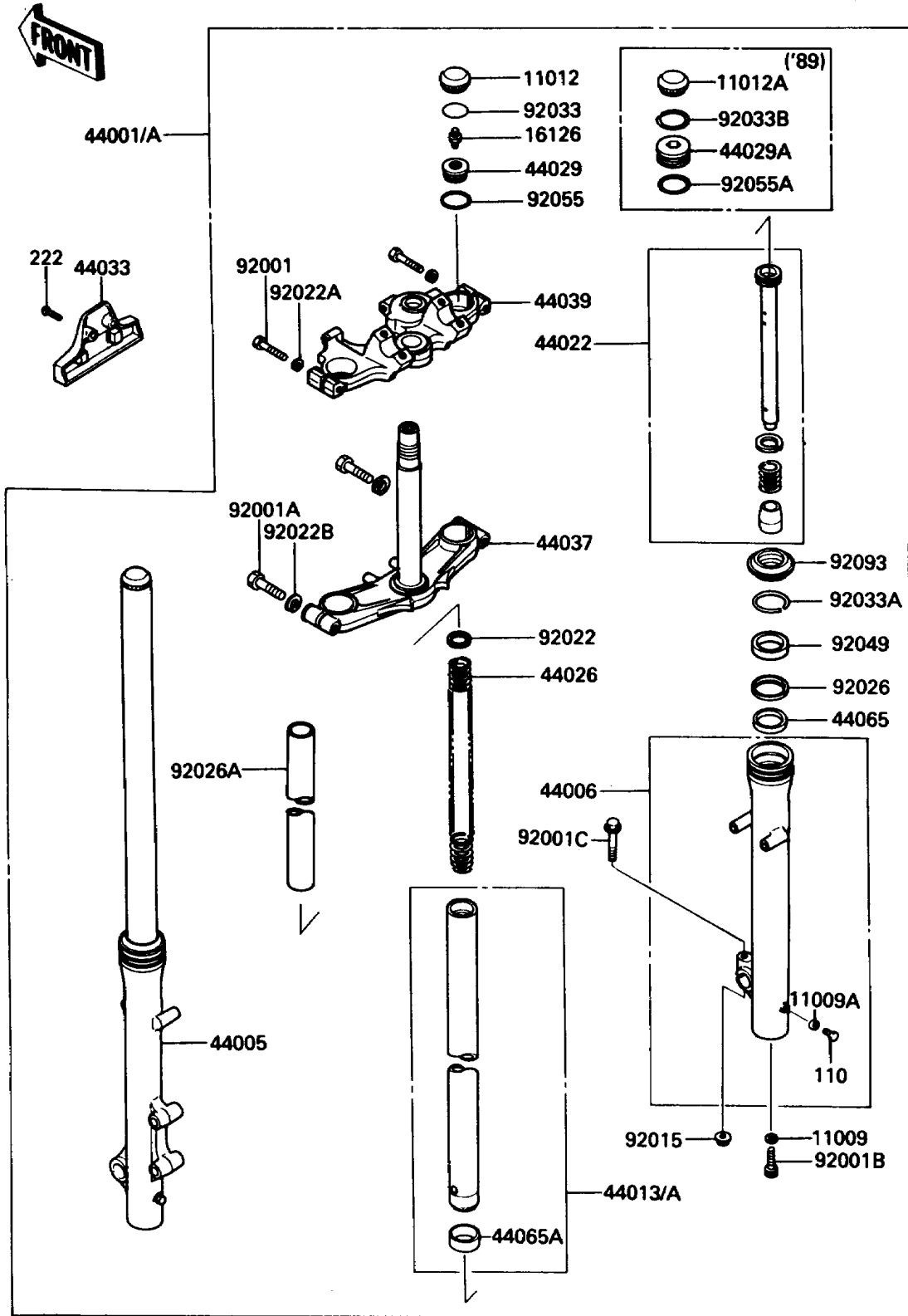

1989 454 LTD PARTS LIST

Front Fork

ITEM NAME	PART NUMBER	QUANTITY
GASKET,FORK CYLINDER BOLT (Ref # 11009)	44045-051	2
GASKET,DRAIN PLUG (Ref # 11009A)	44045-052	2
CAP,FORK TOP (Ref # 11012A)	11012-1689	2
FORK-FRONT (Ref # 44001A)	44001-1719	1
PIPE-LEFT FORK OUTER (Ref # 44005)	44005-1230	1
PIPE-RIGHT FORK OUTER (Ref # 44006)	44006-1230	1
PIPE-FORK INNER (Ref # 44013A)	44013-1286	2
CYLINDER-FORK (Ref # 44022)	44022-1178	2
SPRING-FRONT FORK,K=0.29 (Ref # 44026)	44026-1297	2
SEAT-FORK SPRING (Ref # 44029A)	44029-1124	2
COVER-FORK (Ref # 44033)	44033-1166	1
HOLDER-FORK UNDER (Ref # 44037)	44037-1176	1
HOLDER-FORK UPPER (Ref # 44039)	44039-1118	1
BUSHING-FRONT FORK (Ref # 44065)	44065-1068	2
BUSHING-FRONT FORK,INNER PIPE (Ref # 44065A)	44065-1069	2
BOLT,8X40 (Ref # 92001)	92001-1063	2
BOLT,10X40 (Ref # 92001A)	92001-1454	2
BOLT,FORK CYLINDER (Ref # 92001B)	92001-1464	2
BOLT,FLANGED,8X50 (Ref # 92001C)	92001-1486	1
NUT,FLANGED,8MM (Ref # 92015)	92015-1055	1
WASHER (Ref # 92022)	92022-1702	2
WASHER,SPRING,8MM (Ref # 92022A)	92022-1703	2
WASHER,SPRING,10MM (Ref # 92022B)	92022-1704	2
SPACER,FORK (Ref # 92026)	92026-1038	2
SPACER,FORK SPRING (Ref # 92026A)	92026-1252	2
RING-SNAP,FORK (Ref # 92033A)	92033-1193	2
RING-SNAP,FORK TOP (Ref # 92033B)	92033-1220	2
SEAL-OIL,FORK (Ref # 92049)	92049-1226	2
RING-O,FORK SPRING SEAT (Ref # 92055A)	92055-1359	2

1989 454 LTD PARTS LIST

Front Fork

ITEM NAME	PART NUMBER	QUANTITY
SEAL,FORK (Ref # 92093)	92093-1196	2
BOLT,6X8 (Ref # 110)	110B0608	2
SCREW-CSK-RD-CROS (Ref # 222)	222C0520	2