

1985 454 LTD PARTS DIAGRAM

Chassis Electrical Equipment

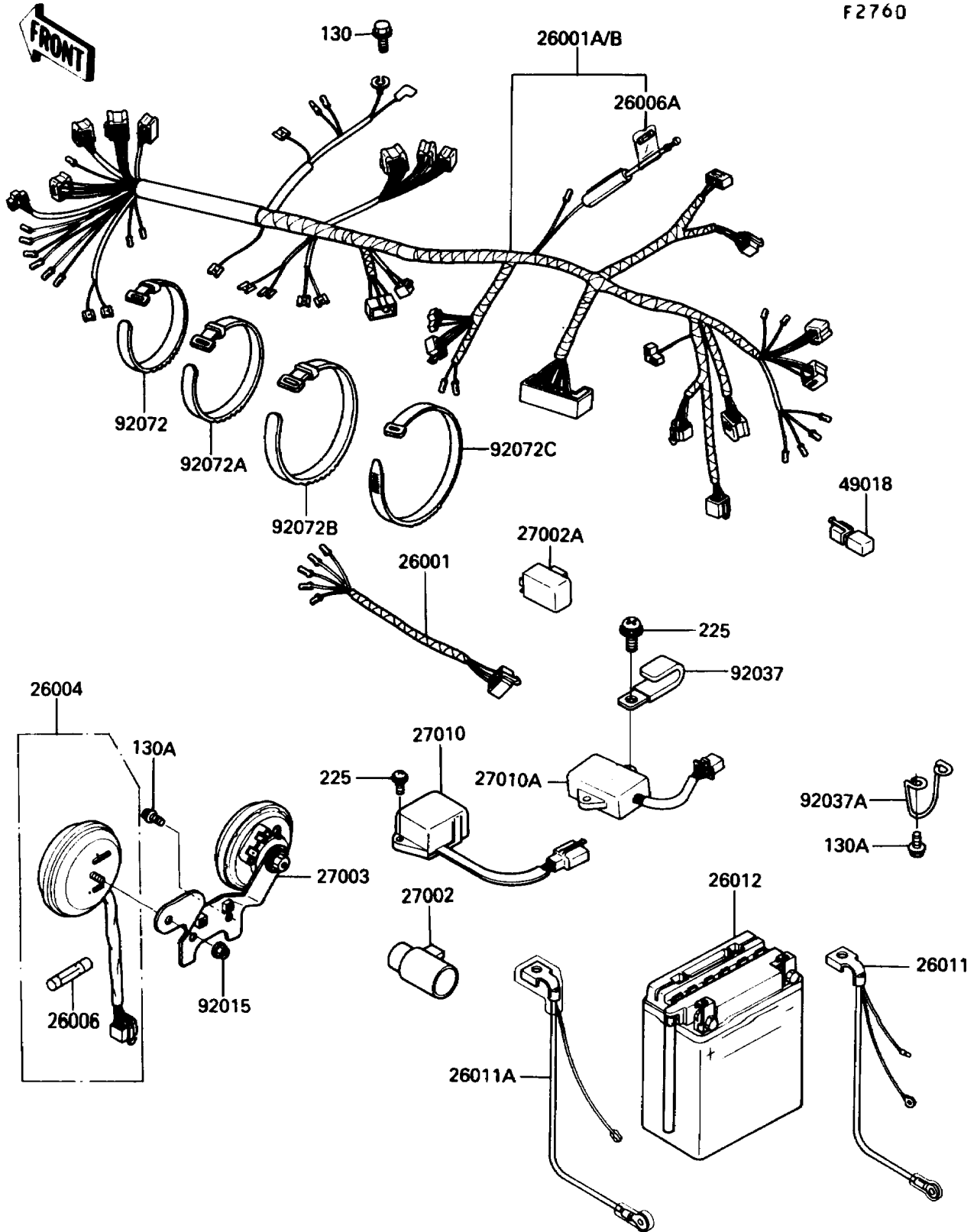

1985 454 LTD PARTS LIST

Chassis Electrical Equipment

| ITEM NAME | PART NUMBER | QUANTITY |
|---|-------------|----------|
| HARNESS,RR (Ref # 26001) | 26001-1689 | 1 |
| HARNESS,MAIN (Ref # 26001A) | 26001-1722 | 1 |
| FUSE-ASSY (Ref # 26004) | 26004-1059 | 1 |
| FUSE,10A,L=25 (Ref # 26006) | 26006-003 | 4 |
| FUSE,30A,L=30 (Ref # 26006A) | 26006-1059 | 1 |
| WIRE-LEAD,BATTERY(-) (Ref # 26011) | 26011-1291 | 1 |
| WIRE-LEAD,BATTERY(+) (Ref # 26011A) | 26011-1296 | 1 |
| BATTERY,12V 12AH,FB12A-A (Ref # 26012) | 26012-1213 | 1 |
| RELAY-ASSY (Ref # 27002) | 27002-1051 | 1 |
| RELAY-ASSY,TURN SIGNAL (Ref # 27002A) | 27002-1053 | 1 |
| HORN (Ref # 27003) | 27003-1217 | 1 |
| SWITCH,RESERVE LIGHTING (Ref # 27010) | 27010-1069 | 1 |
| SWITCH,TURN SIGNAL OPERATION (Ref # 27010A) | 27010-1166 | 1 |
| DIODE (Ref # 49018) | 49018-1053 | 1 |
| NUT,FLANGED,6MM (Ref # 92015) | 92015-1237 | 1 |
| CLAMP,WIRING HARNESS (Ref # 92037) | 92037-1069 | 3 |
| CLAMP,HARNESS (Ref # 92037A) | 92037-1663 | 1 |
| BAND,L=149 (Ref # 92072) | 92072-031 | 3 |
| BAND,L=186 (Ref # 92072A) | 92072-056 | 2 |
| BAND,L=278 (Ref # 92072B) | 92072-1087 | 1 |
| BAND,L=365 (Ref # 92072C) | 92072-1197 | 1 |
| BOLT-FLANGED,6X10 (Ref # 130) | 130B0610 | 1 |
| BOLT-FLANGED,6X14 (Ref # 130A) | 130C0614 | 4 |
| SCREW-PAN-WSP-CROS (Ref # 225) | 225B0620 | 4 |