

# 1986 454 LTD PARTS DIAGRAM

Chassis Electrical Equipment

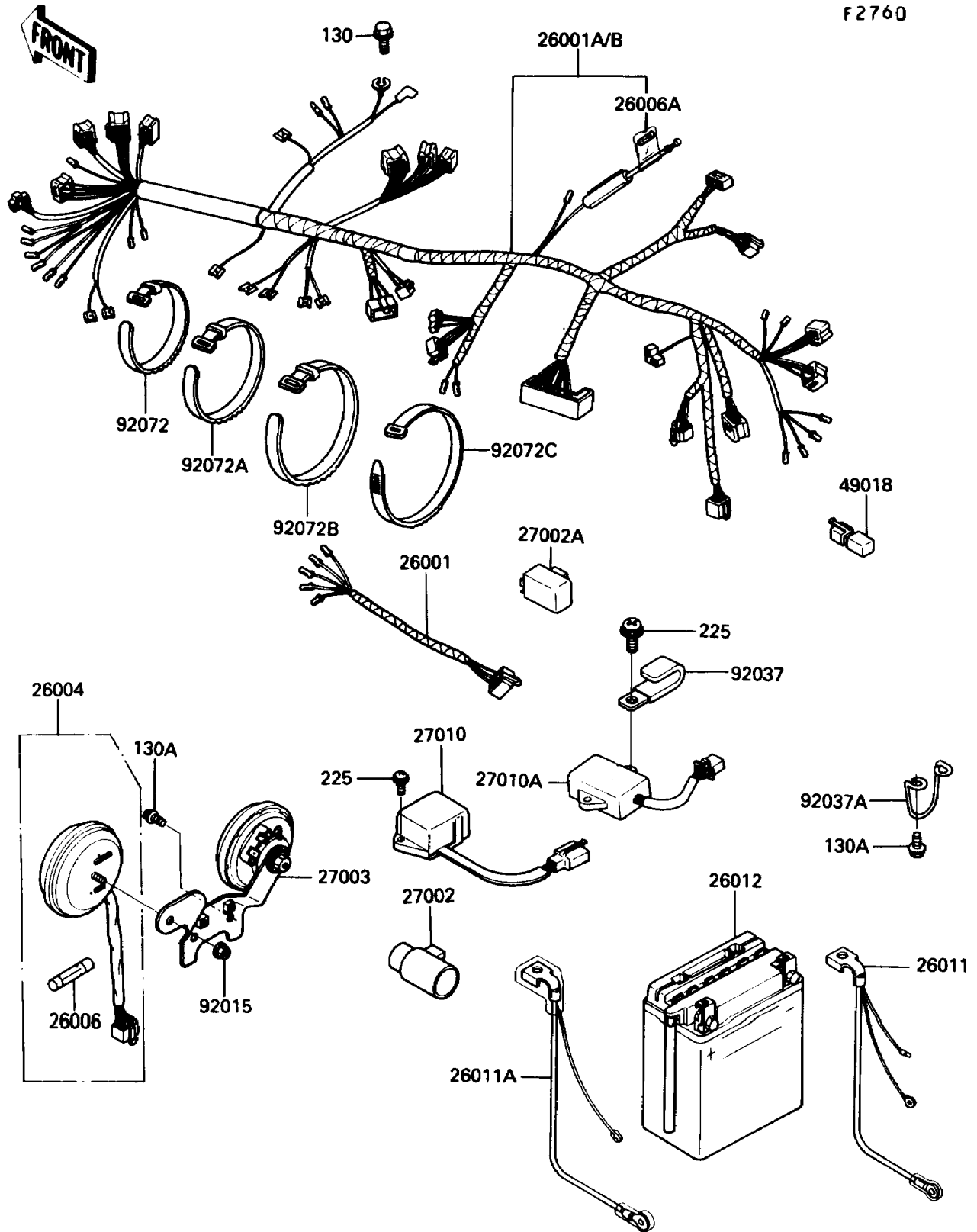

# 1986 454 LTD PARTS LIST

## Chassis Electrical Equipment

ITEM NAME	PART NUMBER	QUANTITY
HARNESS,RR (Ref # 26001)	26001-1689	1
HARNESS,MAIN (Ref # 26001A)	26001-1722	1
FUSE-ASSY (Ref # 26004)	26004-1059	1
FUSE,10A,L=25 (Ref # 26006)	26006-003	4
FUSE,30A,L=30 (Ref # 26006A)	26006-1059	1
WIRE-LEAD,BATTERY(-) (Ref # 26011)	26011-1291	1
WIRE-LEAD,BATTERY(+) (Ref # 26011A)	26011-1296	1
BATTERY,12V 12AH,FB12A-A (Ref # 26012)	26012-1213	1
RELAY-ASSY (Ref # 27002)	27002-1051	1
RELAY-ASSY,TURN SIGNAL (Ref # 27002A)	27002-1053	1
HORN (Ref # 27003)	27003-1217	1
SWITCH,RESERVE LIGHTING (Ref # 27010)	27010-1069	1
SWITCH,TURN SIGNAL OPERATION (Ref # 27010A)	27010-1166	1
DIODE (Ref # 49018)	49018-1053	1
NUT,FLANGED,6MM (Ref # 92015)	92015-1237	1
CLAMP,WIRING HARNESS (Ref # 92037)	92037-1069	3
CLAMP,HARNESS (Ref # 92037A)	92037-1663	1
BAND,L=149 (Ref # 92072)	92072-031	3
BAND,L=186 (Ref # 92072A)	92072-056	2
BAND,L=278 (Ref # 92072B)	92072-1087	1
BAND,L=365 (Ref # 92072C)	92072-1197	1
BOLT-FLANGED,6X10 (Ref # 130)	130B0610	1
BOLT-FLANGED,6X14 (Ref # 130A)	130C0614	4
SCREW-PAN-WSP-CROS (Ref # 225)	225B0620	4