

1993 Vulcan 500 PARTS DIAGRAM

Crankcase

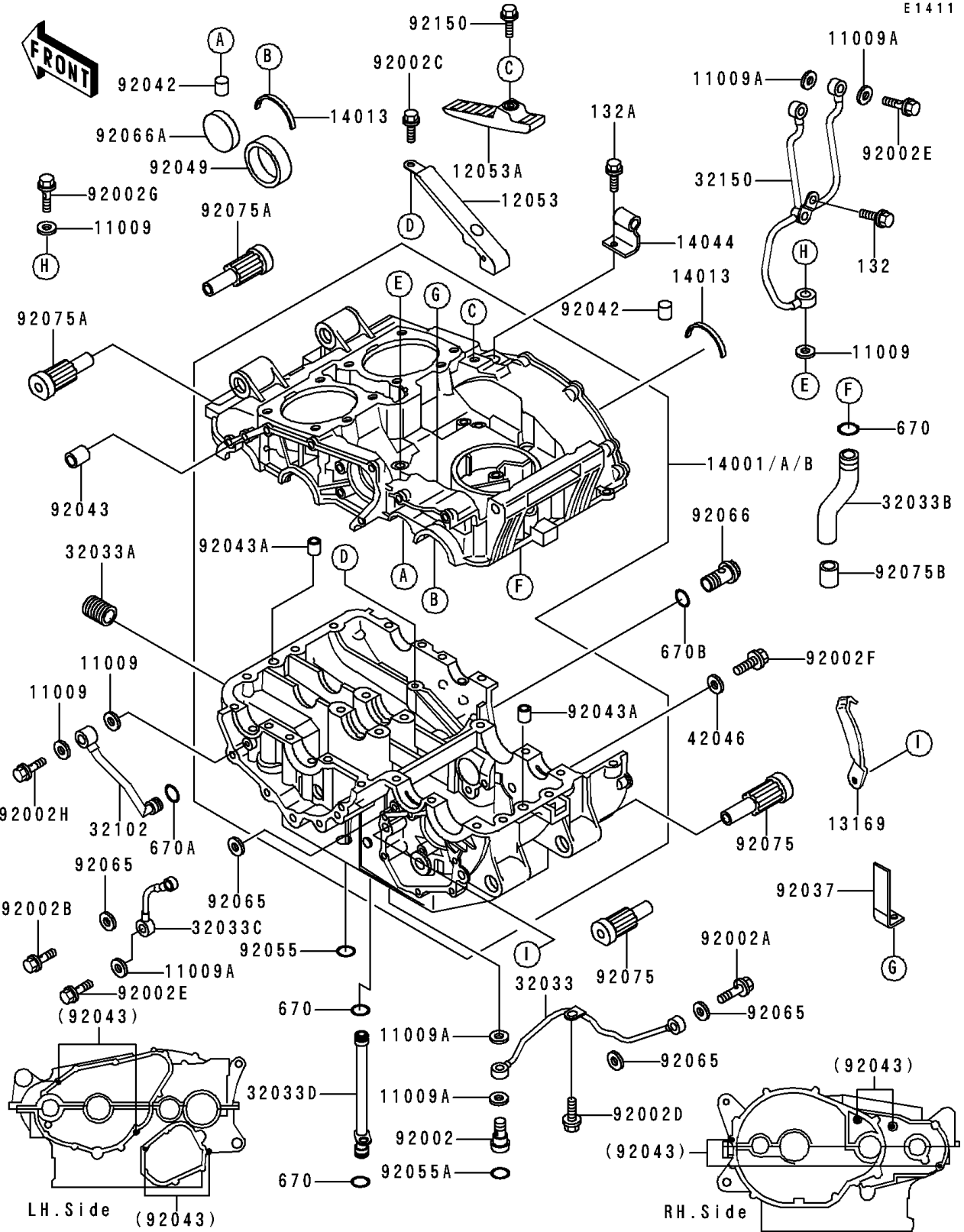

1993 Vulcan 500 PARTS LIST

Crankcase

| ITEM NAME | PART NUMBER | QUANTITY |
|---|-------------|----------|
| GASKET,10X14.5X1.5 (Ref # 11009) | 11009-1105 | 4 |
| GASKET,OIL PIPE,8.2X14X1.0 (Ref # 11009A) | 11009-1344 | 8 |
| GUIDE-CHAIN,LWR (Ref # 12053) | 12053-1216 | 1 |
| GUIDE-CHAIN,UPP (Ref # 12053A) | 12053-1217 | 1 |
| PLATE (Ref # 13169) | 13169-1896 | 1 |
| SET-CRANKCASE (Ref # 14001) | 14001-1072 | 1 |
| SET-CRANKCASE (Ref # 14001B) | 14001-1092 | 1 |
| RING-POSITION (Ref # 14013) | 14013-004 | 2 |
| HOLDER-CABLE (Ref # 14044) | 14044-1070 | 1 |
| PIPE (Ref # 32033) | 32033-1530 | 1 |
| PIPE (Ref # 32033A) | 32033-1535 | 1 |
| PIPE (Ref # 32033B) | 32033-1538 | 1 |
| PIPE (Ref # 32033C) | 32033-1539 | 1 |
| PIPE (Ref # 32033D) | 32033-1574 | 1 |
| PIPE (Ref # 32102) | 32102-1541 | 1 |
| PIPE (Ref # 32150) | 32150-1478 | 1 |
| WASHER,6.5X24X1.2 (Ref # 42046) | 42046-008 | 1 |
| BOLT (Ref # 92002) | 92002-1467 | 1 |
| BOLT,BANJO,6X28 (Ref # 92002A) | 92002-1471 | 1 |
| BOLT,BANJO,6X19 (Ref # 92002B) | 92002-1473 | 1 |
| BOLT,6X12 (Ref # 92002C) | 92002-1563 | 2 |
| BOLT,6X12 (Ref # 92002D) | 92002-1572 | 1 |
| BOLT,BANJO,8X20 (Ref # 92002E) | 92002-1618 | 3 |
| BOLT,6X14 (Ref # 92002F) | 92002-1656 | 1 |
| BOLT,OIL,L=23 (Ref # 92002G) | 92002-1809 | 1 |
| BOLT,BANJO,10X30 (Ref # 92002H) | 92002-1941 | 1 |
| CLAMP (Ref # 92037) | 92037-1679 | 1 |
| PIN,DOWEL,6X16 (Ref # 92042) | 92042-016 | 2 |
| PIN,6.2X8X14 (Ref # 92043) | 92043-1263 | 8 |

1993 Vulcan 500 PARTS LIST

Crankcase

| ITEM NAME | PART NUMBER | QUANTITY |
|---------------------------------|-------------|----------|
| PIN,8.2X10X14 (Ref # 92043A) | 92043-1264 | 4 |
| SEAL-OIL,AE2343F0 (Ref # 92049) | 92049-1070 | 1 |
| RING-O,OD=18 (Ref # 92055) | 92055-048 | 2 |
| RING-O,OD=13 (Ref # 92055A) | 92055-074 | 1 |
| GASKET (Ref # 92065) | 92065-096 | 4 |
| PLUG,MAIN GALLERY (Ref # 92066) | 92066-1205 | 1 |
| PLUG,RCA 345.5 (Ref # 92066A) | 92066-1208 | 1 |
| DAMPER,L=79.5 (Ref # 92075) | 92075-1678 | 2 |
| BOLT-FLANGED-SMALL (Ref # 132) | 132Y0612 | 1 |
| BOLT-FLANGED-SMALL (Ref # 132A) | 132Y0616 | 1 |
| O RING,10MM (Ref # 670) | 670B1510 | 3 |
| O RING,10MM (Ref # 670A) | 670B2010 | 1 |
| O RING,21MM (Ref # 670B) | 670B2021 | 1 |
| DAMPER,L=93 (Ref # 92075A) | 92075-1679 | 2 |
| DAMPER (Ref # 92075B) | 92075-1742 | 1 |
| BOLT,6X16 (Ref # 92150) | 92150-1394 | 1 |