

1989 Ninja® 250R PARTS DIAGRAM

Fuel Tank

F2410

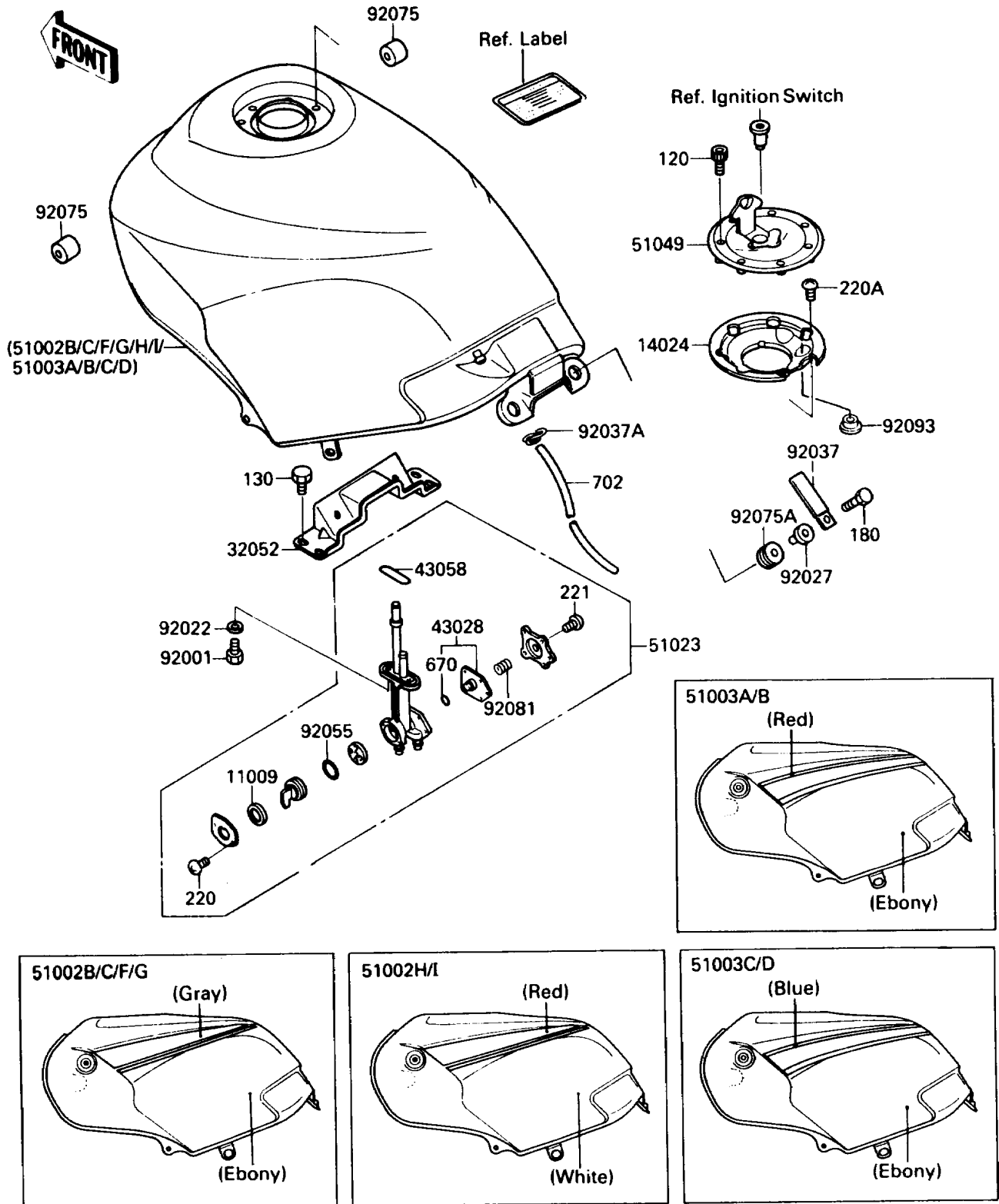

1989 Ninja® 250R PARTS LIST

Fuel Tank

| ITEM NAME | PART NUMBER | QUANTITY |
|---|---------------|----------|
| GASKET,TAP VALVE (Ref # 11009) | 11009-1188 | 1 |
| COVER,TANK CAP (Ref # 14024) | 14025-1913 | 1 |
| BRACKET-TANK,RR (Ref # 32052) | 32052-1254 | 1 |
| DIAPHRAGM,TAP (Ref # 43028) | 43028-1068 | 1 |
| RING,TAP FLANGED (Ref # 43058) | 51039-003 | 1 |
| TANK-COMP-FUEL,EBONY (Ref # 51002F) | 51002-5468-H8 | 1 |
| TANK-COMP-FUEL,EBONY (Ref # 51002G) | 51002-5469-H8 | 1 |
| TANK-COMP-FUEL,P.A.WHITE (Ref # 51002H) | 51002-5470-R1 | 1 |
| TANK-COMP-FUEL,P.A.WHITE (Ref # 51002I) | 51002-5471-R1 | 1 |
| TAP-ASSY,FUEL (Ref # 51023) | 51023-1139 | 1 |
| CAP-TANK,FUEL (Ref # 51049) | 51049-1079 | 1 |
| BOLT,6X20 (Ref # 92001) | 92001-1091 | 2 |
| WASHER,6.2X11X1.5 (Ref # 92022) | 92022-183 | 2 |
| COLLAR,L=13.1 (Ref # 92027) | 92027-251 | 2 |
| CLAMP,WIRING HARNESS (Ref # 92037) | 92037-1069 | 1 |
| CLAMP (Ref # 92037A) | 92037-1712 | 1 |
| RING-O,TAP LEVER (Ref # 92055) | 92055-1085 | 1 |
| DAMPER,FUEL TANK,FR (Ref # 92075) | 92075-1115 | 2 |
| DAMPER (Ref # 92075A) | 92075-1690 | 2 |
| SPRING,TAP DIAPHRAGM (Ref # 92081) | 92081-1240 | 1 |
| SEAL,FUEL TANK CAP (Ref # 92093) | 92093-1030 | 1 |
| BOLT-SOCKET (Ref # 120) | 120S0512 | 7 |
| BOLT-FLANGED,6X10 (Ref # 130) | 130B0610 | 4 |
| BOLT-UPSET-WS,6X25 (Ref # 180) | 180D0625 | 2 |
| SCREW-PAN-CROS (Ref # 220) | 220C0308 | 2 |
| SCREW-PAN-CROS (Ref # 220A) | 220C0508 | 1 |
| SCREW-CSK-CROS,4X14 (Ref # 221) | 221B0414 | 5 |
| O RING,4MM (Ref # 670) | 670B1504 | 1 |
| TUBE-RUBBER,7X10X1000 (Ref # 702) | 702A071000 | 1 |