

1992 EX500 PARTS DIAGRAM

Transmission

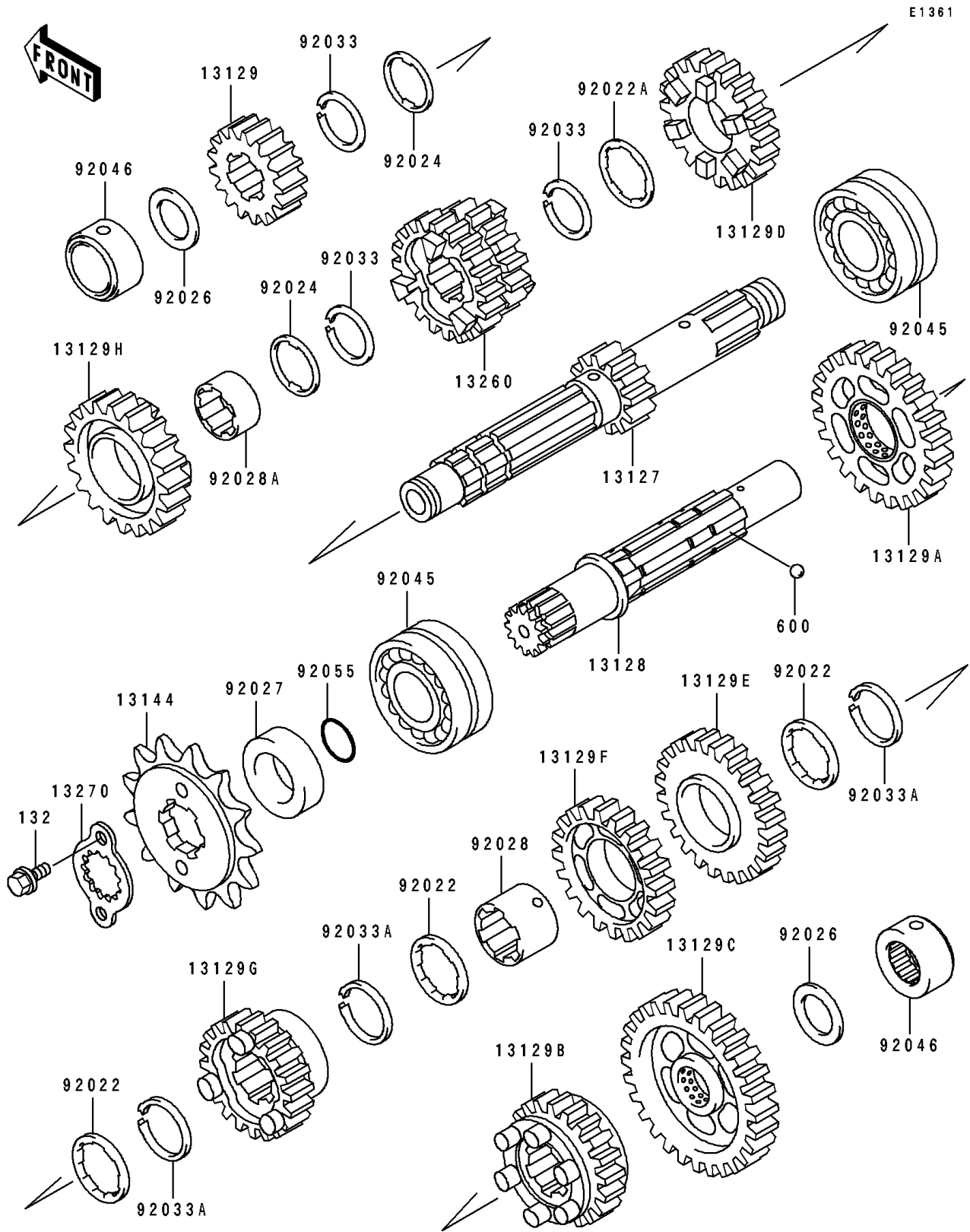

1992 EX500 PARTS LIST

Transmission

| ITEM NAME | PART NUMBER | QUANTITY |
|---|-------------|----------|
| SHAFT-TRANSMISSION INPUT,14T (Ref # 13127) | 13127-1148 | 1 |
| SHAFT-TRANSMISSION OUTPUT (Ref # 13128) | 13128-1143 | 1 |
| GEAR,INPUT 2ND,18T (Ref # 13129) | 13129-1077 | 1 |
| GEAR,OUTPUT 2ND,32T (Ref # 13129A) | 13129-1078 | 1 |
| GEAR,OUTPUT 5TH,25T (Ref # 13129B) | 13129-1083 | 1 |
| GEAR,OUTPUT LOW,36T (Ref # 13129C) | 13129-1564 | 1 |
| GEAR,INPUT 5TH,26T (Ref # 13129D) | 13129-1657 | 1 |
| GEAR,OUTPUT 3RD,29T (Ref # 13129E) | 13129-1659 | 1 |
| GEAR,OUTPUT 4TH,27T (Ref # 13129F) | 13129-1660 | 1 |
| GEAR,OUTPUT TOP,23T (Ref # 13129G) | 13129-1858 | 1 |
| GEAR,INPUT TOP,27T (Ref # 13129H) | 13129-1859 | 1 |
| SPROCKET-OUTPUT,16T (Ref # 13144) | 13144-1085 | 1 |
| GEAR,INPUT 3RD&4TH,21T&24T (Ref # 13260) | 13260-1195 | 1 |
| PLATE,SPROCKET (Ref # 13270) | 13270-1060 | 1 |
| WASHER,TOOTHED,28.3X33.5X1 (Ref # 92022) | 92022-1139 | 3 |
| WASHER,TOOTHED,25.3X31.8X1.6 (Ref # 92022A) | 92022-1861 | 1 |
| WASHER,TOOTHED,25.5X32X1 (Ref # 92024) | 92024-033 | 2 |
| SPACER,20.3X30X2.0 (Ref # 92026) | 92026-1022 | 2 |
| COLLAR,25X40X12 (Ref # 92027) | 92027-1857 | 1 |
| BUSHING,OUTPUT 3RD&4TH GEAR (Ref # 92028) | 92028-1364 | 1 |
| BUSHING,INPUT TOP GEAR (Ref # 92028A) | 92028-1552 | 1 |
| RING-SNAP,24MM (Ref # 92033) | 92033-026 | 3 |
| RING-SNAP,25.9MM (Ref # 92033A) | 92033-1037 | 3 |
| BEARING-BALL,83993SH2-CS (Ref # 92045) | 92045-035 | 2 |
| BEARING-NEEDLE,NKZ20X34X17 (Ref # 92046) | 92046-1161 | 2 |
| RING-O (Ref # 92055) | 92055-035 | 1 |
| BOLT-FLANGED-SMALL (Ref # 132) | 132G0608 | 2 |
| BALL-STEEL,5/32" (Ref # 600) | 600A0500 | 3 |