

# 1989 X2 PARTS DIAGRAM

Engine Hood

F3142

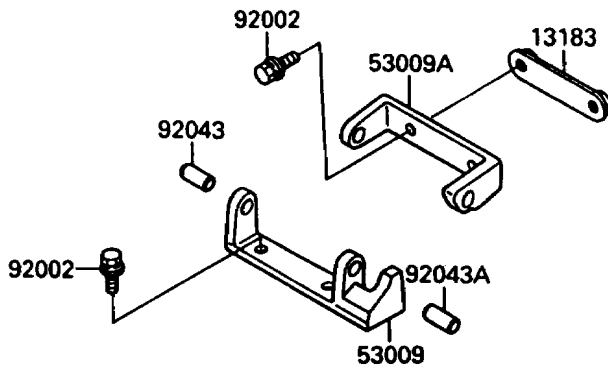
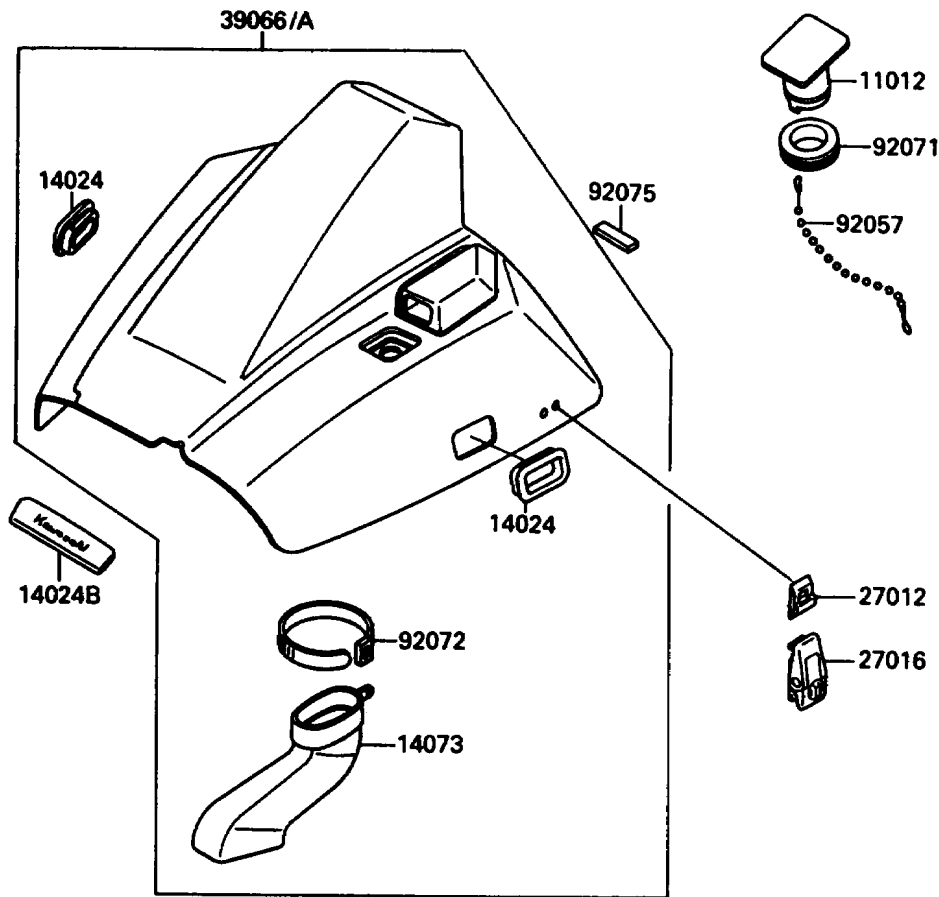

## 1989 X2 PARTS LIST

### Engine Hood

| ITEM NAME                                 | PART NUMBER   | QUANTITY |
|---|---------------|----------|
| CAP,ENGINE HOOD,JET WHITE (Ref # 11012)   | 11012-3711-8C | 2        |
| PLATE (Ref # 13183)                       | 13183-3706    | 1        |
| COVER,ENGINE HOOD,JET WHITE (Ref # 14024) | 14024-3714-8C | 2        |
| COVER,ENGINE HOOD,FR (Ref # 14024B)       | 14024-3740    | 1        |
| DUCT,ENGINE HOOD (Ref # 14073)            | 14073-3707    | 1        |
| HOOK,ENGINE HOOD LOCK (Ref # 27012)       | 27012-3719    | 2        |
| LOCK-ASSY,ENGINE HOOD (Ref # 27016)       | 27016-3706    | 2        |
| HOOD-ASSY-ENGINE,J.WHITE (Ref # 39066)    | 39066-3705-8C | 1        |
| HINGE,DECK (Ref # 53009)                  | 53009-3703    | 1        |
| HINGE,ENGINE HOOD (Ref # 53009A)          | 53009-3704    | 1        |
| BOLT,8X25 (Ref # 92002)                   | 92002-3774    | 4        |
| PIN,10X23 (Ref # 92043)                   | 92043-3710    | 1        |
| PIN,10X25 (Ref # 92043A)                  | 92043-3711    | 1        |
| CHAIN,COVER,L=250 (Ref # 92057)           | 92057-3701    | 2        |
| GROMMET,ENGINE HOOD (Ref # 92071)         | 92071-3731    | 2        |
| BAND,L=225 (Ref # 92072)                  | 92072-1174    | 1        |
| DAMPER (Ref # 92075)                      | 92075-3757    | 2        |