

# 1989 X2 PARTS DIAGRAM

## Hull Fittings

F 3143

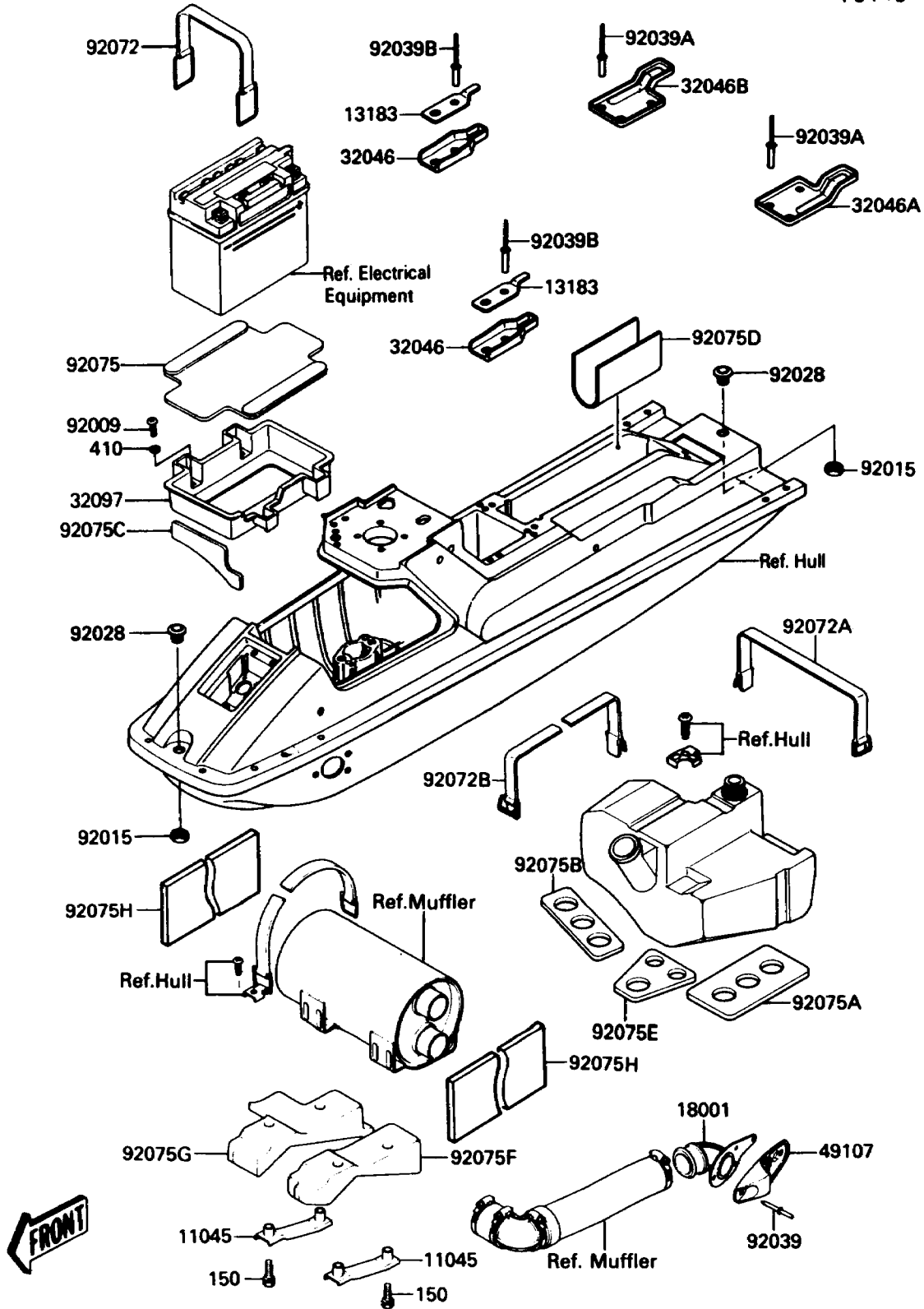

# 1989 X2 PARTS LIST

## Hull Fittings

| ITEM NAME                               | PART NUMBER | QUANTITY |
|---|-------------|----------|
| BOLT-WS,6X22 (Ref # 150)                | 150R0622    | 4        |
| WASHER-PLAIN-SMALL,6MM (Ref # 410)      | 410S0600    | 4        |
| BRACKET,WATER MUFFLER (Ref # 11045)     | 11045-3763  | 2        |
| PLATE,SEAT,FR (Ref # 13183)             | 13183-3721  | 2        |
| MUFFLER,TAIL (Ref # 18001)              | 18001-3719  | 1        |
| BRACKET-SEAT,FR (Ref # 32046)           | 32046-3704  | 2        |
| BRACKET-SEAT,CNT,LH (Ref # 32046A)      | 32046-3705  | 1        |
| BRACKET-SEAT,CNT,RH (Ref # 32046B)      | 32046-3706  | 1        |
| CASE-BATTERY (Ref # 32097)              | 32097-3702  | 1        |
| COVER-EXHAUST PIPE (Ref # 49107)        | 49107-3703  | 1        |
| SCREW,TAPPING (Ref # 92009)             | 92011-561   | 4        |
| NUT (Ref # 92015)                       | 92015-3779  | 2        |
| BUSHING (Ref # 92028)                   | 92028-3734  | 2        |
| RIVET (Ref # 92039)                     | 92039-3002  | 4        |
| RIVET (Ref # 92039A)                    | 92039-3714  | 6        |
| RIVET (Ref # 92039B)                    | 92039-3730  | 4        |
| BAND,BATTERY,L=366 (Ref # 92072)        | 92072-3706  | 2        |
| BAND,L=544 (Ref # 92072A)               | 92072-3709  | 1        |
| BAND,L=479 (Ref # 92072B)               | 92072-3712  | 1        |
| DAMPER,BATTERY (Ref # 92075)            | 92075-3714  | 1        |
| DAMPER,FUEL TANK,LH (Ref # 92075A)      | 92075-3727  | 1        |
| DAMPER,FUEL TANK,RH (Ref # 92075B)      | 92075-3729  | 1        |
| DAMPER,FUEL TANK (Ref # 92075C)         | 92075-3738  | 1        |
| DAMPER,FIRE EXTINGUISHER (Ref # 92075D) | 92075-3750  | 1        |
| DAMPER,FUEL TANK (Ref # 92075E)         | 92075-3751  | 1        |
| DAMPER,WATER MUFFLER,LH (Ref # 92075F)  | 92075-3761  | 1        |
| DAMPER,WATER MUFFLER,RH (Ref # 92075G)  | 92075-3762  | 1        |
| DAMPER,MUFFLER (Ref # 92075H)           | 92075-522   | 2        |