

# 1983 Spectre PARTS DIAGRAM

## FRAME FITTINGS

F2131-0107

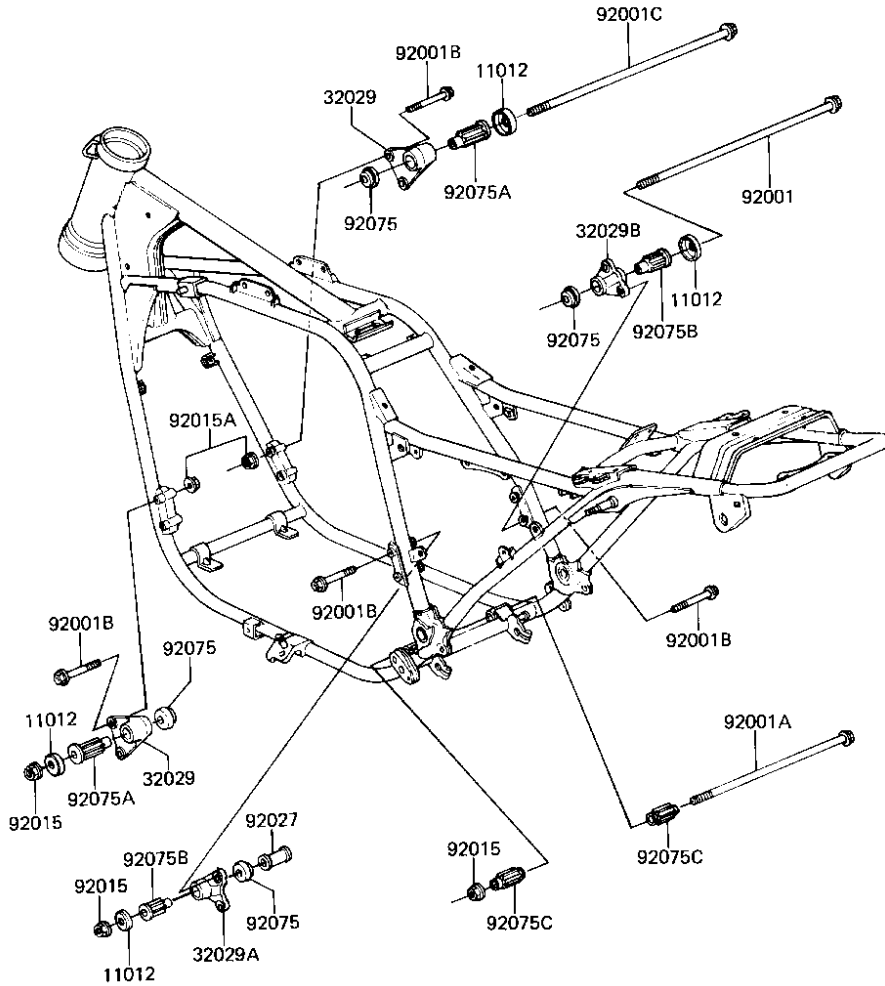

# 1983 Spectre PARTS LIST

## FRAME FITTINGS

ITEM NAME	PART NUMBER	QUANTITY
CAP,ENGINE BRACKET (Ref # 11012)	11012-1228	4
BRACKET-ENGINE-FR (Ref # 32029)	32029-1194	2
BRACKET-ENGINE,RR,LH (Ref # 32029A)	32029-1195	1
BRACKET-ENGINE,RR,RH (Ref # 32029B)	32029-1332	1
BOLT,FLANGED,10X323, (Ref # 92001)	92001-1565	1
BOLT,FLANGED,10X255, (Ref # 92001A)	92001-1566	1
BOLT,FLANGED,8X55,BL (Ref # 92001B)	92001-1641	8
BOLT,FLANGED,10X330, (Ref # 92001C)	92001-1664	1
NUT,FLANGED,10MM,BLA (Ref # 92015)	92015-1180	3
NUT,FLANGED,8MM (Ref # 92015A)	92015-1408	4
COLLAR,L=37M/M (Ref # 92027)	92027-1110	1
DAMPER (Ref # 92075)	92075-1274	4
DAMPER,ENGINE BRACKE (Ref # 92075A)	92075-1377	2
DAMPER,11X36X50X7 (Ref # 92075B)	92075-1378	2
DAMPER,11X29X42X7 (Ref # 92075C)	92075-1379	2