

# 1983 Spectre PARTS DIAGRAM

## FRONT MASTER CYLINDER

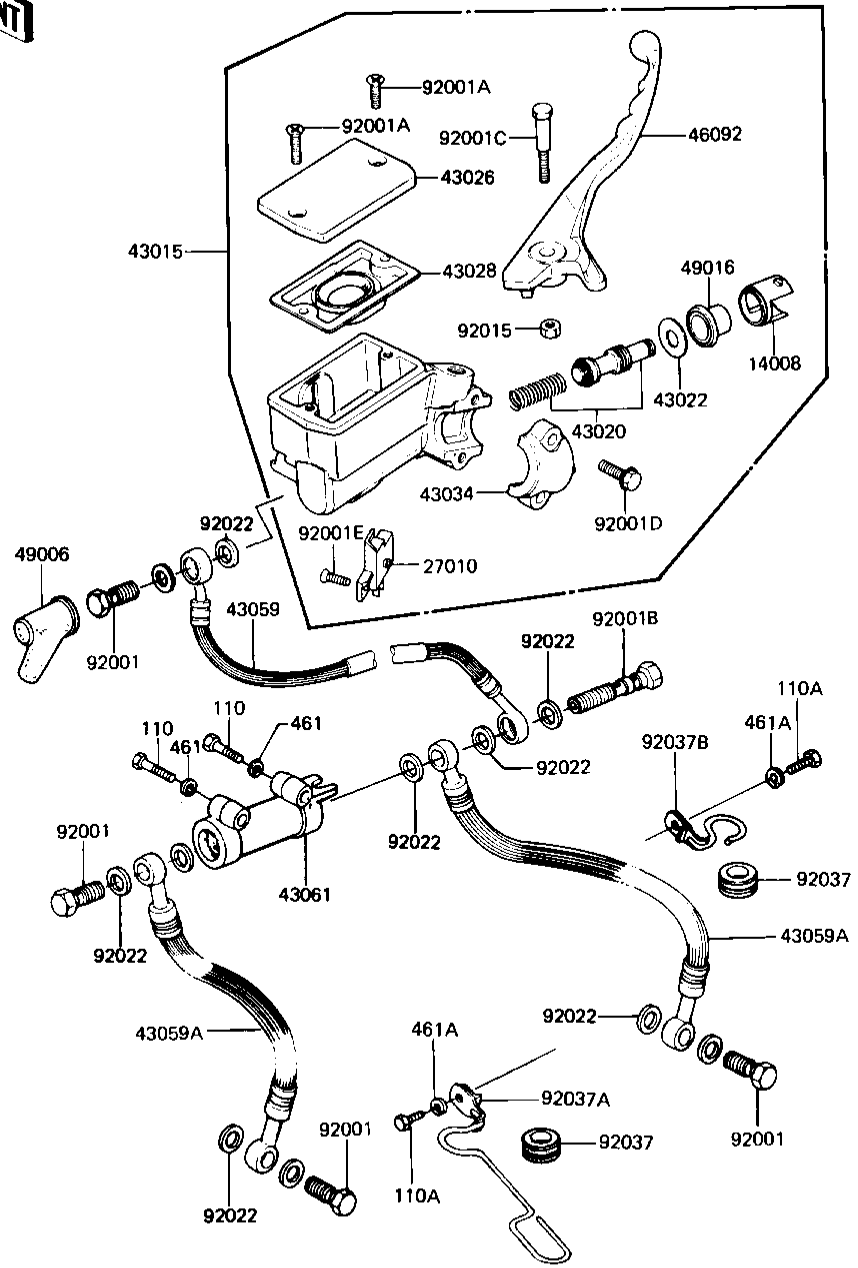

F2291-0069



# 1983 Spectre PARTS LIST

## FRONT MASTER CYLINDER

ITEM NAME	PART NUMBER	QUANTITY
LINER,PISTON (Ref # 14008)	14008-1035	1
SWITCH,BRAKE (Ref # 27010)	27010-1056	1
CYLINDER-ASSY-MASTER (Ref # 43015)	43015-1089	1
PISTON-COMP-BRAKE (Ref # 43020)	43020-1079	1
STOPPER-BRAKE,PISTON (Ref # 43022)	43022-1009	1
CAP-BRAKE,FRONT (Ref # 43026)	43026-1017	1
DIAPHRAGM,MASTER CYL (Ref # 43028)	43028-1029	1
HOLDER,MASTER CYLIND (Ref # 43034)	43034-1001	1
HOSE-BRAKE,L=500 (Ref # 43059)	43059-1185	1
HOSE-BRAKE,FR,L=600 (Ref # 43059A)	43059-1179	2
JOINT,FR BRAKE HOSE (Ref # 43061)	43061-1002	1
LEVER-GRIP,FRONT BRA (Ref # 46092)	46092-1027	1
BOOT,DUST (Ref # 49006)	49006-1067	1
COVER-SEAL,BRK PISTO (Ref # 49016)	49016-1041	1
BOLT,OIL,L=23 (Ref # 92001)	92002-1888	4
SCREW,COUNTERSUNK HE (Ref # 92001A)	92001-1055	2
BOLT (Ref # 92001B)	92002-1909	1
BOLT,6X37.3,BLACK (Ref # 92001C)	92001-1512	1
BOLT,W/WASHER,6X25,B (Ref # 92001D)	92001-1513	2
SCREW-COUNTERSUNK (Ref # 92001E)	92001-1532	1
NUT,LOCK,6MM,BLACK (Ref # 92015)	92015-1191	1
WASHER-OIL BOLT (Ref # 92022)	43067-001	11
DAMPER RUBBER,CYL HS (Ref # 92037)	43064-006	2
CLAMP,CABLE,BLACK (Ref # 92037A)	92037-1335	1
CLAMP,BRAKE HOSE,FR, (Ref # 92037B)	92037-1336	1
BOLT-UPSET,6X40 (Ref # 110)	112G0640	2
BOLT, 6X12, BLACK (Ref # 110A)	112C0612	2
WASHER SPRING 6MM (Ref # 461)	461F0600	2
WASHER-SPRING,6MM,BL (Ref # 461A)	461K0600	2