

1974 F9-B PARTS DIAGRAM

CARBURETOR ('72-'73 F9/F9-A 350)

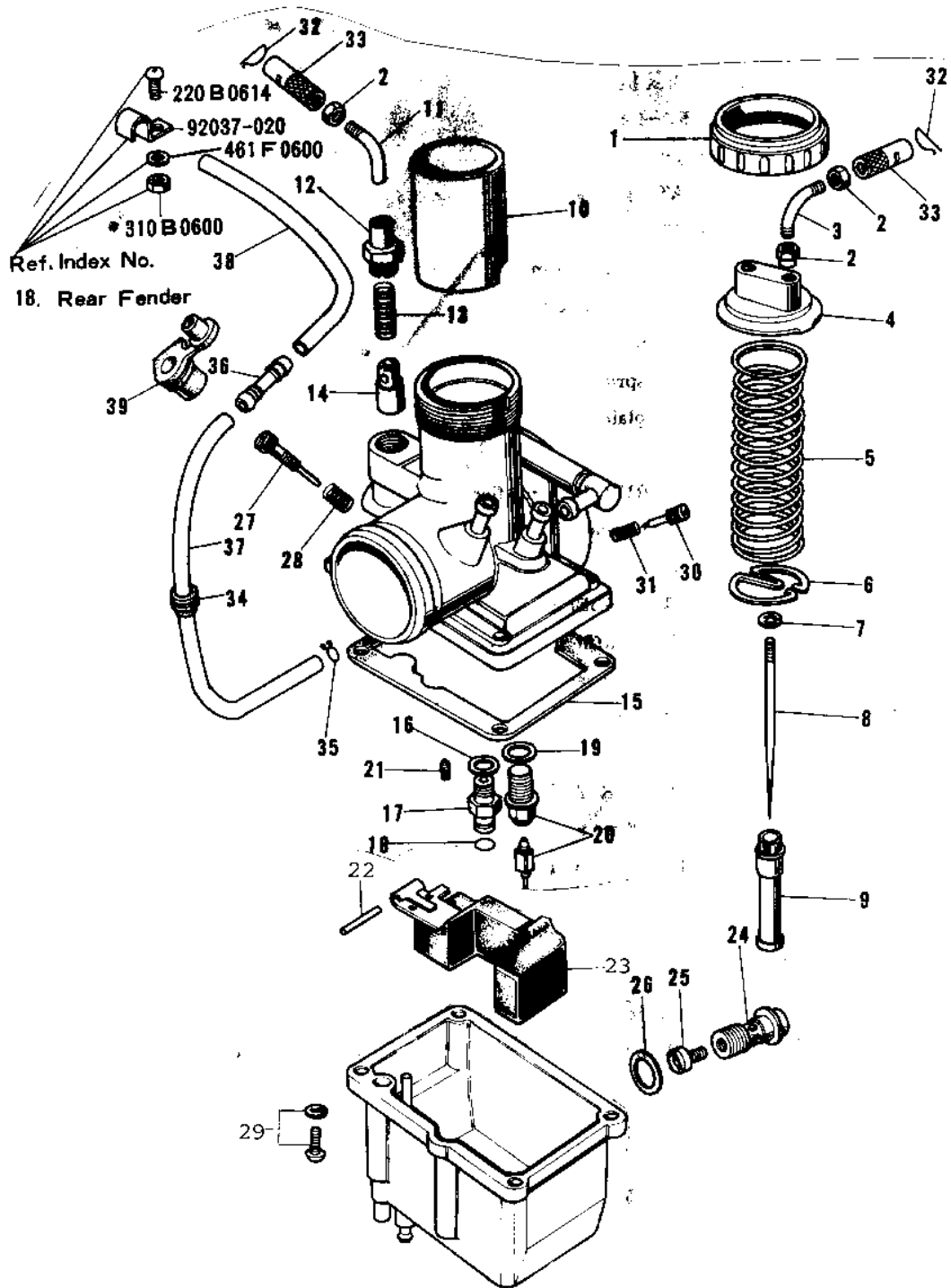

1974 F9-B PARTS LIST

CARBURETOR ('72-'73 F9/F9-A 350)

| ITEM NAME | PART NUMBER | QUANTITY |
|---------------------------------|-------------|----------|
| CARBURETOR ASSY (Ref # 1~31) | 16001-140 | |
| CARBURETOR ASSY (Ref # 1~31) | 16001-161 | |
| CAP MIXING CHAMBER (Ref # 1) | 16004-006 | |
| NUT CABLE ADJUST LOC (Ref # 2) | 16003-004 | |
| CABLE GUIDE (Ref # 3) | 16077-001 | |
| TOP MIXING CHAMBER (Ref # 4) | 16005-016 | |
| SPRING THROTTLE VALV (Ref # 5) | 16006-007 | |
| SPRING SEAT THRTL VL (Ref # 6) | 16007-007 | |
| CIRCLIP (Ref # 7) | 16008-010 | |
| JET NEEDLE,5EJ13 (Ref # 8) | 16009-048 | |
| NEEDLE JET,O-G (Ref # 9) | 16017-057 | |
| VALVE-THROTTLE,CA1.5 (Ref # 10) | 16025-045 | |
| VALVE,THROTTLE CA2.0 (Ref # 11) | 16025-052 | |
| CAP-STARTER PLUNGER (Ref # 12) | 16012-013 | |
| SPRING-PLUNGER (Ref # 13) | 16013-003 | |
| PLUNGER-ENRICHNER (Ref # 14) | 16016-002 | |
| GASKET-FLOAT CHAMBER (Ref # 15) | 16019-017 | |
| WASHER MAIN JET (Ref # 16) | 16034-001 | |
| HOLDER-NEEDLE JET (Ref # 17) | 16065-008 | |
| "O" RING (Ref # 18) | 92055-044 | |
| WASHER FLOAT VLV SEA (Ref # 19) | 16029-004 | |
| FLOAT VALVE ASSY (Ref # 20) | 16030-005 | |
| PILOT JET,#10 (Ref # 21) | 92064-034 | |
| PILOT JET,#17.5 (Ref # 21) | 92064-046 | |
| FLOAT PIN (Ref # 22) | 16032-006 | |
| FLOAT (Ref # 23) | 16031-022 | |
| BOLT-BANJO (Ref # 24) | 92001-097 | |
| MAIN JET NO 120R (Ref # 25) | 92063-078 | |
| JET-MAIN NO 115R (Ref # 25) | 92063-076 | |

1974 F9-B PARTS LIST

CARBURETOR ('72-'73 F9/F9-A 350)

| ITEM NAME | PART NUMBER | QUANTITY |
|---------------------------------|-------------|----------|
| JET-MAIN NO 117.5R (Ref # 25) | 92063-077 | |
| JET-MAIN,#A122.5 (Ref # 25) | 92063-1101 | |
| MAIN JET NO 125R (Ref # 25) | 92063-055 | |
| GASKET-BANJO BOLT (Ref # 26) | 16034-005 | |
| SCREW-THROTTLE STOP (Ref # 27) | 16021-014 | |
| SPRING THR STOP SCRE (Ref # 28) | 16022-005 | |
| SCREW-PAN-WS-CROS (Ref # 29) | 223B0414 | |
| SCREW-PILOT AIR ADJS (Ref # 30) | 16014-011 | |
| SPRING-THR STOP SCRE (Ref # 31) | 16022-007 | |
| CIRCLIP (Ref # 32) | 92036-018 | |
| CABLE ADJUSTER (Ref # 33) | 16002-007 | |
| GROMMET PIPE (Ref # 34) | 92071-038 | |
| CLAMP FUEL PIPE (Ref # 35) | 92037-010 | |
| NIPPLE (Ref # 36) | 92005-003 | |
| PIPE (Ref # 37) | 92059-065 | |
| PIPE OIL TANK (Ref # 38) | 92059-002 | |
| GROMMET,ACCESS (Ref # 39) | 92071-057 | |