

1972 F9 PARTS DIAGRAM

FENDERS (F9-A)

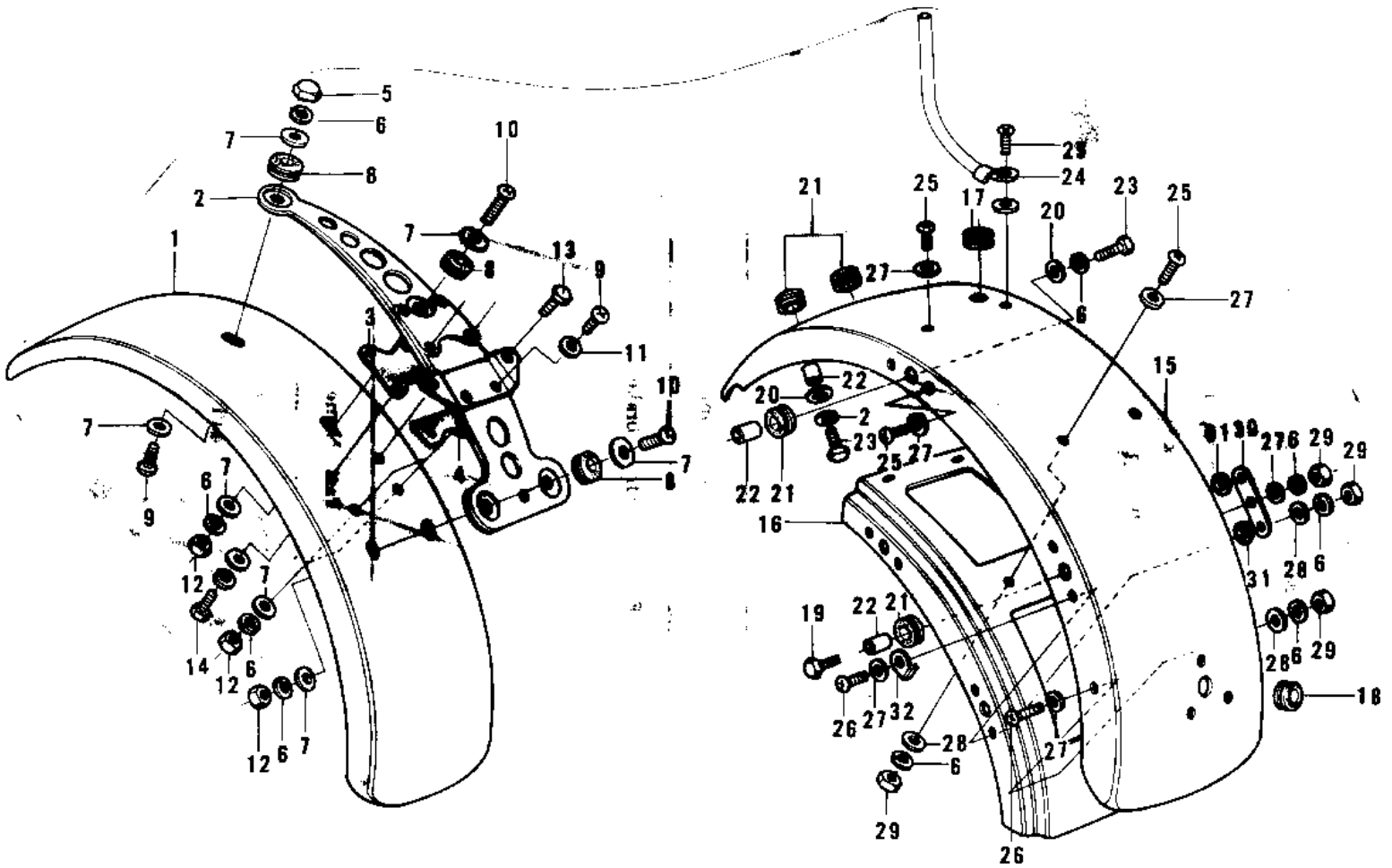

1972 F9 PARTS LIST

FENDERS (F9-A)

ITEM NAME	PART NUMBER	QUANTITY
FENDER-FR,L.GREEN (Ref # 1)	35004-071-90	1
BRACKET,FRONT FENDER (Ref # 2)	35012-019	1
DAMPER RUBBER-F.FEND (Ref # 3)	35007-002	1
DAMPER RUBBER-FR FND (Ref # 4)	35007-003	1
NUT,6MM (Ref # 5)	92015-009	1
WASHER SPRING 6MM (Ref # 6)	461F0600	27
WASHER 6.5X20X1.6T (Ref # 7)	92022-125	12
DAMPER RUBBER (Ref # 8)	92075-051	4
SCREW PAN HEAD 6X20 (Ref # 9)	220B0620	3
SCREW PAN HEAD 6X20 (Ref # 10)	220E0620	3
WASHER PLAIN (Ref # 11)	92022-024	2
NUT 6MM (Ref # 12)	312B0600	5
BOLT-UPSET (Ref # 13)	112G0625	2
BOLT-UPSET (Ref # 13)	112G0625	AL
BOLT-UPSET,6X40 (Ref # 14)	112G0640	2
FENDER-RR,L.GREEN (Ref # 15)	35022-075-90	1
BRACE-REAR FENDER (Ref # 16)	35034-010	1
GROMMET HARNESS 10MM (Ref # 17)	92071-010	1
GROMMET HARNESS 10MM (Ref # 18)	92071-019	1
BOLT HEX HEAD 6X18 (Ref # 19)	110N0618	2
WASHER 6.5X20X1.6T (Ref # 20)	92022-125	4
DAMPER RUBBER (Ref # 21)	92075-051	6
COLLAR (Ref # 22)	92027-103	6
BOLT-UPSET,6X20 (Ref # 23)	112G0620	4
BOLT-UPSET,6X20 (Ref # 23)	112G0620	AL
CLAMP CABLE (Ref # 24)	92037-020	1
SCREW PAN HEAD 6X14 (Ref # 25)	220B0614	8
SCREW PAN HEAD 6X14 (Ref # 26)	220E0614	6
WASHER PLAIN (Ref # 27)	92022-024	18