

1975 F9-C PARTS DIAGRAM

TRANSMISSION/CHANGE DRUM

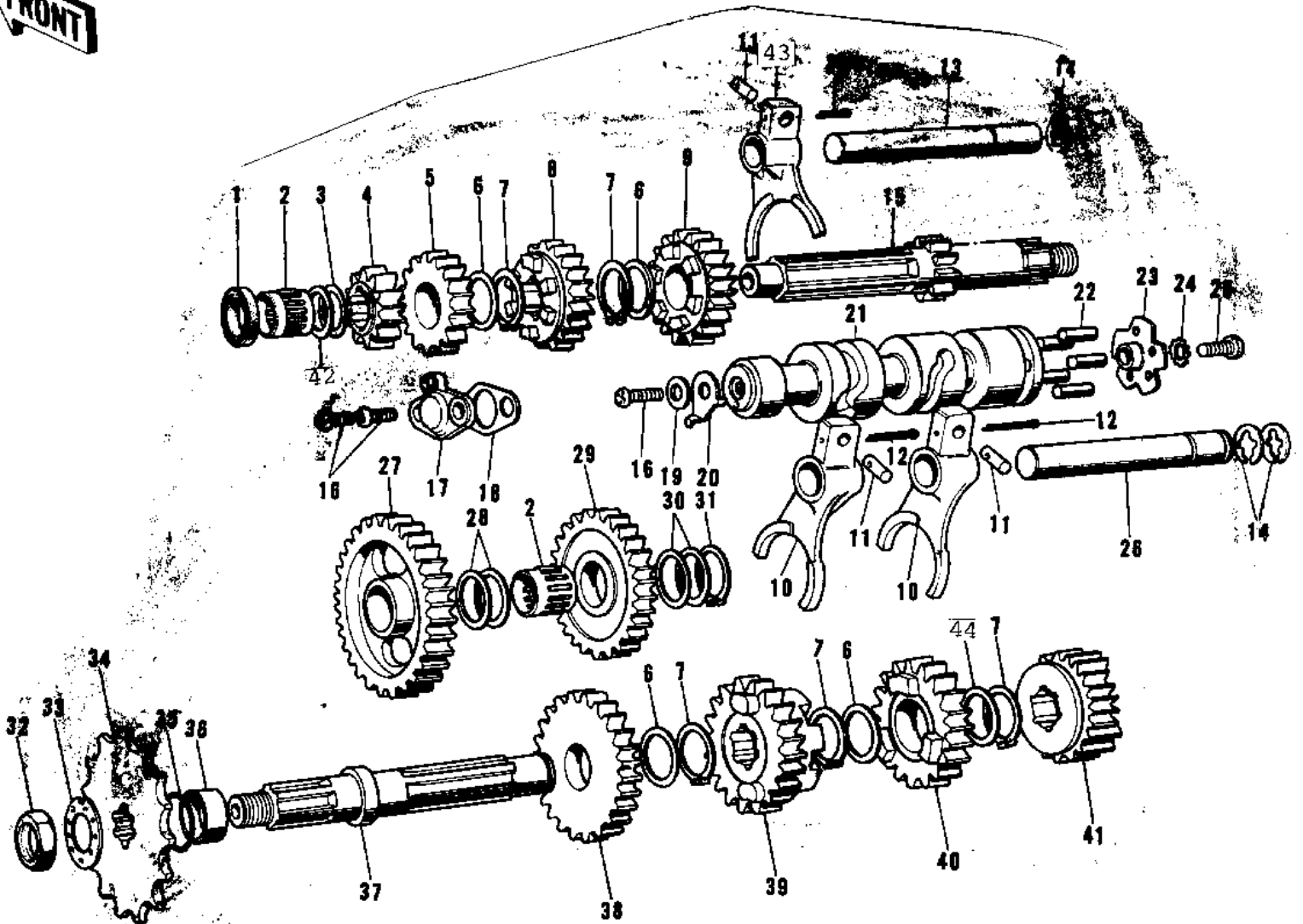

1975 F9-C PARTS LIST

TRANSMISSION/CHANGE DRUM

| ITEM NAME | PART NUMBER | QUANTITY |
|----------------------------------|-------------|----------|
| OIL SEAL-CLTH PSH RO (Ref # 1) | 92050-034 | |
| BEARING-NEEDLE (Ref # 2) | 92046-025 | |
| WASHER THRUST (Ref # 3) | 92022-113 | |
| 2ND GEAR-DRIVE SHAFT (Ref # 4) | 13130-021 | |
| 4TH GEAR-DRIVE SHAFT (Ref # 5) | 13134-005 | |
| WASHER PLAIN (Ref # 6) | 92022-161 | |
| CIRCLIP (Ref # 7) | 92033-026 | |
| 3RD GEAR-DRIVE SHAFT (Ref # 8) | 13132-020 | |
| TOP GEAR,DRIVE SHAFT (Ref # 9) | 13136-047 | |
| FORK,SELECTOR (Ref # 10) | 13140-051 | |
| PIN SELECT FORK GUID (Ref # 11) | 92043-005 | |
| PIN COTTER 3.0X18 (Ref # 12) | 550D3018 | |
| ROD-SHIFT (Ref # 13) | 13209-009 | |
| CIRCLIP 10MM (Ref # 14) | 482J0100 | |
| SHAFT-DRIVE (Ref # 15) | 13127-025 | |
| SCREW PAN HEAD 6X16 (Ref # 16) | 220B0616 | |
| SWITCH,NEUTRAL (Ref # 17) | 13151-1001 | |
| GASKET NEUTRAL SWITCH (Ref # 18) | 13146-002 | |
| WASHER PLAIN 6MM (Ref # 19) | 410B0600 | |
| ROTOR,NEUTRAL INDICT (Ref # 20) | 21007-1003 | |
| DRUM ASSY-GEAR CHANGE (Ref # 21) | 13239-006 | |
| PIN-CHANGE DRUM (Ref # 22) | 92042-020 | |
| PLATE-CHANGE DRUM PI (Ref # 23) | 13142-010 | |
| WASHER LOCK 6MM (Ref # 24) | 464H0600 | |
| SCREW CNTSNK HD 6X20 (Ref # 25) | 221B0620 | |
| ROD-SHIFT (Ref # 26) | 13209-010 | |
| LOW GEAR-OUTPUT SHAFT (Ref # 27) | 13129-042 | |
| WASHER THRUST (Ref # 28) | 92022-112 | |
| IDLE GEAR-KICKSTARTE (Ref # 29) | 13073-005 | |

1975 F9-C PARTS LIST

TRANSMISSION/CHANGE DRUM

| ITEM NAME | PART NUMBER | QUANTITY |
|---------------------------------|-------------|----------|
| WASHER THRUST (Ref # 30) | 92022-112 | |
| WASHER THRUST (Ref # 30) | 92002-144 | |
| CIRCLIP,19MM (Ref # 31) | 480J1900 | |
| NUT 18MM (Ref # 32) | 92015-019 | |
| WASHER,LOCK,18MM (Ref # 33) | 92024-067 | |
| WASHER,LOCK,18MM (Ref # 33) | 92024-067 | |
| ENGINE SPROCKET 14T (Ref # 34) | 13144-017 | |
| ENG SPROCKET 13T (OP (Ref # 34) | 13144-043 | |
| ENGINE SPROCKET 15T (Ref # 34) | 13144-025 | |
| "O" RING (Ref # 35) | 92055-035 | |
| COLLAR-ENG SPROKET (Ref # 36) | 92027-163 | |
| COLLAR-ENG SPROKET (Ref # 36) | 92027-163 | |
| SHAFT-OUTPUT (Ref # 37) | 13128-027 | |
| 2ND GEAR-OUTPUT SHAF (Ref # 38) | 13131-024 | |
| 4TH GEAR-OUTPUT SHAF (Ref # 39) | 13135-009 | |
| 3RD GEAR-OUTPUT SHAF (Ref # 40) | 13133-019 | |
| TOP GEAR-OUTPUT SHAF (Ref # 41) | 13137-013 | |
| WASHER,THRUST (Ref # 42) | 92022-223 | |
| FORK-SELECTOR (Ref # 43) | 13140-052 | |
| WASHER,LOCK (Ref # 44) | 92024-060 | |