

1981 LTD PARTS DIAGRAM

CYLINDER HEAD (KZ750-H2/H3)

E 111 0033

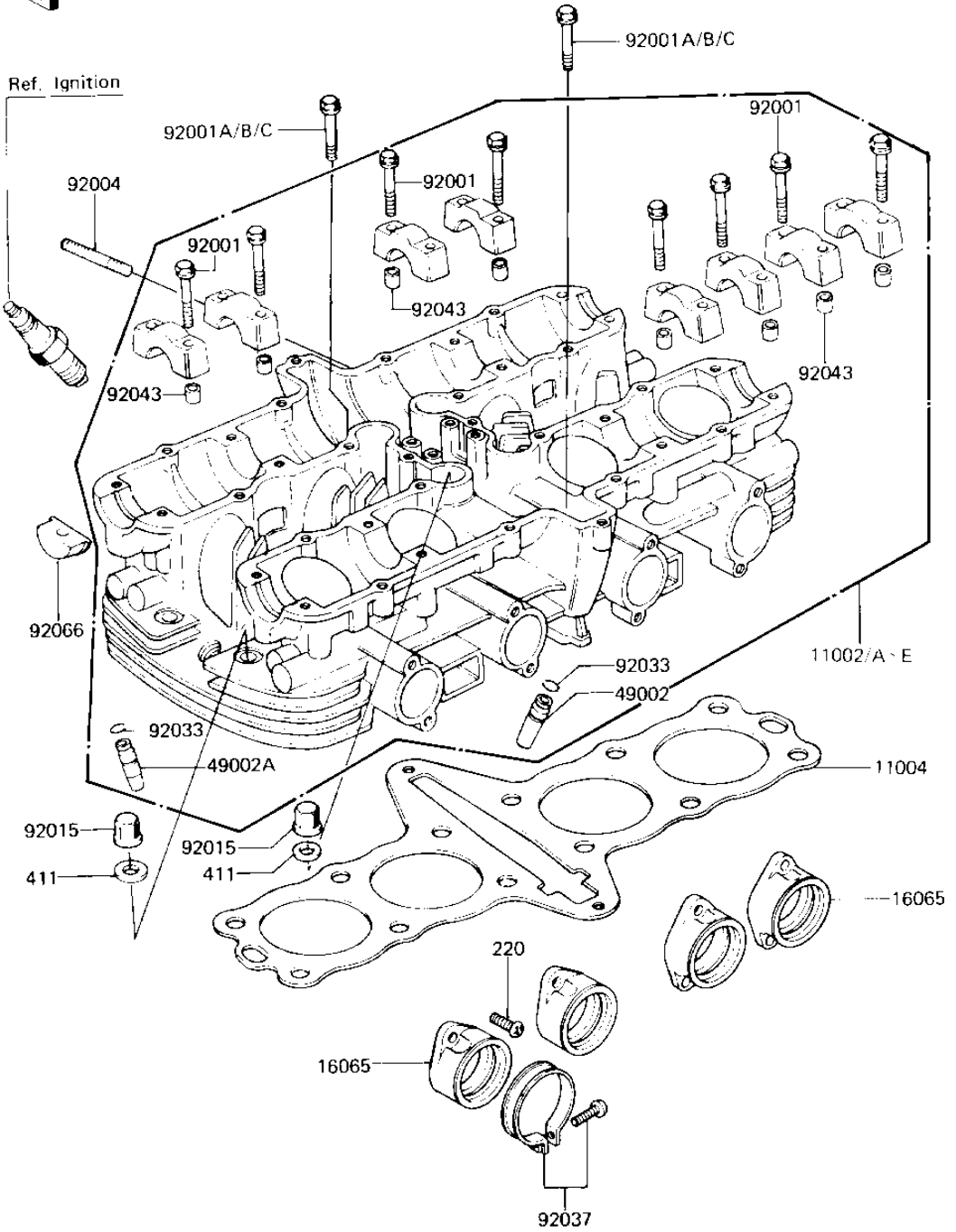

1981 LTD PARTS LIST

CYLINDER HEAD (KZ750-H2/H3)

ITEM NAME	PART NUMBER	QUANTITY
HEAD-ASSY-CYLINDER,SL (Ref # 11002)	11002-1082	1
11002-1082 (Canada) (Ref # 11002A)	11002-1069	1
HEAD-ASSY-CYLINDER,SL (Ref # 11002B)	11002-1082	1
HEAD-ASSY-CYLINDER,SL (Ref # 11002C)	11002-1082	1
HEAD-ASSY-CYLINDER,SL (Ref # 11002D)	11002-1082	1
11002-1082 (Canada) (Ref # 11002E)	11002-1083	1
GASKET-HEAD,CYLINDER (Ref # 11004)	11004-1107	1
HOLDER-CARBURETOR (Ref # 16065)	16065-1132	4
GUIDE,INLET VALVE (Ref # 49002)	12013-009	4
GUIDE,EXHAUST VALVE (Ref # 49002A)	49002-1002	4
BOLT,FLANGED,6X38 (Ref # 92001)	92001-1105	16
BOLT,FLANGED,8X43 (Ref # 92001A)	92001-1445	2
BOLT,FLANGED,8X43 (Ref # 92001C)	92001-1445	2
STUD,6X27 (Ref # 92004)	92004-066	8
NUT,CYLINDER HEAD (Ref # 92015)	92015-076	12
CIRCLIP-VALVE (Ref # 92033)	92036-023	8
CLAMP-INLET PIPE (Ref # 92037)	92037-061	4
PIN-DOWEL (Ref # 92043)	92042-007	16
PLUG,CAMSHAFT,11.35X1 (Ref # 92066)	92066-1111	4
SCREW PAN HEAD 6X16 (Ref # 220)	220B0616	8
WASHER PLAIN 10MM (Ref # 411)	411B1000	12