

# 1983 LTD PARTS DIAGRAM

CYLINDER HEAD (KZ750-H2/H3)

E 111 0033

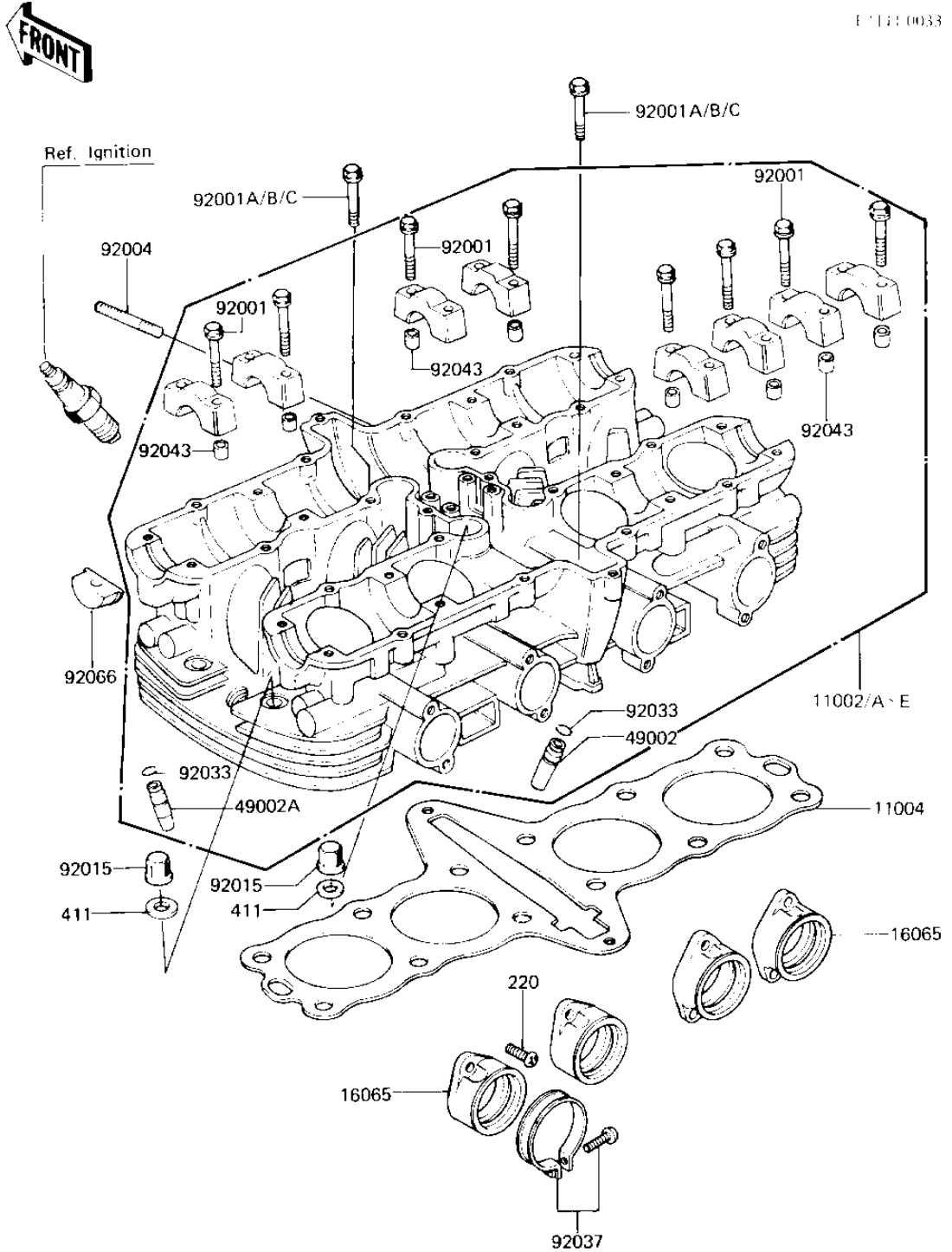

# 1983 LTD PARTS LIST

## CYLINDER HEAD (KZ750-H2/H3)

| ITEM NAME                            | PART NUMBER | QUANTITY |
|--------------------------------------|-------------|----------|
| HEAD-ASSY-CYLINDER,SL (Ref # 11002)  | 11002-1082  | 1        |
| 11002-1082 (Canada) (Ref # 11002A)   | 11002-1069  | 1        |
| HEAD-ASSY-CYLINDER,SL (Ref # 11002B) | 11002-1082  | 1        |
| HEAD-ASSY-CYLINDER,SL (Ref # 11002C) | 11002-1082  | 1        |
| HEAD-ASSY-CYLINDER,SL (Ref # 11002D) | 11002-1082  | 1        |
| 11002-1082 (Canada) (Ref # 11002E)   | 11002-1083  | 1        |
| GASKET-HEAD,CYLINDER (Ref # 11004)   | 11004-1107  | 1        |
| HOLDER-CARBURETOR (Ref # 16065)      | 16065-1132  | 4        |
| GUIDE,INLET VALVE (Ref # 49002)      | 12013-009   | 4        |
| GUIDE,EXHAUST VALVE (Ref # 49002A)   | 49002-1002  | 4        |
| BOLT,FLANGED,6X38 (Ref # 92001)      | 92001-1105  | 16       |
| BOLT,FLANGED,8X43 (Ref # 92001A)     | 92001-1445  | 2        |
| BOLT,FLANGED,8X43 (Ref # 92001C)     | 92001-1445  | 2        |
| STUD,6X27 (Ref # 92004)              | 92004-066   | 8        |
| NUT,CYLINDER HEAD (Ref # 92015)      | 92015-076   | 12       |
| CIRCLIP-VALVE (Ref # 92033)          | 92036-023   | 8        |
| CLAMP-INLET PIPE (Ref # 92037)       | 92037-061   | 4        |
| PIN-DOWEL (Ref # 92043)              | 92042-007   | 16       |
| PLUG,CAMSHAFT,11.35X1 (Ref # 92066)  | 92066-1111  | 4        |
| SCREW PAN HEAD 6X16 (Ref # 220)      | 220B0616    | 8        |
| WASHER PLAIN 10MM (Ref # 411)        | 411B1000    | 12       |