

1981 KZ750-E2 PARTS DIAGRAM

CYLINDER HEAD ('81 -'82 KZ750-E2/E3)

E1111-0033

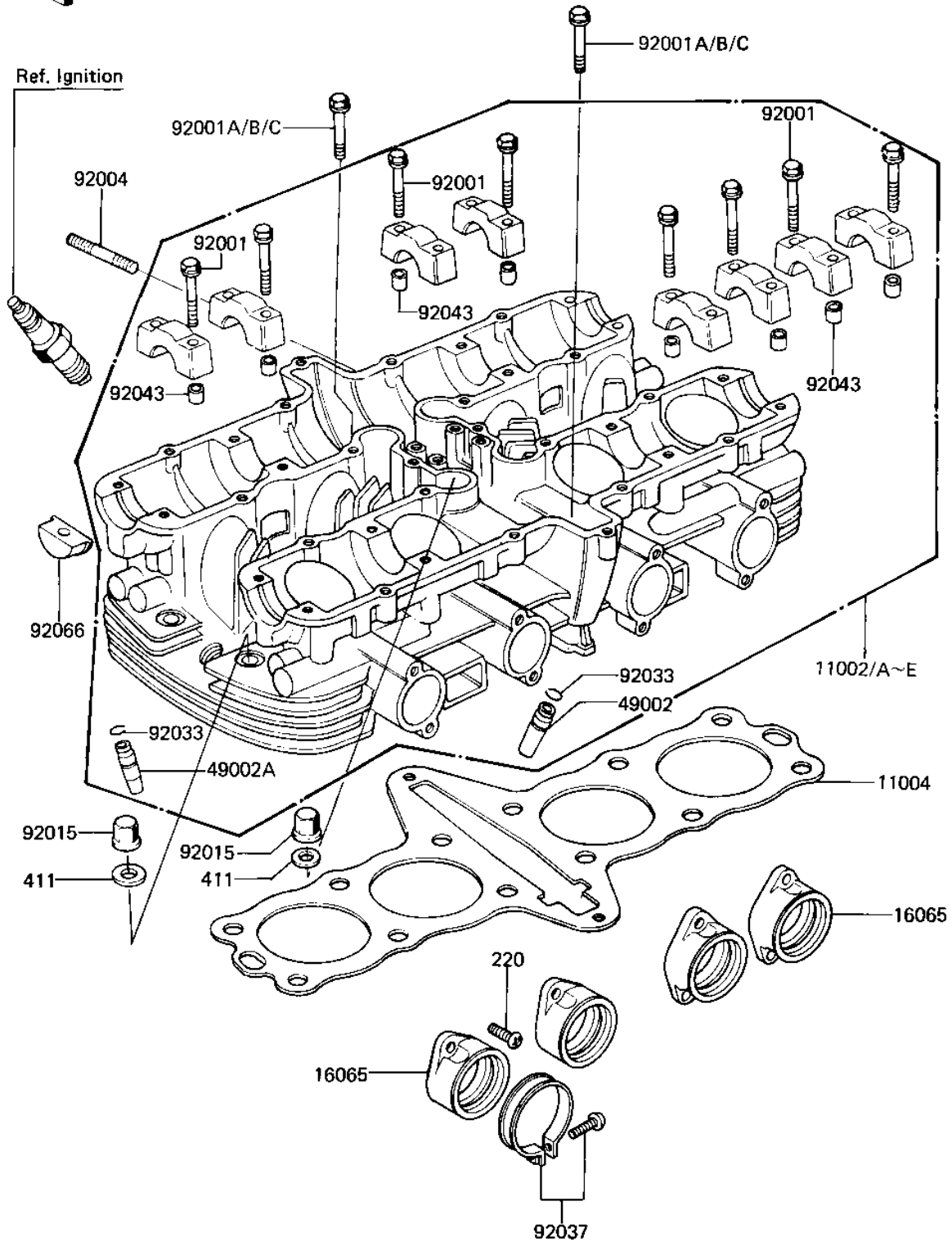

1981 KZ750-E2 PARTS LIST

CYLINDER HEAD ('81 -'82 KZ750-E2/E3)

| ITEM NAME | PART NUMBER | QUANTITY |
|--------------------------------------|-------------|----------|
| HEAD-ASSY-CYLINDER,BL (Ref # 11002) | 11002-1078 | 1 |
| HEAD-ASSY-CYLINDER,BL (Ref # 11002A) | 11002-1077 | 1 |
| HEAD-ASSY-CYLINDER,BL (Ref # 11002B) | 11002-1077 | 1 |
| HEAD-ASSY-CYLINDER,BL (Ref # 11002D) | 11002-1078 | 1 |
| HEAD-ASSY-CYLINDER,BL (Ref # 11002E) | 11002-1078 | 1 |
| GASKET-HEAD,CYLINDER (Ref # 11004) | 11004-1107 | 1 |
| HOLDER-CARBURETOR (Ref # 16065) | 16065-1132 | 4 |
| GUIDE,INLET VALVE (Ref # 49002) | 12013-009 | 4 |
| GUIDE,EXHAUST VALVE (Ref # 49002A) | 49002-1002 | 4 |
| BOLT,FLANGED,6X38 (Ref # 92001) | 92001-1105 | 16 |
| BOLT,FLANGED,8X43 (Ref # 92001A) | 92001-1445 | 2 |
| BOLT,FLANGED,8X43 (Ref # 92001C) | 92001-1445 | 2 |
| STUD,6X27 (Ref # 92004) | 92004-066 | 8 |
| NUT,CYLINDER HEAD (Ref # 92015) | 92015-076 | 12 |
| CIRCLIP-VALVE (Ref # 92033) | 92036-023 | 8 |
| CLAMP-INLET PIPE (Ref # 92037) | 92037-061 | 4 |
| PIN-DOWEL (Ref # 92043) | 92042-007 | 16 |
| PLUG,CAMSHAFT,11.35X1 (Ref # 92066) | 92066-1111 | 4 |
| SCREW PAN HEAD 6X16 (Ref # 220) | 220B0616 | 8 |
| WASHER PLAIN 10MM (Ref # 411) | 411B1000 | 12 |