

1981 KZ750-E2 PARTS DIAGRAM

MUFFLERS ('81 -'82 KZ750-E2/E3)

E1140-0053

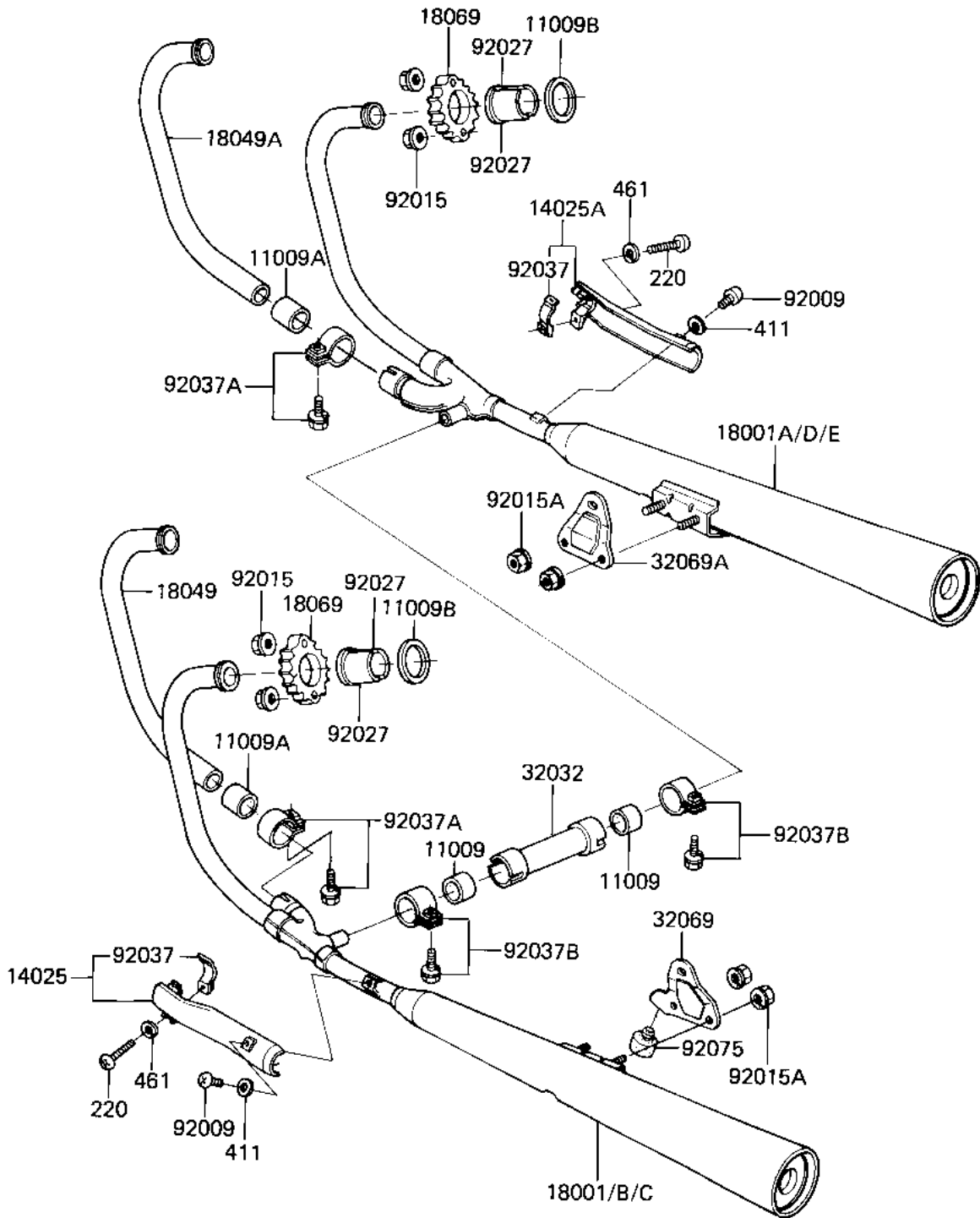

1981 KZ750-E2 PARTS LIST

MUFFLERS ('81 -'82 KZ750-E2/E3)

ITEM NAME	PART NUMBER	QUANTITY
GASKET,MUFFLER CONNEC (Ref # 11009)	11060-1051	2
GASKET,EXHAUST PIPE C (Ref # 11009A)	11009-1667	2
GASKET,EXHAUST PIPE H (Ref # 11009B)	11009-1866	4
COVER,MUFFLER,LH (Ref # 14025)	14025-1516	1
COVER,MUFFLER,RH (Ref # 14025A)	14025-1517	1
MUFFLER,LH (Ref # 18001)	18001-1254	1
MUFFLER,RH (Ref # 18001A)	18001-1255	1
MUFFLER,LH (Ref # 18001C)	18001-1254	1
MUFFLER,RH (Ref # 18001E)	18001-1255	1
PIPE-EXHAUST,#2 (Ref # 18049)	18049-1162	1
PIPE-EXHAUST,#3 (Ref # 18049A)	18049-1163	1
HOLDER,EXHAUST PIPE (Ref # 18069)	18069-1006	4
PIPE,MUFFLER CONNECTI (Ref # 32032)	32032-1669	1
BRACKET,MUFFLER L.H (Ref # 32069)	32069-1054	1
BRACKET,MUFFLER R.H (Ref # 32069A)	32069-1055	1
SCREW,PAN HEAD,6X8 (Ref # 92009)	92011-039	2
NUT-6MM (Ref # 92015)	92015-1078	8
NUT,LOCK,8MM (Ref # 92015A)	92017-013	4
COLLAR,EXHAUST PIPE (Ref # 92027)	92027-1142	8
CLAMP,MUFFLER COVER (Ref # 92037)	92037-1205	2
CLAMP,42MM (Ref # 92037A)	92037-1349	2
CLAMP,MUFFLER,37MM (Ref # 92037B)	92037-1243	2
DAMPER RUBBER,MAIN ST (Ref # 92075)	92075-1002	1
SCREW PAN HEAD 6X20 (Ref # 220)	220B0620	2
WASHER-PLAIN,6MM (Ref # 411)	411D0600	2
WASHER SPRING 6MM (Ref # 461)	461F0600	2