

# 1983 LTD PARTS DIAGRAM

MUFFLERS ('82-'83 C3/C4)

E1140-0038

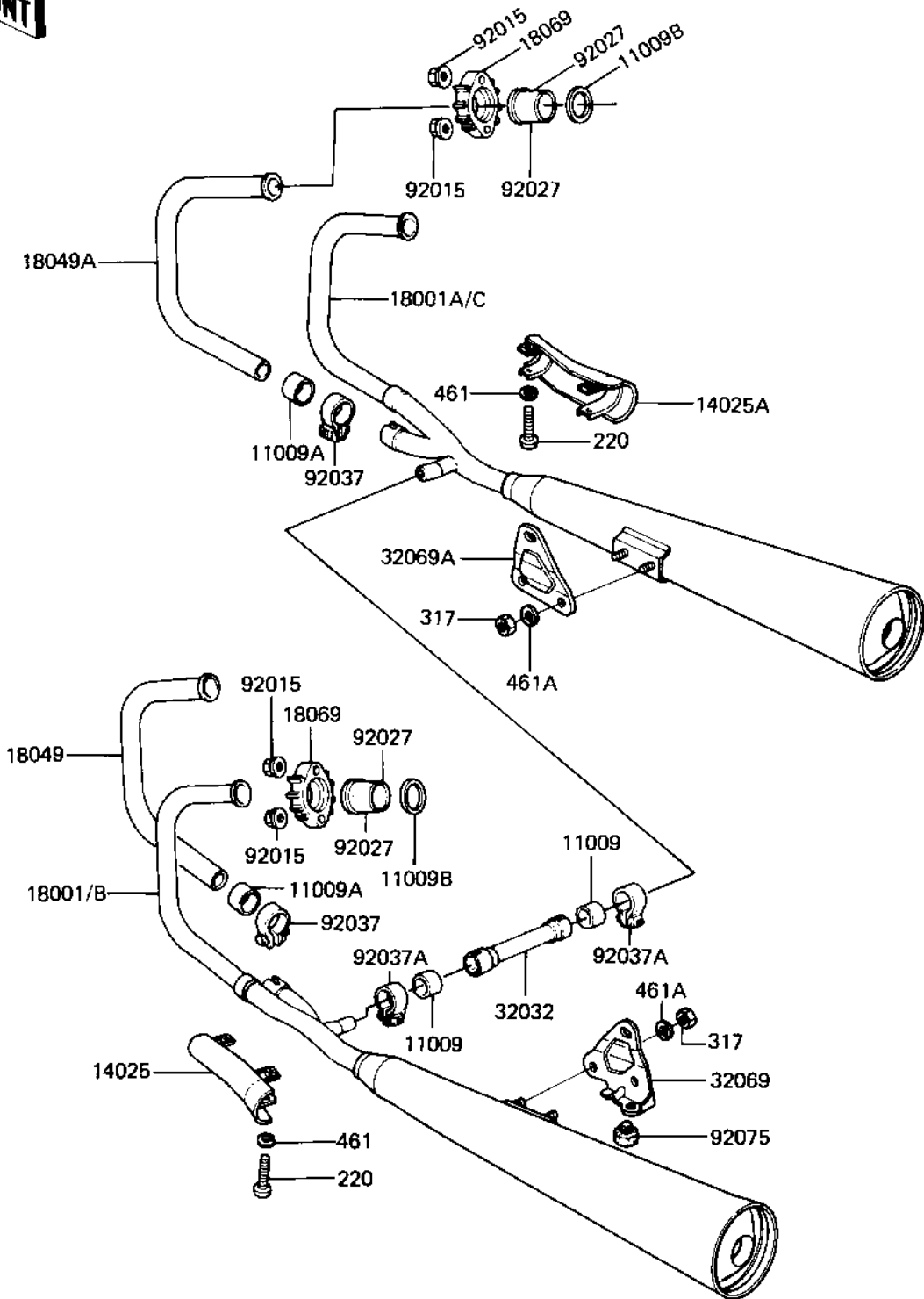

# 1983 LTD PARTS LIST

## MUFFLERS ('82-'83 C3/C4)

ITEM NAME	PART NUMBER	QUANTITY
GASKET,MUFFLER CONNEC (Ref # 11009)	11060-1051	2
GASKET,EXHAUST PIPE C (Ref # 11009A)	11009-1667	2
GASKET,EXHAUST PIPE H (Ref # 11009B)	11009-1866	4
COVER,MUFFLER,LH (Ref # 14025)	14025-1531	1
COVER,MUFFLER,RH (Ref # 14025A)	14025-1532	1
MUFFLER,LH (Ref # 18001B)	18001-1305	1
MUFFLER,RH (Ref # 18001C)	18001-1306	1
PIPE-EXHAUST,#2 (Ref # 18049)	18049-1154	1
PIPE-EXHAUST,#3 (Ref # 18049A)	18049-1155	1
HOLDER,EXHAUST PIPE (Ref # 18069)	18069-1006	4
PIPE,MUFFLER CONNECT1 (Ref # 32032)	32032-1671	1
BRACKET,MUFFLER,L.H. (Ref # 32069)	32069-1064	1
BRACKET,MUFFLER,R.H. (Ref # 32069A)	32069-1065	1
NUT-6MM (Ref # 92015)	92015-1078	8
COLLAR,EXHAUST PIPE (Ref # 92027)	92027-264	8
CLAMP,42MM (Ref # 92037)	92037-1349	2
CLAMP,MUFFLER,37MM (Ref # 92037A)	92037-1243	2
DAMPER RUBBER,MAIN ST (Ref # 92075)	92075-1002	1
SCREW PAN HEAD 6X40 (Ref # 220)	220B0640	4
NUT,8M/M (Ref # 317)	317B0800	4
WASHER SPRING 6MM (Ref # 461)	461F0600	4
WASHER SPRING 8MM (Ref # 461A)	461F0800	4