

1983 LTD PARTS DIAGRAM

TRANSMISSION ('81-'83 A2/A3/A4)

E1361-0001

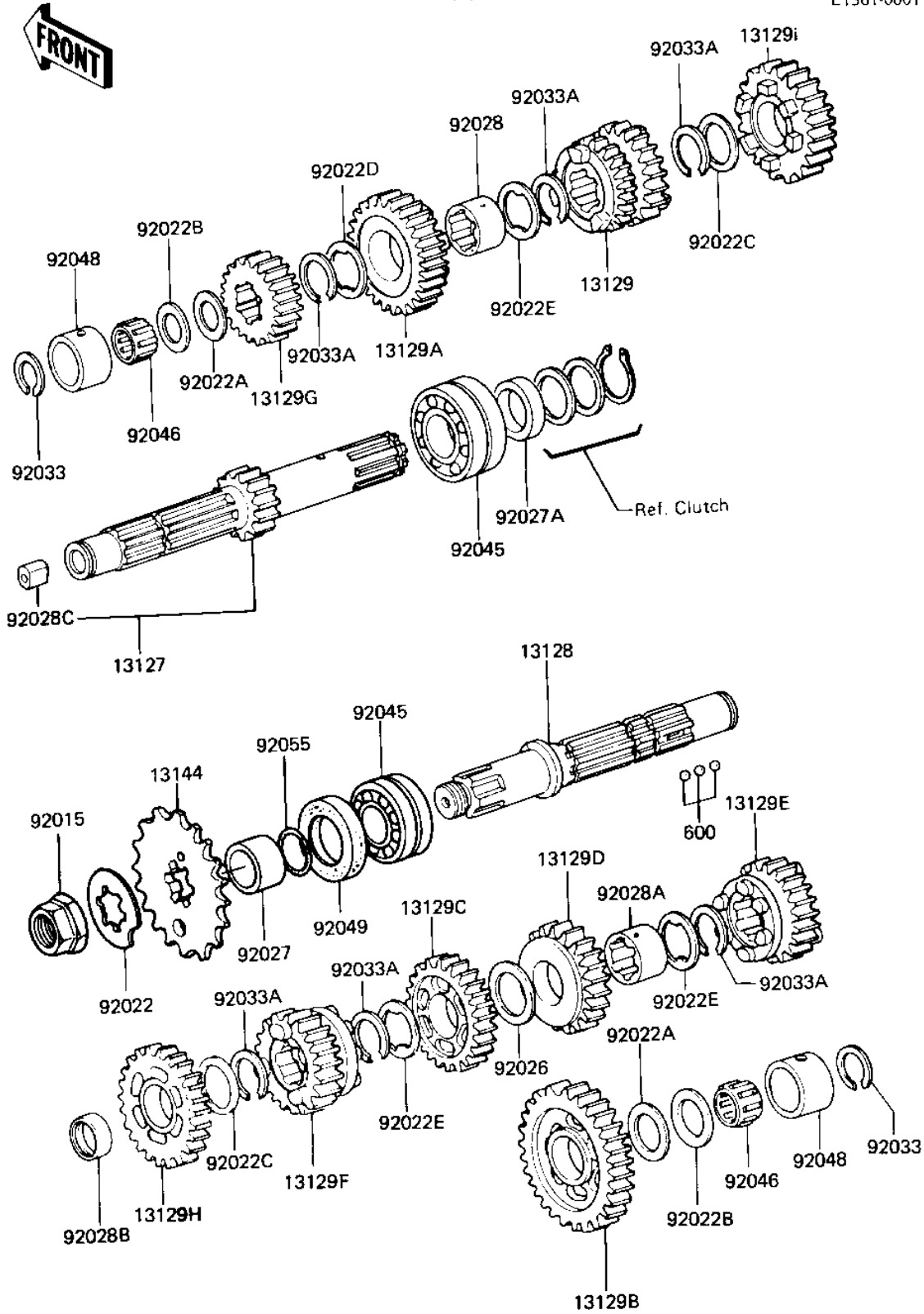

1983 LTD PARTS LIST

TRANSMISSION ('81-'83 A2/A3/A4)

ITEM NAME	PART NUMBER	QUANTITY
SHAFT,DRIVE,13T (Ref # 13127)	13127-1004	1
SHAFT,OUTPUT (Ref # 13128)	13128-1015	1
3RD-4TH GEAR,DRV SHFT (Ref # 13129)	13129-1054	1
TOP GEAR,DRV SHAFT (Ref # 13129A)	13129-1055	1
LOW GEAR,OUTPUT SHAFT (Ref # 13129B)	13129-1056	1
3RD GEAR,OUTPUT SHAFT (Ref # 13129C)	13129-1058	1
4TH GEAR,OUTPUT SHAFT (Ref # 13129D)	13129-1059	1
5TH GEAR,OUTPUT SHAFT (Ref # 13129E)	13129-1060	1
TOP GEAR,OUTPUT SHAFT (Ref # 13129F)	13129-1061	1
2ND GEAR,DRV SHAFT (Ref # 13129G)	13129-1062	1
2ND GEAR,OUTPUT,28T (Ref # 13129H)	13129-1172	1
GEAR,INPUT5TH,23T (Ref # 13129I)	13129-1277	1
ENGINE SPROCKET,15T (Ref # 13144)	13144-1018	1
NUT,20MM (Ref # 92015)	92015-1254	1
WASHER,SPLINE (Ref # 92022)	92022-1083	1
WASHER THRUST (Ref # 92022A)	92022-112	2
SHIM-KICK SHAFT (Ref # 92022B)	92022-144	AR
WASHER-PLAIN 25MM (Ref # 92022C)	92022-159	2
WASHER-LOCK (Ref # 92022D)	92024-033	1
WASHER-LOCK (Ref # 92022E)	92024-038	3
WASHER,THRUST (Ref # 92026)	92026-079	1
COLLAR,ENG SPROCKET (Ref # 92027)	92027-288	1
COLLAR (Ref # 92027A)	92027-289	1
BUSHING,OUTPUT 3RD GR (Ref # 92028)	92028-1002	1
BUSHING,OUTPUT GEAR (Ref # 92028A)	92028-1268	1
BUSHING,2ND GEAR (Ref # 92028B)	92028-1177	1
BUSHING,DRIVE SHAFT (Ref # 92028C)	92028-155	1
CIRCLIP (Ref # 92033)	92033-015	2
CIRCLIP (Ref # 92033A)	92033-026	6

1983 LTD PARTS LIST

TRANSMISSION ('81-'83 A2/A3/A4)

ITEM NAME	PART NUMBER	QUANTITY
BEARING,B,5205ANX4PX (Ref # 92045)	92045-031	2
BRG,N,20R25139 (Ref # 92046)	92046-044	2
RACE,OUT & DRV SHAFT (Ref # 92048)	92048-1001	2
OIL SEAL SC325210 (Ref # 92049)	92050-024	1
"O" RING (Ref # 92055)	92055-035	1
BALL STEEL 5/32' (Ref # 600)	600A0500	3