

1971 Centurion PARTS DIAGRAM

TRANSMISSION/CHANGE DRUM

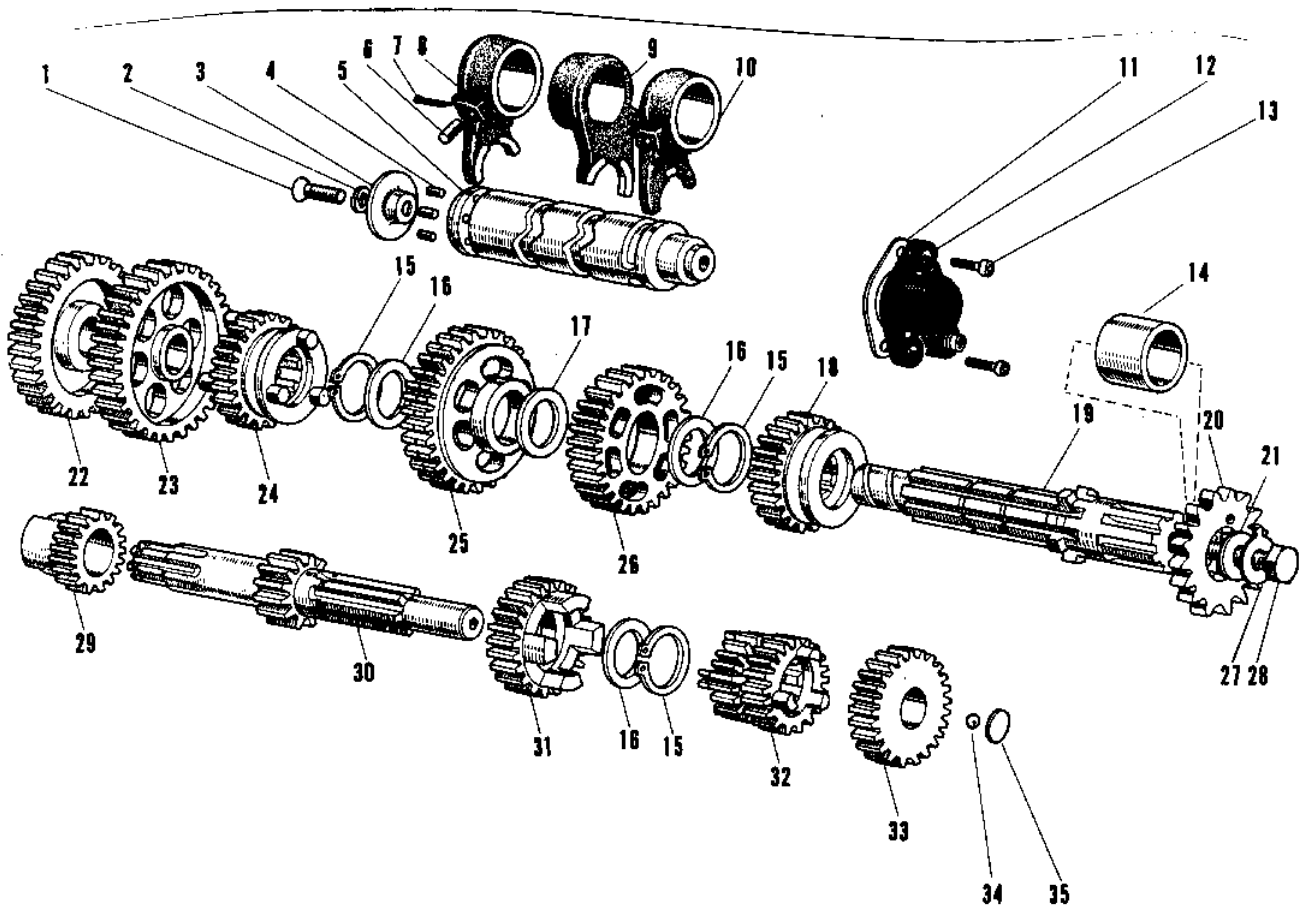

1971 Centurion PARTS LIST

TRANSMISSION/CHANGE DRUM

ITEM NAME	PART NUMBER	QUANTITY
SCREW PAN HEAD 6X12 (Ref # 1)	220B0612	
WASHER LOCK 6MM (Ref # 2)	464H0600	
PLATE CHANGE DRUM PIN (Ref # 3)	13142-008	
PIN GEAR CHANGE DRUM (Ref # 4)	92042-014	
GEAR CHANGE DRUM (Ref # 5)	13141-010	
PIN SELECT FORK GUIDE (Ref # 6)	92043-005	
PIN COTTER 3.0X20 (Ref # 7)	550D3020	
FORK SELECTOR LOW-2ND (Ref # 8)	13140-010	
FORK SELECTOR 4TH-TOP (Ref # 9)	13140-017	
FORK SELECTOR 3RD (Ref # 10)	13140-009	
GASKET NEUTRAL SWITCH (Ref # 11)	13146-002	
SWITCH,NEUTRAL (Ref # 12)	13151-1001	
SCREW PAN HEAD 6X16 (Ref # 13)	220B0616	
SPACER ENG SPROCKET (Ref # 14)	92027-009	
CIRCLIP (Ref # 15)	92033-014	
WASHER THRUST (Ref # 16)	92022-118	
WASHER THRUST (Ref # 17)	92022-146	
UNAVAILABLE IN PRICE BOOK (Ref # 18)	13137-003	
SHAFT OUTPUT (Ref # 19)	13128-021	
SPROCKET-OUTPUT,14T (Ref # 20)	13144-1058	
ENG SPROCKET ASY,13T (Ref # 20)	13249-001	
ENG SPROCKET,ASY,15T (Ref # 20)	13249-003	
ENGINE SPROCKET 16T (Ref # 20)	13144-040	
WASHER ENG SPROCKET (Ref # 21)	92022-130	
IDLE GEAR (Ref # 22)	13073-004	
LOW GEAR OUTPUT SHAFT (Ref # 23)	13129-025	
GEAR-TRANSMISSION SPU (Ref # 24)	13129-1708	
2ND GEAR OUTPUT SHAFT (Ref # 25)	13131-021	
3RD GEAR OUTPUT SHAFT (Ref # 26)	13133-005	

1971 Centurion PARTS LIST

TRANSMISSION/CHANGE DRUM

ITEM NAME	PART NUMBER	QUANTITY
WASHER LOCK 8MM (Ref # 27)	92030-007	
BOLT-SMALL-UPSET,8X16 (Ref # 28)	115G0816	
PINION KICKSTARTER (Ref # 29)	13075-004	
UNAVAILABLE IN PRICE BOOK (Ref # 30)	13127-021	
4TH GEAR,DRIVE (Ref # 31)	13129-1053	
2ND-3RD GEAR DRV SHFT (Ref # 32)	13130-019	
GEAR,INPUT TOP,24T (Ref # 33)	13129-1927	
BALL STEEL 7/32' (Ref # 34)	600A0700	
WASHER THRUST (Ref # 35)	92022-115	