

1980 KE125 PARTS DIAGRAM

OWNER TOOLS ('80-'81 A7/A8)

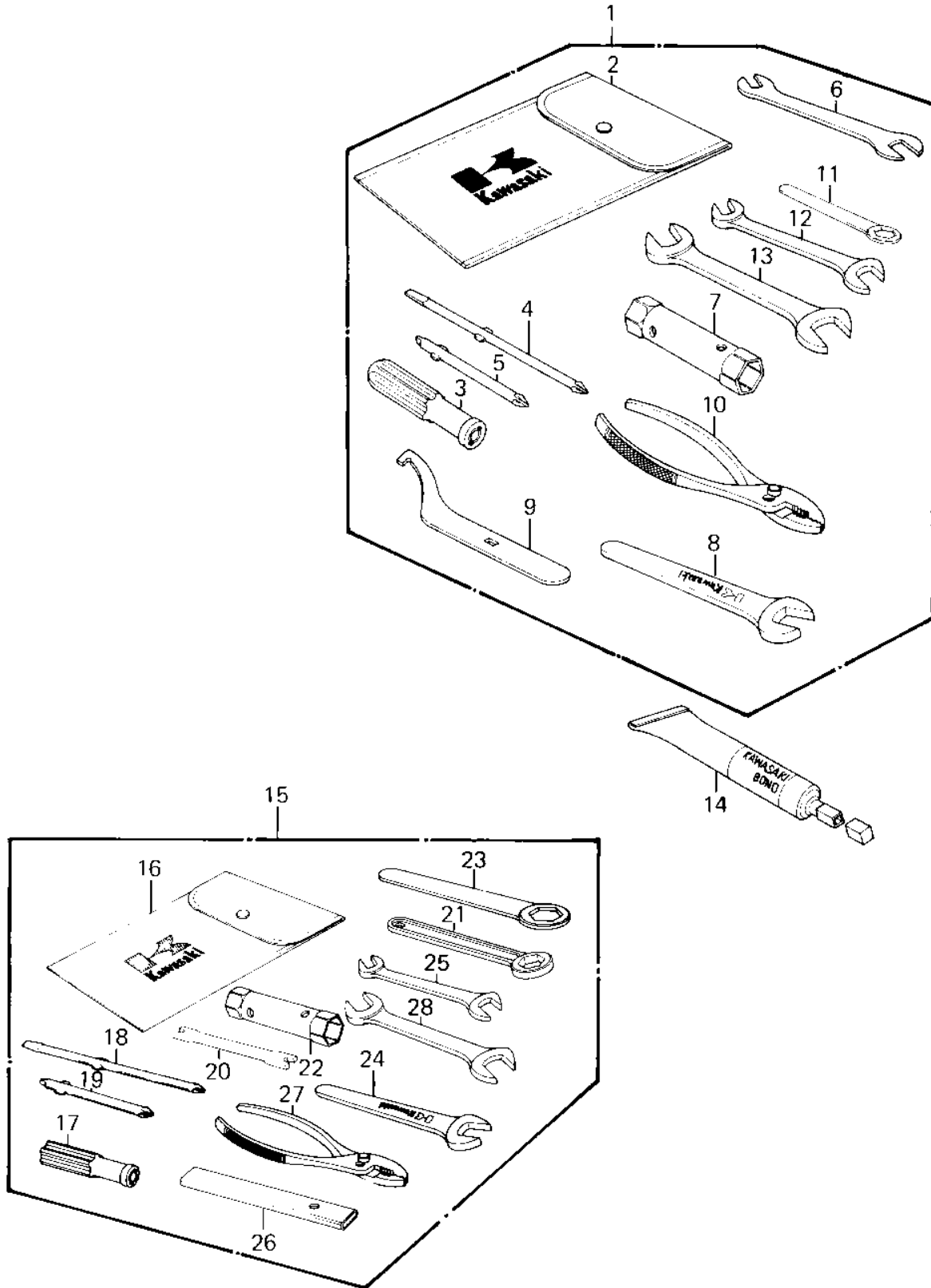

1980 KE125 PARTS LIST

OWNER TOOLS ('80-'81 A7/A8)

| ITEM NAME | PART NUMBER | QUANTITY |
|----------------------------------|-------------|----------|
| TOOL KIT (Ref # 1) | 56007-1058 | 1 |
| BAG,TOOL (Ref # 2) | 56008-008 | 1 |
| GRIP,SCREW DRIVER (Ref # 3) | 92106-1001 | 1 |
| TOOL-DRIVER (Ref # 4) | 92107-1052 | 1 |
| SCREW DRIVER #3 PHLIP (Ref # 5) | 92107-005 | 1 |
| TIGHTENER,SPOKE (Ref # 6) | 92108-011 | 1 |
| WRENCH,BOX,17X21 (Ref # 7) | 92110-012 | 1 |
| WRENCH,OPEN END,10M/M (Ref # 8) | 92110-1031 | 1 |
| 92110-1035 (Canada) (Ref # 9) | 92110-1006 | 1 |
| PLIERS,160MM (Ref # 10) | 92112-003 | 1 |
| TOOL-WRENCH,BOX END,2 (Ref # 11) | 92110-1150 | 1 |
| WRENCH,OPEN END,12X13 (Ref # 12) | 92126-002 | 1 |
| TOOL-WRENCH,OPEN END, (Ref # 13) | 92110-1153 | 1 |
| LIQUID GASKET (Ref # 14) | 92104-002 | (1 |
| TOOLKIT (Ref # 15) | 56007-1073 | 1 |
| BAG,TOOL (Ref # 16) | 56008-009 | 1 |
| GRIP,SCREW DRIVER (Ref # 17) | 92106-1001 | 1 |
| TOOL-DRIVER (Ref # 18) | 92107-1052 | 1 |
| SCREW DRIVER #3 PHLIP (Ref # 19) | 92107-005 | 1 |
| TIGHTENER,SPOKE (Ref # 20) | 92108-011 | 1 |
| TOOL-WRENCH,BOX END,2 (Ref # 21) | 92110-1147 | 1 |
| WRENCH,BOX,17X21 (Ref # 22) | 92110-012 | 1 |
| TOOL-WRENCH,BOX END,2 (Ref # 23) | 92110-1150 | 1 |
| WRENCH,OPEN END,19M/M (Ref # 24) | 92110-1004 | 1 |
| TOOL-WRENCH,OPEN END (Ref # 25) | 92110-1038 | 1 |
| BAR, BOS END WRENCH (Ref # 26) | 92111-004 | 1 |
| PLIERS,160MM (Ref # 27) | 92112-003 | 1 |
| TOOL-WRENCH,OPEN END, (Ref # 28) | 92110-1153 | 1 |