

1983 KE125 PARTS DIAGRAM

FRAME ('82-'83 A9/A10)

F2120-0147

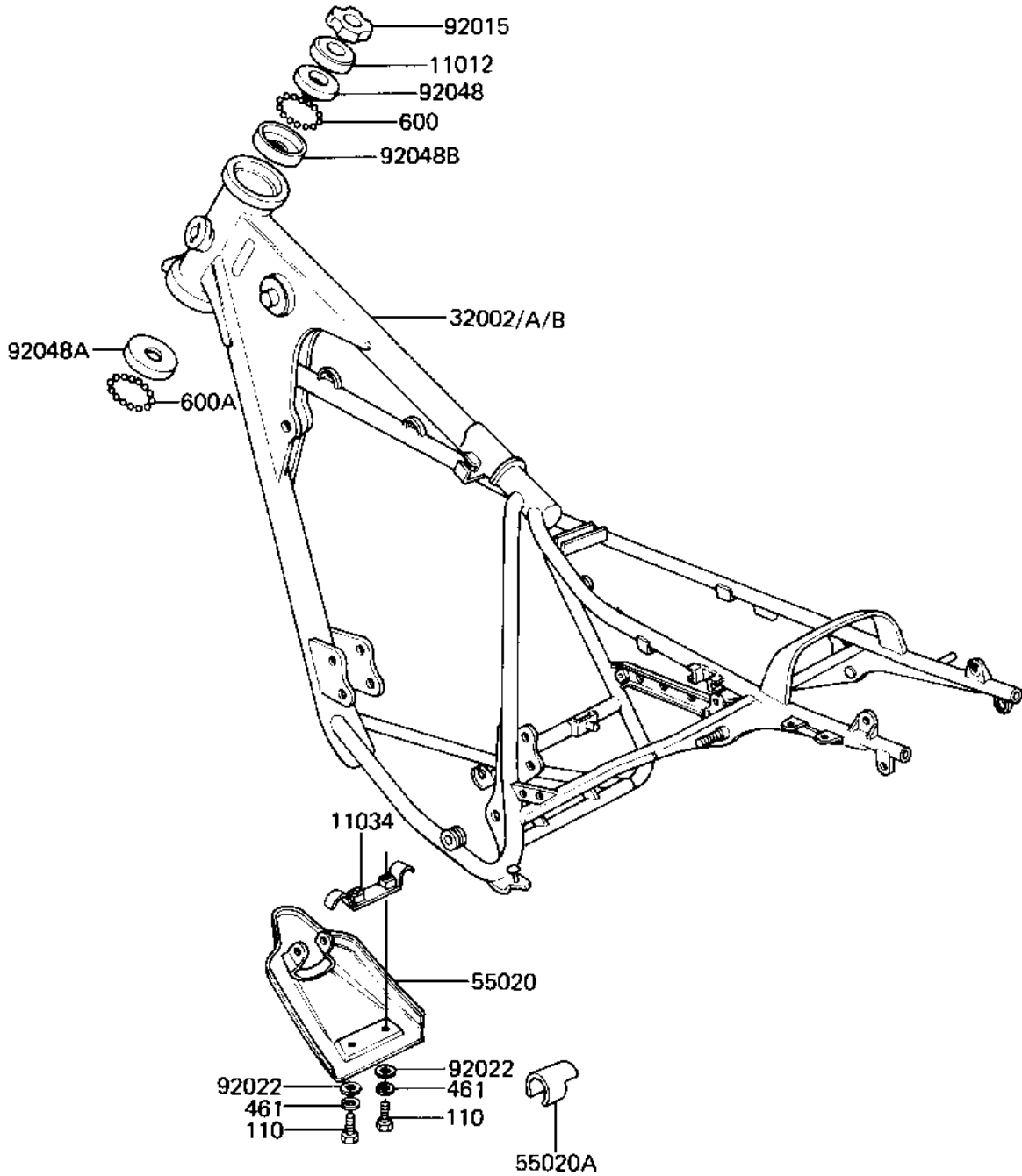

1983 KE125 PARTS LIST

FRAME ('82-'83 A9/A10)

| ITEM NAME | PART NUMBER | QUANTITY |
|---------------------------------------|-------------|----------|
| CAP,STEERING STEM (Ref # 11012) | 46098-018 | 1 |
| BRACKET,ENGINE GUARD (Ref # 11034) | 55016-008 | 1 |
| FRAME-COMP,US (Canada) (Ref # 32002A) | 32002-1487 | 1 |
| FRAME-COMP,US (Canada) (Ref # 32002B) | 32002-1487 | 1 |
| GUARD,ENGINE (Ref # 55020) | 55011-020 | 1 |
| GUARD,CHAIN (Ref # 55020A) | 55020-1045 | 1 |
| NUT,STEERING STEM (Ref # 92015) | 92090-022 | 1 |
| WASHER 6.5X20X1.6T (Ref # 92022) | 92022-125 | 2 |
| CONE,STRG STM BRG,UP (Ref # 92048) | 92047-014 | 1 |
| RACE STEERING BEARING (Ref # 92048A) | 92048-005 | 1 |
| RACE,STRG STM BEARING (Ref # 92048B) | 92048-009 | 1 |
| BOLT-UPSET,6X16 (Ref # 110) | 112G0616 | 2 |
| WASHER SPRING 6MM (Ref # 461) | 461F0600 | 2 |
| BALL STEEL 3/16' (Ref # 600) | 600A0600 | 23 |
| BALL STEEL 1/4' (Ref # 600A) | 600A0800 | 19 |