

# 1983 KE125 PARTS DIAGRAM

FRONT FORK (KE125-A10)

F2590-0132

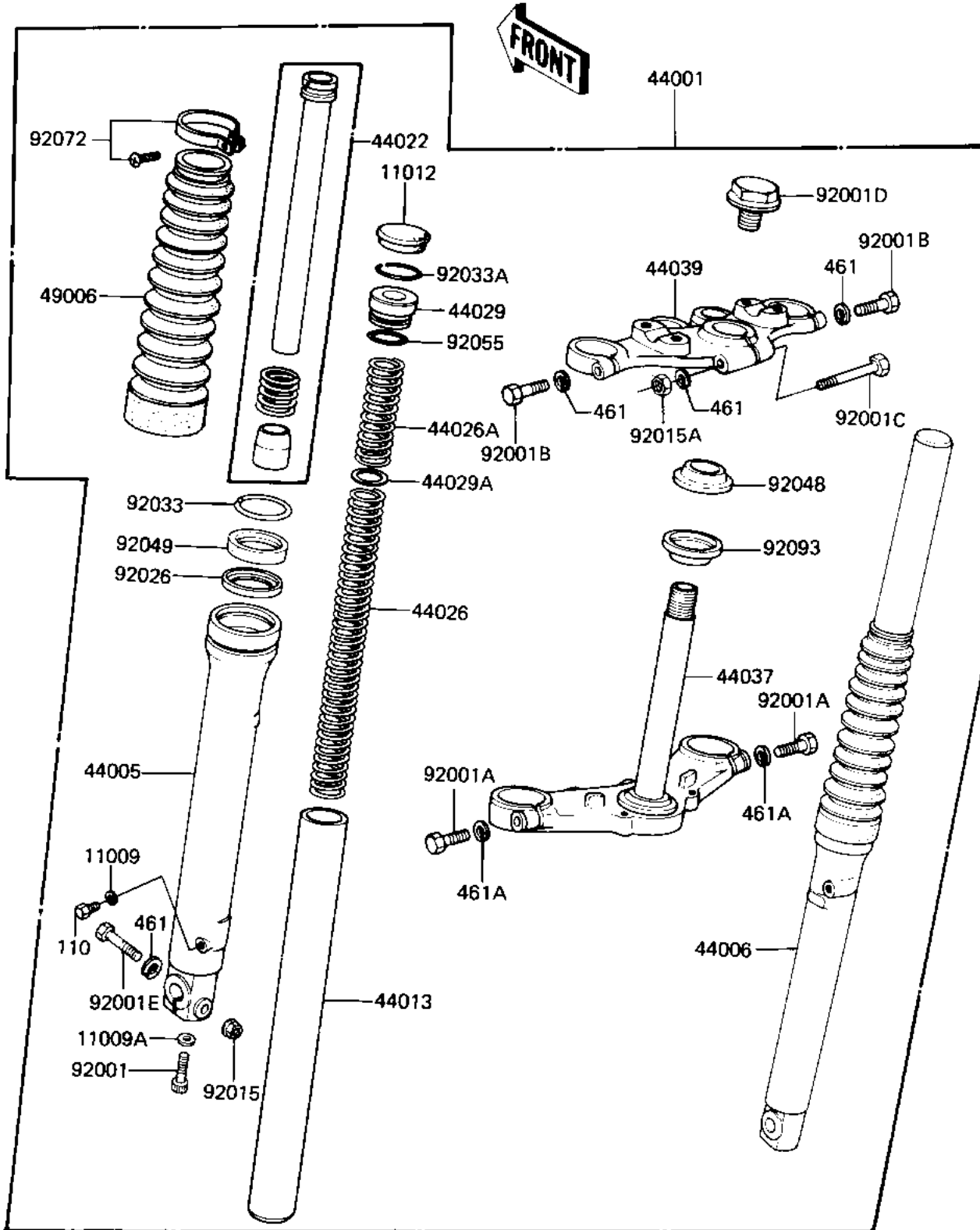

# 1983 KE125 PARTS LIST

## FRONT FORK (KE125-A10)

ITEM NAME	PART NUMBER	QUANTITY
GASKET,DRAIN PLUG (Ref # 11009)	44045-047	2
GASKET,FORK CYL BOLT (Ref # 11009A)	44045-051	2
CAP,FORK (Ref # 11012)	11012-1124	2
FORK-FRONT,BLACK (Canada) (Ref # 44001)	44001-1426-6Z	1
PIPE-LEFT FORK OUTER (Canada) (Ref # 44005)	44005-1118	2
PIPE-RIGHT FORK OUTER (Canada) (Ref # 44006)	44006-1118	1
PIPE-FORK INNER (Ref # 44013)	44013-1069	2
CYLINDER-FORK (Ref # 44022)	44022-1065	2
SPRING-FRONT FORK,LWR (Ref # 44026)	44026-1119	2
SPRING-FRONT FORK,UPP (Ref # 44026A)	44026-1137	2
GUIDE,SPRING (Ref # 44029)	44029-022	2
SEAT-FORK SPRING (Ref # 44029A)	44029-1033	2
HOLDER-FORK UNDER,WG (Ref # 44037)	44037-1078	1
HOLDER-FORK UPPER (Ref # 44039)	44039-1048	1
BOOT,FORK,BLACK (Ref # 49006)	49006-1047-6Z	2
BOLT,FORK CYLINDER (Ref # 92001)	44041-078	2
BOLT,HEX HEAD 10X35 (Ref # 92001A)	92001-1252	2
BOLT,8X40 (Ref # 92001B)	92001-1739	2
BOLT,8X55 (Ref # 92001C)	92001-1740	1
BOLT,STEERING STEM HE (Ref # 92001D)	92001-1741	1
BOLT,8X50 (Canada) (Ref # 92001E)	92001-1744	1
NUT-8MM (Ref # 92015)	92015-1022	1
NUT,8MM (Ref # 92015A)	92015-1235	1
SPACER,OUTER TUBE (Ref # 92026)	92026-1069	2
CIRCLIP,45MM (Ref # 92033)	44044-020	2
CIRCLIP (Ref # 92033A)	44044-023	2
CONE STERNG BERG LOW (Ref # 92048)	92047-010	1
SEAL-OIL,FORK OUTER (Ref # 92049)	92049-1080	2
"O" RING (Ref # 92055)	44046-025	2

# 1983 KE125 PARTS LIST

## FRONT FORK (KE125-A10)

ITEM NAME	PART NUMBER	QUANTITY
BAND,FORK,FR (Ref # 92072)	92072-1038	2
SEAL,STEERING STEM (Ref # 92093)	44010-027	1
BOLT HEX HEAD 6X8 (Ref # 110)	110B0608	2
WASHER SPRING 8MM (Ref # 461)	461F0800	4
WASHER SPRING 10MM (Ref # 461A)	461F1000	2