

1982 AR80-A1 PARTS DIAGRAM

IGNITION SWITCH/LOCKS/REFLECTORS

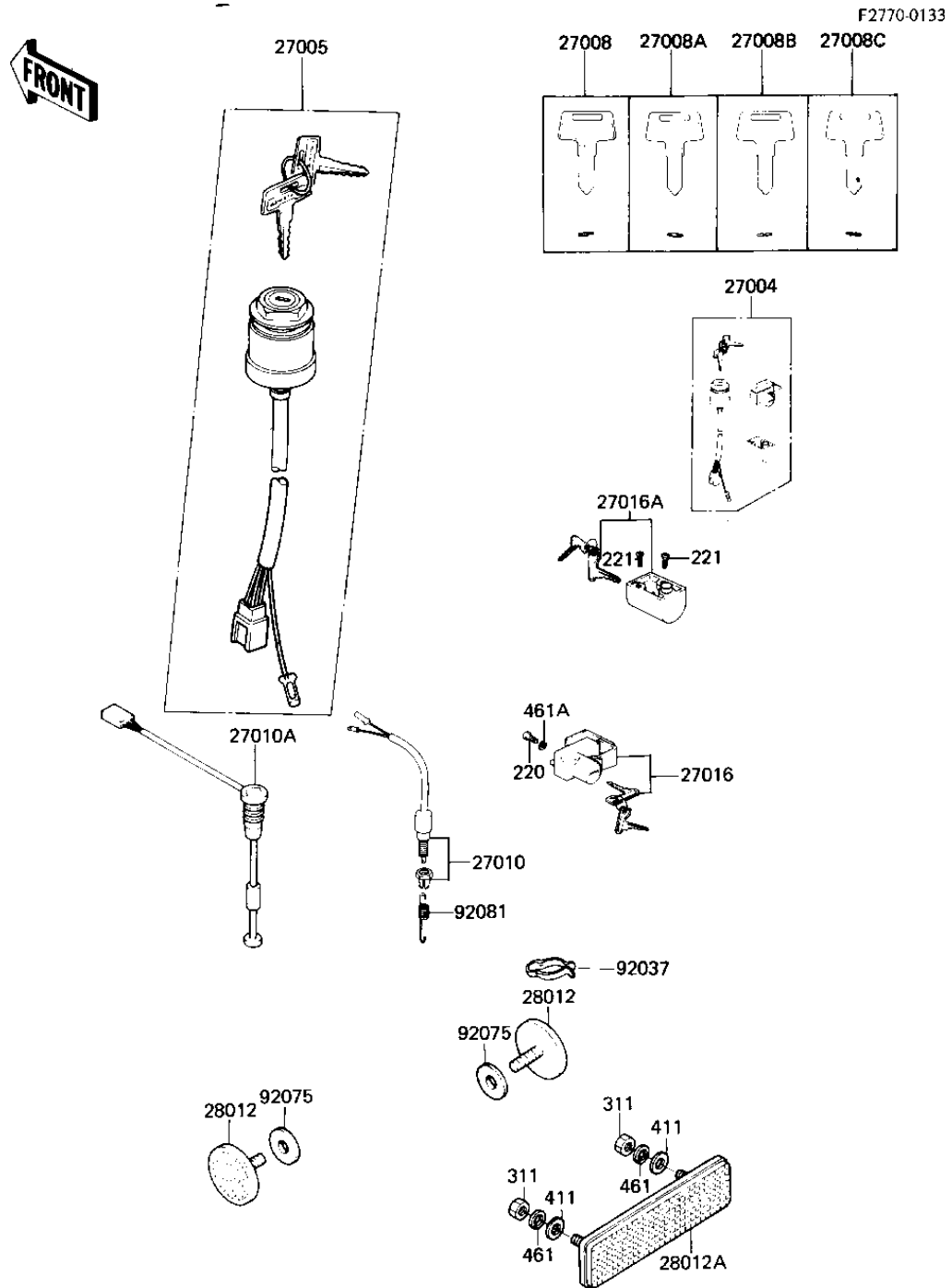

1982 AR80-A1 PARTS LIST

IGNITION SWITCH/LOCKS/REFLECTORS

| ITEM NAME | PART NUMBER | QUANTITY |
|--------------------------------------|-------------|----------|
| SWITCH-ASSY (Ref # 27004) | 27004-5172 | 1 |
| SWITCH-ASSY-IGNITION (Ref # 27005) | 27005-1067 | 1 |
| KEY-LOCK,BLANK (Ref # 27008) | 27008-1041 | 1 |
| KEY-LOCK,BLANK (Ref # 27008A) | 27008-1042 | 1 |
| KEY-LOCK,BLANK (Ref # 27008B) | 27008-1043 | 1 |
| KEY-LOCK,BLANK (Ref # 27008C) | 27008-1044 | 1 |
| SWITCH,BRAKE LIGHT (Ref # 27010) | 27010-025 | 1 |
| SWITCH,OIL LEVEL (Ref # 27010A) | 27010-1049 | 1 |
| LOCK-ASSY,HELMET (Ref # 27016) | 27016-5040 | 1 |
| LOCK-ASSY,STEERING (Ref # 27016A) | 27016-5041 | 1 |
| REFLECTOR,REFLEX (Ref # 28012) | 28012-016 | 2 |
| REFLECTOR,REAR REFLEX (Ref # 28012A) | 28012-1005 | 1 |
| CLAMP,CLUTCH CABLE (Ref # 92037) | 92037-1086 | 1 |
| DAMPER RUBBER,REFLECT (Ref # 92075) | 92094-011 | 2 |
| SPRING BRAKE LAMP SW (Ref # 92081) | 27011-006 | 1 |
| SCREW PAN HEAD 6X10 (Ref # 220) | 220B0610 | 1 |
| SCREW CNTSNK HD 6X10 (Ref # 221) | 221B0610 | 2 |
| NUT,5MM (Ref # 311) | 311B0500 | 2 |
| WASHER PLAIN 5MM (Ref # 411) | 411B0500 | 2 |
| WASHER SPRING 5MM (Ref # 461) | 461F0500 | 2 |
| WASHER SPRING 6MM (Ref # 461A) | 461F0600 | 1 |