

1984 KLT200 PARTS DIAGRAM

BATTERY CASE/TOOL CASE ('84 KLT200-C2)

F 2132-U128

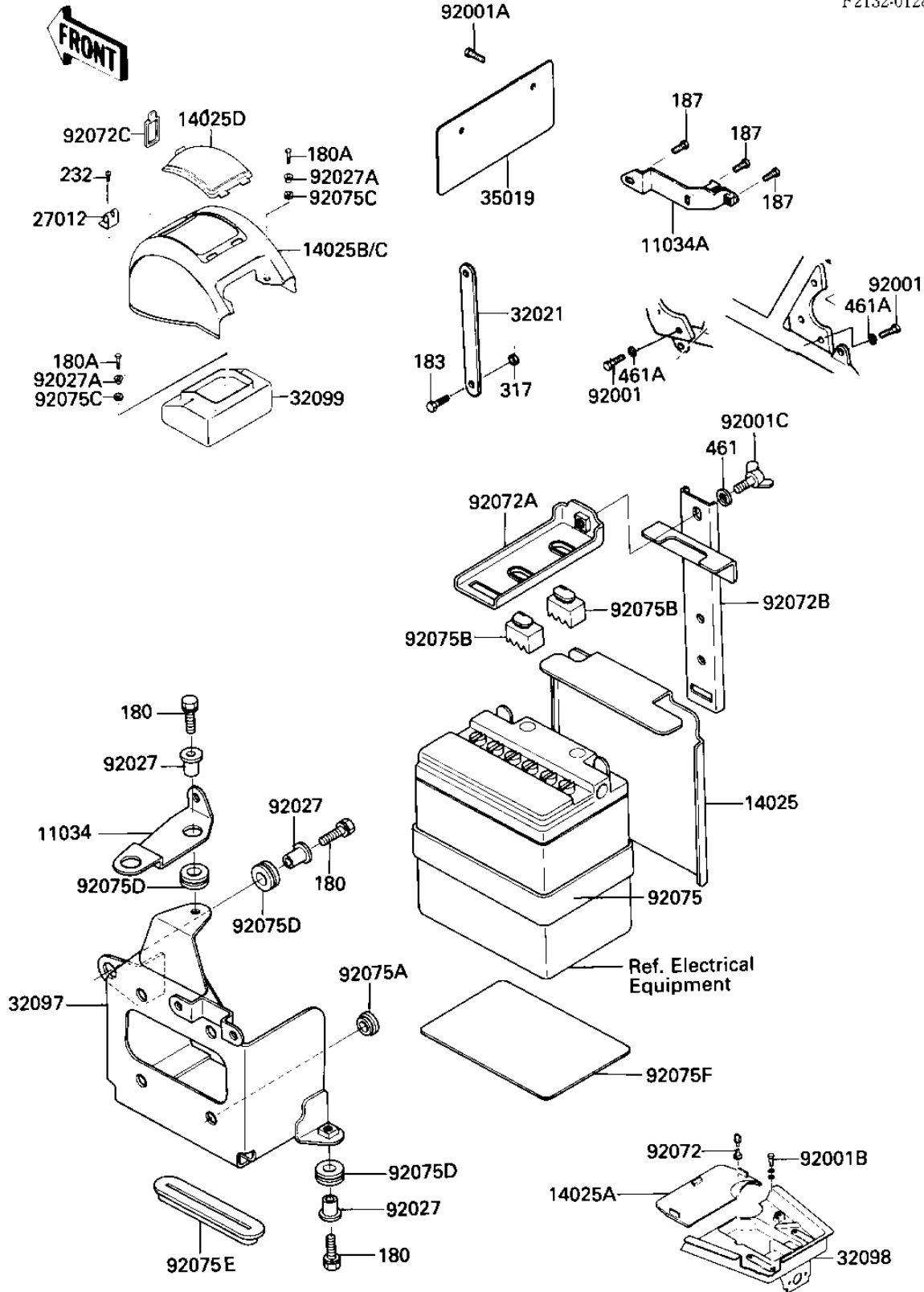

1984 KLT200 PARTS LIST

BATTERY CASE/TOOL CASE ('84 KLT200-C2)

ITEM NAME	PART NUMBER	QUANTITY
BRACKET,BLACK (Ref # 11034)	11034-4202	1
BRACKET,BLACK (Ref # 11034A)	11034-4203	1
COVER (Ref # 14025)	14025-4007	1
COVER-TOOL CASE (Ref # 14025A)	14025-4022	1
COVER,FR,BLACK (Ref # 14025B)	14025-4024-6D	1
COVER,FR,RED (Ref # 14025C)	14025-4024-8S	1
COVER,STORAGE (Ref # 14025D)	14025-4025	1
HOOK,BAND BLACK (Ref # 27012)	27012-4011	1
BRACKET,FRAME (Ref # 32021)	32021-4030	1
CASE-BATTERY (Ref # 32097)	32097-1104	1
CASE,TOOL (Ref # 32098)	32098-4002	1
CASE,TRUNK (Ref # 32099)	32099-4011	1
FLAP (Ref # 35019)	35019-4006	1
BOLT (Ref # 92001)	92001-160	6
BOLT,W/SP,6X16 (Ref # 92001A)	92001-1763	2
BOLT,6X25 (Ref # 92001B)	92002-1137	4
BOLT,CLNR ELEMENT (Ref # 92001C)	92003-199	1
COLLAR (Ref # 92027)	92027-1045	3
COLLAR (Ref # 92027A)	92027-194	4
BAND,HEAD LAMP (Ref # 92072)	92072-077	1
BAND (Ref # 92072A)	92072-1159	1
BAND,BATTERY (Ref # 92072B)	92072-1165	1
BAND (Ref # 92072C)	92072-4008	1
MAT-BATTERY SIDE (Ref # 92075)	32103-023	1
DAMPER RUBBER (Ref # 92075A)	92075-078	6
DAMPER,SEAT (Ref # 92075B)	92075-1007	2
DAMPER RUBBER (Ref # 92075C)	92075-112	4
DAMPER RUBBER (Ref # 92075D)	92075-277	3
DAMPER RUBBER (Ref # 92075E)	92075-280	1

1984 KLT200 PARTS LIST

BATTERY CASE/TOOL CASE ('84 KLT200-C2)

ITEM NAME	PART NUMBER	QUANTITY
DAMPER,BATTERY CASE (Ref # 92075F)	92075-4019	1
BOLT-UPSET-WS (Ref # 180)	180B0620	3
BOLT-UPSET-WS,6X25 (Ref # 180A)	180B0625	4
BOLT-UPSET-WS-SMALL (Ref # 183)	183B0818	1
BOLT 6X14 (Ref # 187)	187B0614	3
SCREW-PAN-WS+- (Ref # 232)	232B0614	1
NUT,8M/M (Ref # 317)	317B0800	1
WASHER SPRING 6MM (Ref # 461)	461F0600	1
WASHER SPRING 10MM (Ref # 461A)	461F1000	6