

# 1983 LTD Belt PARTS DIAGRAM

METERS

F2530-0228

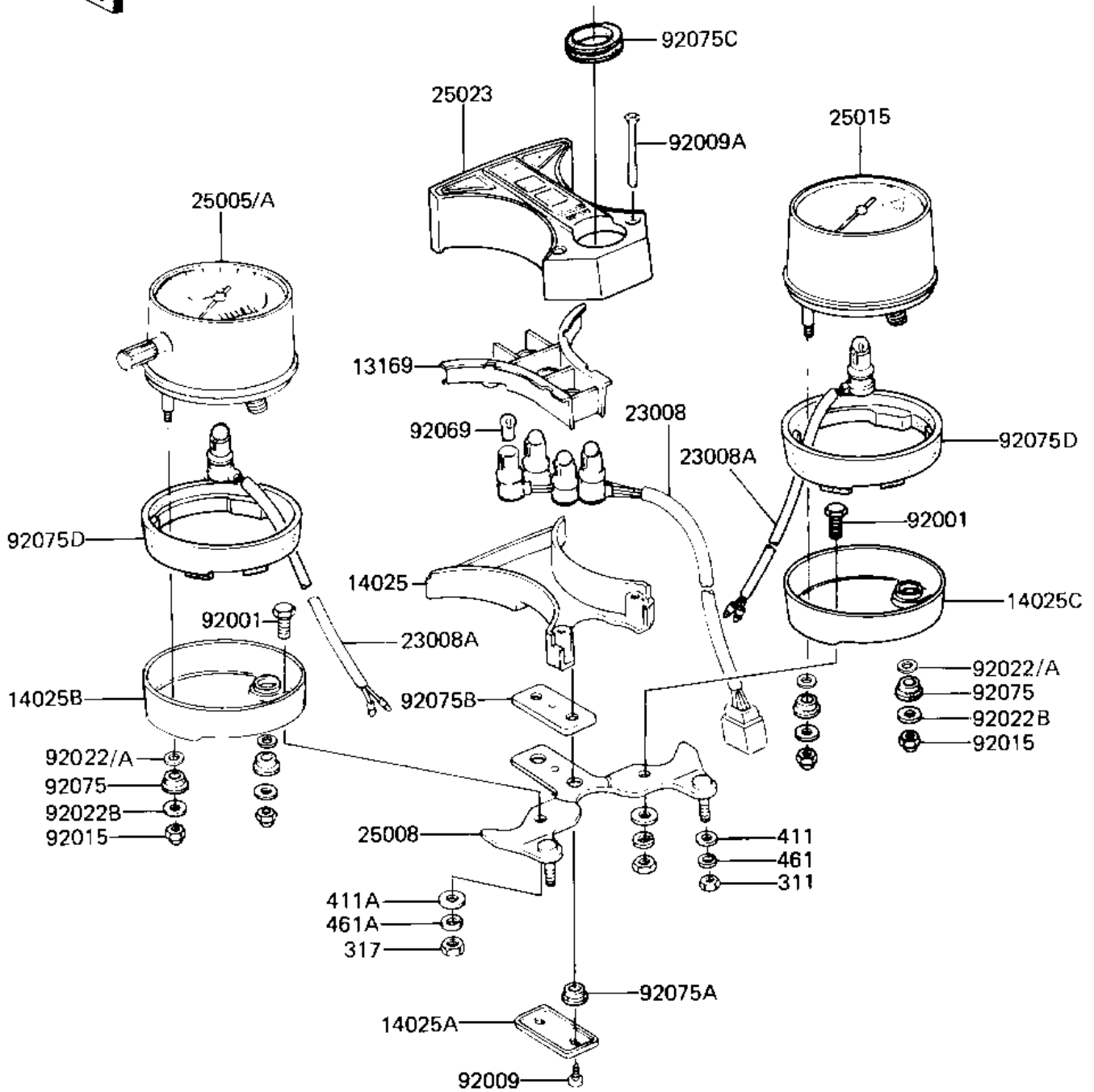

# 1983 LTD Belt PARTS LIST

## METERS

ITEM NAME	PART NUMBER	QUANTITY
PLATE,SOCKET (Ref # 13169)	13169-1133	1
COVER,PILOT BOX,LOWER (Ref # 14025)	14025-1093	1
COVER,PILOT BOX DAMPR (Ref # 14025A)	14025-1096	1
COVER,SPEEDOMETER (Ref # 14025B)	14025-1322	1
COVER,TACHOMETER (Ref # 14025C)	14025-1323	1
SOCKET-ASSY (Ref # 23008)	23008-1119	1
SOCKET-ASSY,SPEEDOMET (Ref # 23008A)	23008-1158	2
SPEEDOMETER,MPH (Ref # 25005)	25005-1223	1
SPEEDOMETER,KPH (Canada) (Ref # 25005A)	25005-1224	1
BRACKET,METER (Ref # 25008)	25008-1021	1
TACHOMETER,X1000R/MIN (Ref # 25015)	25015-1131	1
COVER,PILOT BOX,UPPER (Ref # 25023)	25023-1008	1
BOLT,METER,8X16 (Ref # 92001)	92001-1154	2
SCREW,TAPPING,4X10 (Ref # 92009)	92009-1040	2
SCREW-CSK-RD-CROS,4X4 (Ref # 92009A)	222C0445	2
NUT-CAP,5MM (Ref # 92015)	322N0500	4
WASHER,METER,LWR (Ref # 92022)	92022-1412	4
WASHER,METER,LWR (Ref # 92022A)	92022-1412	4
WASHER PL 5.2X18X1.2 (Ref # 92022B)	92022-285	4
BULB,12V3.4W (Ref # 92069)	92069-1007	6
DAMPER RUBBER-METER (Ref # 92075)	25019-013	4
DAMPER RUBBER,MET FIT (Ref # 92075A)	25019-023	2
DAMPER,PILOT BOX (Ref # 92075B)	92075-1136	1
DAMPER,PILOT BOX (Ref # 92075C)	92075-1204	1
DAMPER,METER (Ref # 92075D)	92075-1498	2
NUT 6MM (Ref # 311)	311B0600	2
NUT,8M/M (Ref # 317)	317B0800	2
WASHER PLAIN 6MM (Ref # 411)	411B0600	2
WASHER PLAIN 8MM (Ref # 411A)	411B0800	2

# 1983 LTD Belt PARTS LIST

METERS

ITEM NAME	PART NUMBER	QUANTITY
WASHER SPRING 6MM (Ref # 461)	461F0600	2
WASHER SPRING 8MM (Ref # 461A)	461F0800	2