

1983 KX500 PARTS DIAGRAM

FRAME FITTINGS ('83 A1)

F2131-0122

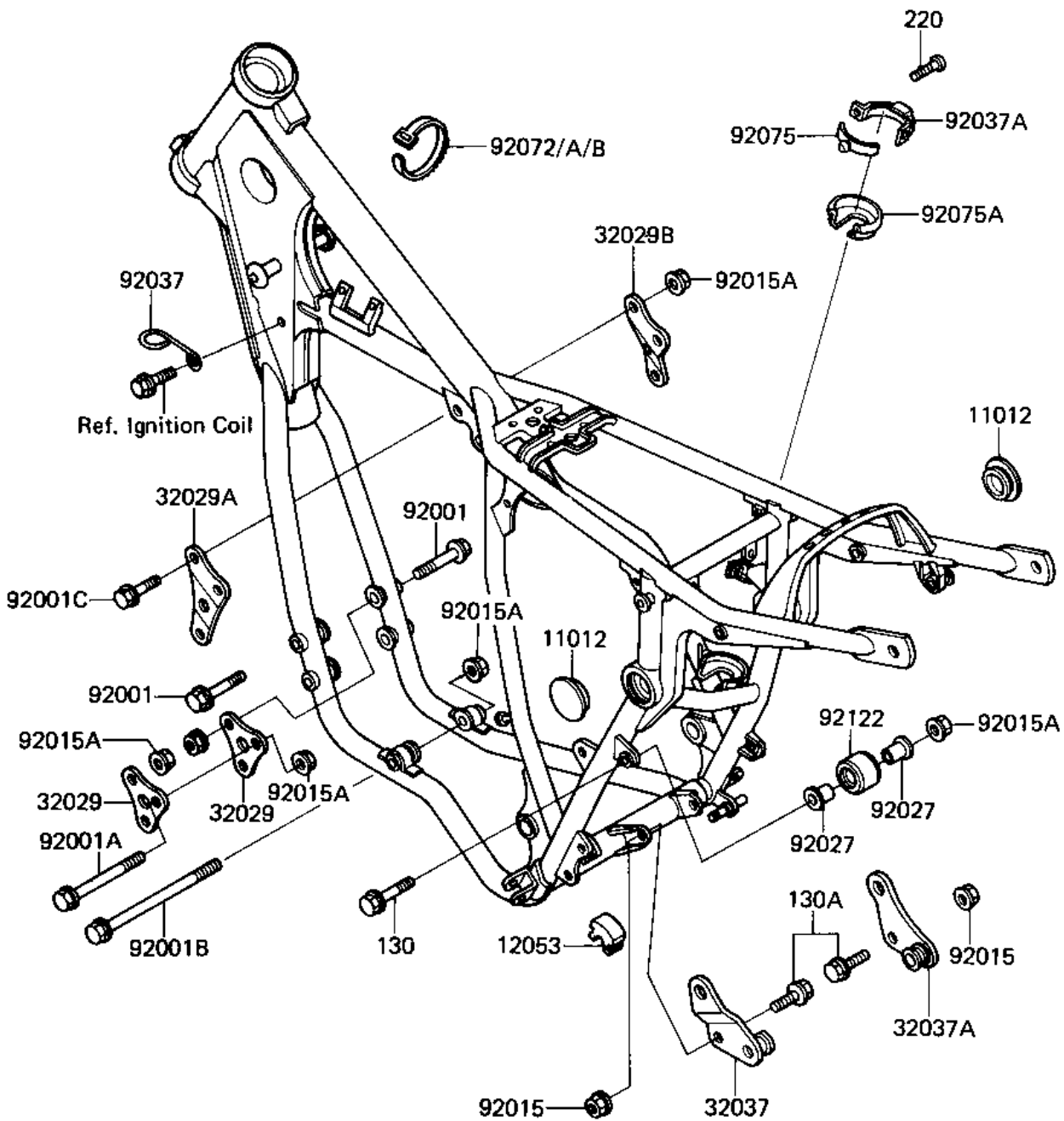

1983 KX500 PARTS LIST

FRAME FITTINGS ('83 A1)

ITEM NAME	PART NUMBER	QUANTITY
CAP,UNI TRAK (Ref # 11012)	11012-1211	2
GUIDE-CHAIN,FR,LWR (Ref # 12053)	12053-1088	1
BRACKET-ENGINE,FR (Ref # 32029)	32029-1203	2
BRACKET-ENGINE,UPP,LH (Ref # 32029A)	32029-1204	1
BRACKET-ENGINE,UPP,RH (Ref # 32029B)	32029-1205	1
BRACKET-SHOCKABSORBER (Ref # 32037)	32037-1230	1
BRACKET-SHOCKABSORBER (Ref # 32037A)	32037-1231	1
BOLT,8X57 (Ref # 92001)	92001-1493	4
BOLT,FLANGED,8X95 (Ref # 92001A)	92001-1689	1
BOLT,FLANGED,8X160 (Ref # 92001B)	92001-1690	1
BOLT,FLANGED,8X25 (Ref # 92001C)	92001-1691	2
NUT,10MM (Ref # 92015)	92015-1415	2
NUT-8MM (Ref # 92015A)	92015-1143	9
COLLAR,CHAIN GUIDE (Ref # 92027)	92027-1383	2
CLAMP,CABLE (Ref # 92037)	92037-1148	1
CLAMP,RESERVE TANK,UP (Ref # 92037A)	92037-1375	1
BAND,SHORT (Ref # 92072)	92072-030	2
BAND,MIDDLE (Ref # 92072A)	92072-031	2
BAND,LONG (Ref # 92072B)	92072-032	1
DAMPER,RESERVE TANK,U (Ref # 92075)	92075-1431	1
DAMPER,RESERVE TANK,L (Ref # 92075A)	92075-1432	1
ROLLER,CHAIN GUIDE (Ref # 92122)	92122-1021	1
BOLT,FLANGED,8X50 (Ref # 130)	130G0850	1
BOLT-FLANGED,10X20 (Ref # 130A)	130P1020	2
SCREW PAN HEAD 6X12 (Ref # 220)	220B0612	1