

# 1983 Spectre PARTS DIAGRAM

## FRONT MASTER CYLINDER

F2291-0091

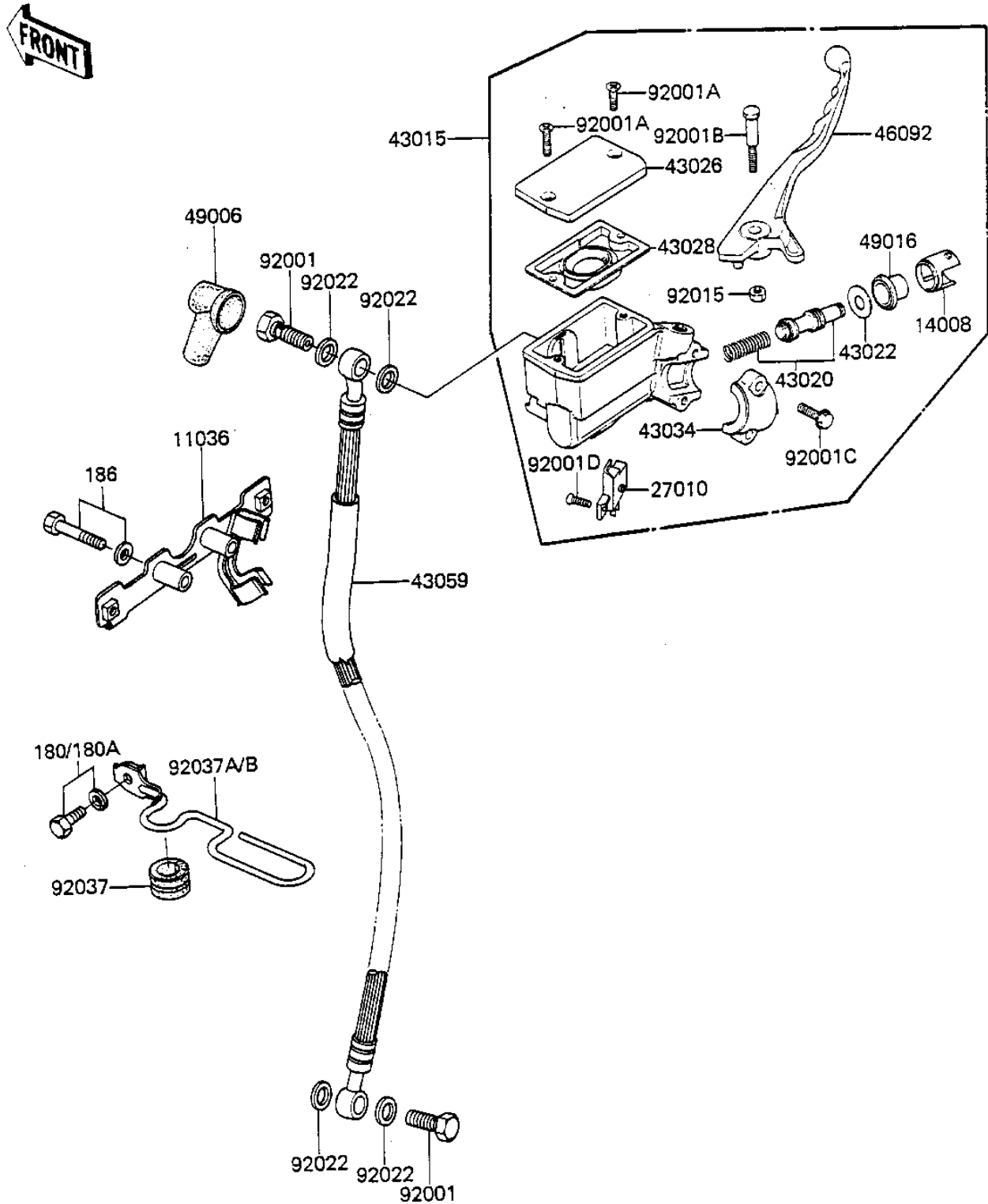

# 1983 Spectre PARTS LIST

## FRONT MASTER CYLINDER

ITEM NAME	PART NUMBER	QUANTITY
BRACKET-A,FORK COVER (Ref # 11036)	11036-1517	1
LINER,PISTON (Ref # 14008)	14008-1035	1
SWITCH,BRAKE (Ref # 27010)	27010-1056	1
CYLINDER-ASSY-MASTER, (Ref # 43015)	43015-1136	1
PISTON-COMP-BRAKE (Ref # 43020)	43020-1033	1
STOPPER-BRAKE,PISTON (Ref # 43022)	43022-1009	1
CAP-BRAKE,FRONT (Ref # 43026)	43026-1017	1
DIAPHRAGM,MASTER CYL1 (Ref # 43028)	43028-1029	1
HOLDER,MASTER CYLINDR (Ref # 43034)	43034-1001	1
HOSE-BRAKE,FR,L=1080 (Ref # 43059)	43059-1199	1
LEVER-GRIP,FRONT BRAK (Ref # 46092)	46092-1027	1
BOOT,DUST (Ref # 49006)	49006-1041	1
COVER-SEAL,BRK PISTON (Ref # 49016)	49016-1041	1
BOLT,OIL,L=23 (Ref # 92001)	92002-1888	2
SCREW,COUNTERSUNK HED (Ref # 92001A)	92001-1055	2
BOLT,6X37.3,BLACK (Ref # 92001B)	92001-1512	1
BOLT,W/WASHER,6X25,BL (Ref # 92001C)	92001-1513	2
SCREW-COUNTERSUNK (Ref # 92001D)	92001-1532	1
NUT,LOCK,6MM,BLACK (Ref # 92015)	92015-1191	1
WASHER-OIL BOLT (Ref # 92022)	43067-001	4
DAMPER RUBBER,CYL HSE (Ref # 92037)	43064-006	1
CLAMP,CABLE,BLACK (Ref # 92037B)	92037-1335	1
BOLT-UPSET-WS (Ref # 180A)	180C0612	1
BOLT 6X35 (Ref # 186)	186B0635	2