

1983 LTD Belt PARTS DIAGRAM

FRAME FITTINGS

F2131-0135

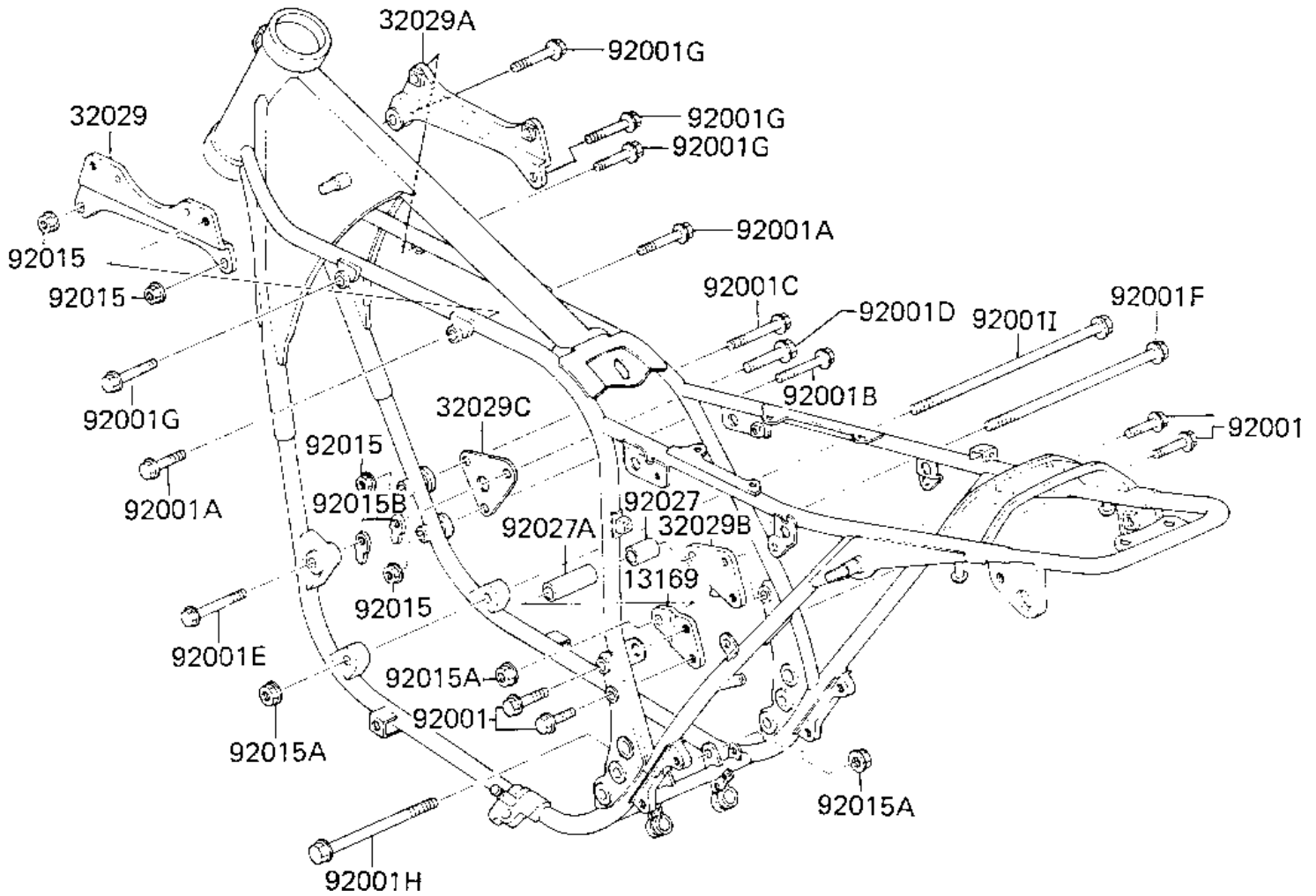

1983 LTD Belt PARTS LIST

FRAME FITTINGS

ITEM NAME	PART NUMBER	QUANTITY
PLATE,REAR ENG MOUNT (Ref # 13169)	13169-1048	1
BRACKET-ENGINE (Ref # 32029)	32029-1167	1
BRACKET-ENGINE (Ref # 32029A)	32029-1168	1
BRACKET-ENGINE,RR,RH (Ref # 32029B)	32029-1220	1
PLATE,ENG FIT,FRONT (Ref # 32029C)	32030-047	1
BOLT,FLANGED,8X35 (Ref # 92001)	92001-1577	4
BOLT,FLANGED,8X45 (Ref # 92001A)	92001-1579	2
BOLT,FLANGED,8X60 (Ref # 92001B)	92001-1581	1
BOLT FLANGED,8X70 (Ref # 92001C)	92001-1583	1
BOLT,10X50 (Ref # 92001D)	92001-1584	1
BOLT,FLANGED,10X70 (Ref # 92001E)	92001-1618	1
BOLT,FLANGED,10X255 (Ref # 92001F)	92001-1609	1
BOLT (Ref # 92001G)	92001-1639	4
BOLT,FLANGED,10X160 (Ref # 92001H)	92001-1653	1
BOLT,FLANGED,10X325 (Ref # 92001I)	92001-1654	1
NUT,8M/M (Ref # 92015)	92015-1014	4
NUT,FLANGED,10MM (Ref # 92015A)	92015-1428	3
NUT (Ref # 92015B)	92016-055	2
COLLAR,12.2X22X30.5 (Ref # 92027)	92027-1478	1
COLLAR,12.2X22X62 (Ref # 92027A)	92027-1521	1