

1985 LTD PARTS DIAGRAM

STARTER MOTOR/STARTER CLUTCH

E1840-0069

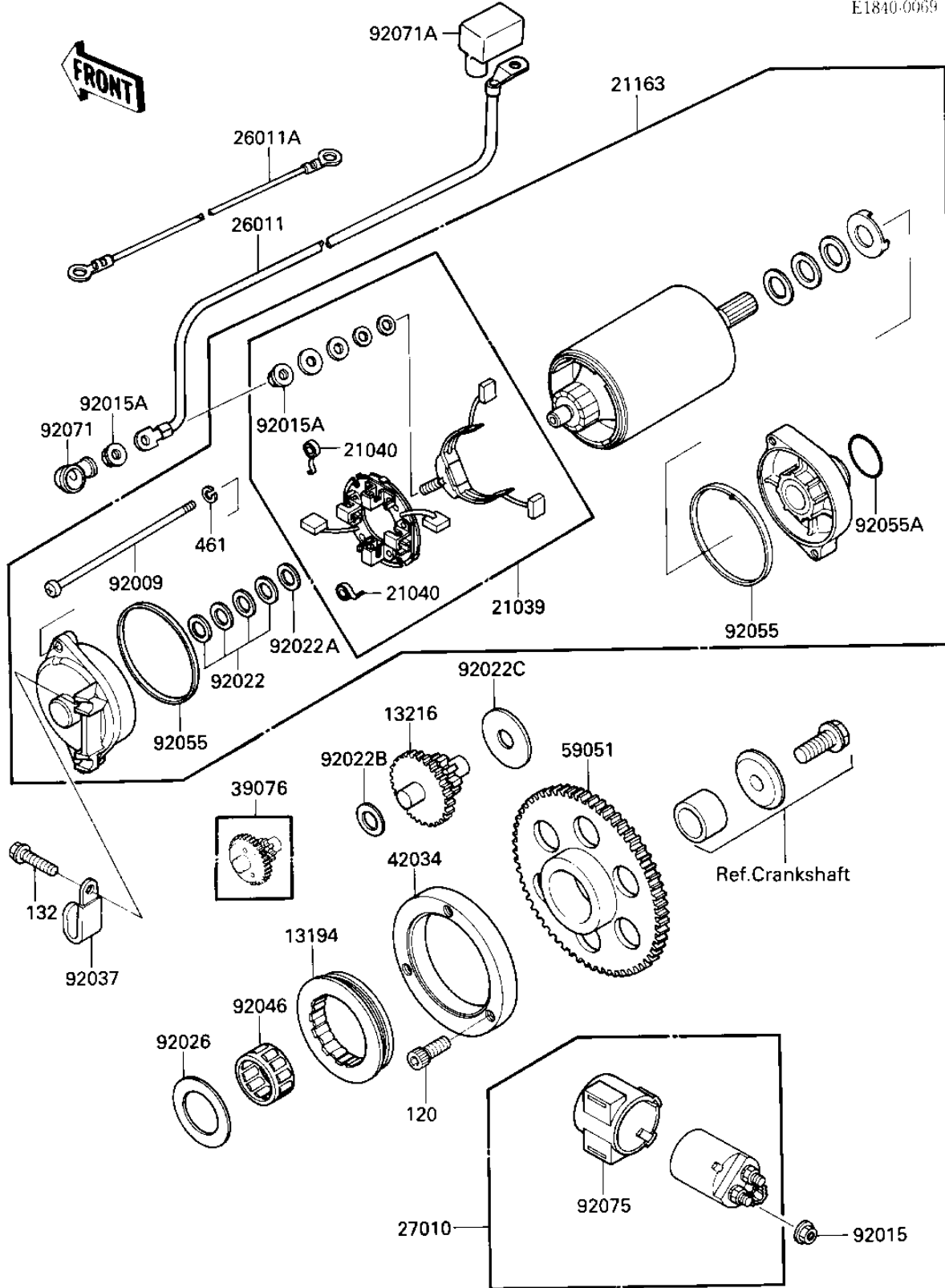

1985 LTD PARTS LIST

STARTER MOTOR/STARTER CLUTCH

ITEM NAME	PART NUMBER	QUANTITY
CLUTCH-ONEWAY (Ref # 13194)	13194-1062	1
39076-1051 (Canada) (Ref # 13216)	13216-1082	1
BRUSH,CARBON (Ref # 21039)	21039-1053	1
SPRING-BRUSH (Ref # 21040)	21040-1003	4
STARTER-ELECTRIC (Ref # 21163)	21163-1068	1
WIRE-LEAD,STARTER MOT (Ref # 26011)	26011-1276	1
WIRE-LEAD,BATTERY GRO (Ref # 26011A)	26011-1320	1
SWITCH,MAGNETIC (Ref # 27010)	27010-1235	1
LIMITER,IDLE GEAR (Ref # 39076)	39076-1051	1
COUPLING (Ref # 42034)	42034-1081	1
GEAR-SPUR,STARTER,63T (Ref # 59051)	59051-1130	1
SCREW (Ref # 92009)	92009-1369	2
NUT-6MM (Ref # 92015)	92015-1078	2
NUT,6MM (Ref # 92015A)	92015-1476	2
WASHER,THRUST,0.2T (Ref # 92022)	21025-011	4
WASHER,THRUST,0.8T (Ref # 92022A)	92022-1132	1
WASHER (Ref # 92022B)	92022-1611	1
WASHER,12.3X38X2.0 (Ref # 92022C)	92022-1664	1
SPACER,CONNECTING ROD (Ref # 92026)	92026-087	1
CLAMP,WIRING HARNESS (Ref # 92037)	92037-1539	1
BEARING-NEEDLE (Ref # 92046)	92046-1137	1
"O" RING,STARTER MOTR (Ref # 92055)	92055-1086	2
RING-O (Ref # 92055A)	92055-1276	1
GROMMET,CORD (Ref # 92071)	21017-017	1
GROMMET,TERMINAL (Ref # 92071A)	92071-1130	1
DAMPER MAG SWITCH SHK (Ref # 92075)	21064-002	1
BOLT-SOCKET,8X20 (Ref # 120)	120S0820	3
BOLT-FLANGED-SMALL (Ref # 132)	132J0625	2
WASHER SPRING 5MM (Ref # 461)	461F0500	2