

1985 LTD PARTS DIAGRAM

FUEL TANK

F2410-0296

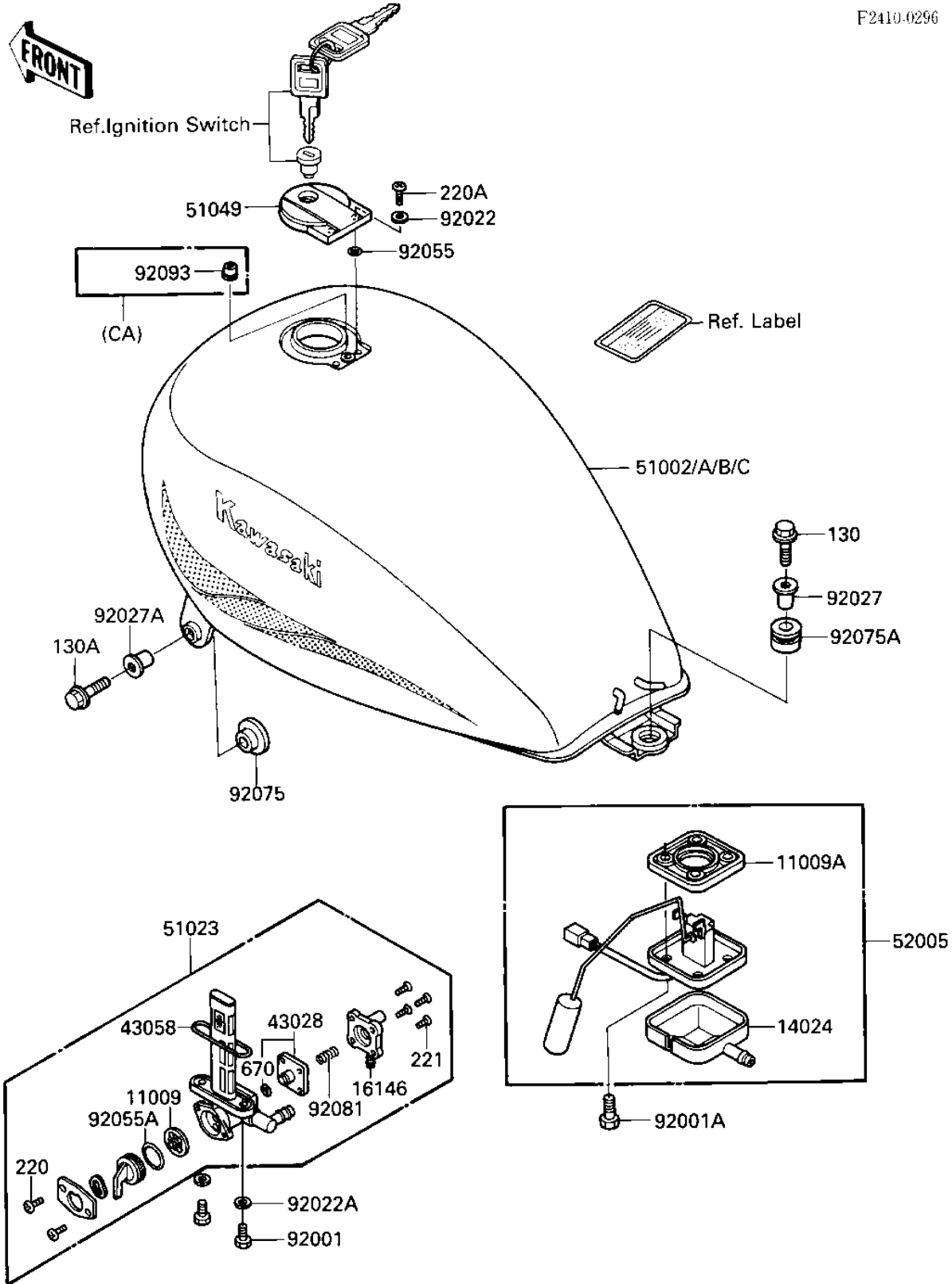

1985 LTD PARTS LIST

FUEL TANK

ITEM NAME	PART NUMBER	QUANTITY
GASKET,FUEL TAP (Ref # 11009)	11009-1188	1
GASKET,FUEL GAUGE (Ref # 11009A)	11009-1656	1
COVER,FUEL GAGE (Ref # 14024)	14025-1536	1
COVER-ASSY,TAP DIAPHR (Ref # 16146)	16146-1010	1
DIAPHRAGM (Ref # 43028)	43028-1033	1
"O" RING (Ref # 43058)	51039-003	1
TANK-COMP-FUEL,EBONY (Ref # 51002)	51002-5059-H8	1
TANK-COMP-FUEL,L.V.RE (Ref # 51002A)	51002-5063-P5	1
TANK-COMP-FUEL,EBONY (Ref # 51002B)	51002-5066-H8	1
TANK-COMP-FUEL,L.V.RE (Ref # 51002C)	51002-5067-P5	1
TAP-ASSY,FUEL (Ref # 51023)	51023-1113	1
CAP-TANK,FUEL (Ref # 51049)	51049-1083	1
GAUGE,FUEL (Ref # 52005)	52005-1070	1
BOLT,6X20,FUEL TAP (Ref # 92001)	92001-1091	2
BOLT,FUEL GAGE (Ref # 92001A)	92001-1705	4
WASHER,PLAIN (Ref # 92022)	92022-1038	2
WASHER-PLAIN (Ref # 92022A)	92022-183	2
COLLAR,L=19.3 (Ref # 92027)	92027-1780	1
COLLAR (Ref # 92027A)	92027-1929	2
"O" RING (Ref # 92055)	92055-1023	2
"O" RING,FUEL TAP LEV (Ref # 92055A)	92055-1085	1
DAMPER,FUEL TANK (Ref # 92075)	92075-1677	2
DAMPER (Ref # 92075A)	92075-1736	1
SPRING,DIAPHRAGM VALV (Ref # 92081)	92081-1240	1
OIL SEAL,FUEL TANK (Ref # 92093)	92093-1030	1
BOLT-FLANGED 8X30 (Ref # 130)	130B0830	1
BOLT-FLANGED,8X25 (Ref # 130A)	130C0825	2
SCREW PAN HEAD 3X8 (Ref # 220)	220B0308	2
SCREW PAN HEAD 5X10 (Ref # 220A)	220B0510	2

1985 LTD PARTS LIST

FUEL TANK

ITEM NAME	PART NUMBER	QUANTITY
SCREW-CSK-CROS,4X14 (Ref # 221)	221B0414	4
"O" RING,4MM (Ref # 670)	670B1504	1