

1985 Eliminator PARTS DIAGRAM

TRANSMISSION

E1361-0159

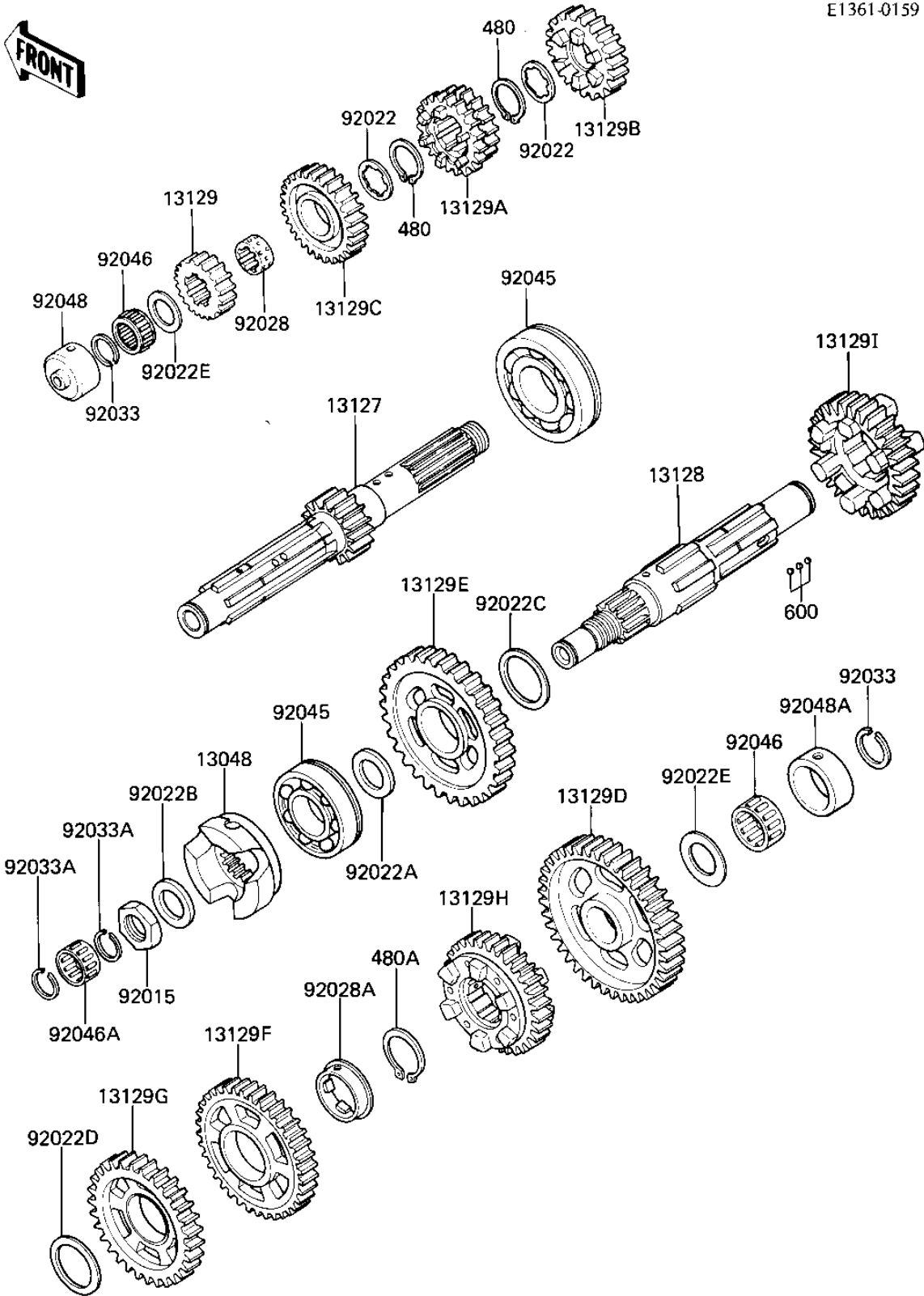

1985 Eliminator PARTS LIST

TRANSMISSION

| ITEM NAME | PART NUMBER | QUANTITY |
|--------------------------------------|-------------|----------|
| CAM-DAMPER (Ref # 13048) | 13048-1060 | 1 |
| SHAFT-TRANSMISSION IN (Ref # 13127) | 13127-1196 | 1 |
| SHAFT-TRANSMISSION OU (Ref # 13128) | 13128-1138 | 1 |
| GEAR,INPUT 2ND,19T (Ref # 13129) | 13129-1530 | 1 |
| GEAR,INPUT 3RD&4TH,22 (Ref # 13129A) | 13129-1531 | 1 |
| GEAR,INPUT 5TH,26T (Ref # 13129B) | 13129-1532 | 1 |
| GEAR,INPUT TOP,28T (Ref # 13129C) | 13129-1533 | 1 |
| GEAR,OUTPUT LOW,42T (Ref # 13129D) | 13129-1534 | 1 |
| GEAR,OUTPUT 2ND,38T (Ref # 13129E) | 13129-1700 | 1 |
| GEAR,OUTPUT 3RD,35T (Ref # 13129F) | 13129-1701 | 1 |
| GEAR,OUTPUT 4TH,32T (Ref # 13129G) | 13129-1702 | 1 |
| GEAR,OUTPUT 5TH,30T (Ref # 13129H) | 13129-1703 | 1 |
| GEAR,OUTPUT TOP,29T (Ref # 13129I) | 13129-1704 | 1 |
| NUT 20MM (Ref # 92015) | 92016-028 | 1 |
| WASHER,LOCK (O.D=35) (Ref # 92022) | 92022-1077 | 2 |
| WASHER,28.3X42X2.9 (Ref # 92022A) | 92022-1219 | 1 |
| WASHER,20.3X32X4.5 (Ref # 92022B) | 92022-1692 | 1 |
| WASHER,32X40X1.6 (Ref # 92022C) | 92022-1693 | 1 |
| WASHER,30X38X2.0 (Ref # 92022D) | 92022-1694 | 1 |
| WASHER,PLAIN,22MM (Ref # 92022E) | 92022-212 | 2 |
| BUSHING,TOP GEAR (Ref # 92028) | 92028-1124 | 1 |
| BUSHING,OUTPUT 3RD GE (Ref # 92028A) | 92028-1374 | 1 |
| CIRCLIP,25MM (Ref # 92033) | 92033-025 | 2 |
| CIRCLIP (Ref # 92033A) | 92033-028 | 2 |
| BEARING-BALL (Ref # 92045) | 92045-1186 | 2 |
| BEARING,PK223013.8 (Ref # 92046) | 92046-031 | 2 |
| BEARING-NEEDLE,K17X23 (Ref # 92046A) | 92046-1145 | 1 |
| RACE,INPUT SHAFT (Ref # 92048) | 92048-1052 | 1 |
| RACE,30X38X15 (Ref # 92048A) | 92048-1053 | 1 |

1985 Eliminator PARTS LIST

TRANSMISSION

| ITEM NAME | PART NUMBER | QUANTITY |
|------------------------------|-------------|----------|
| CIRCLIP 28MM (Ref # 480) | 480J2800 | 2 |
| CIRCLIP (Ref # 480A) | 480J2900 | 1 |
| BALL STEEL 5/32' (Ref # 600) | 600A0500 | 3 |