

1986 Eliminator PARTS DIAGRAM

FRONT MASTER CYLINDER

F2291-0156

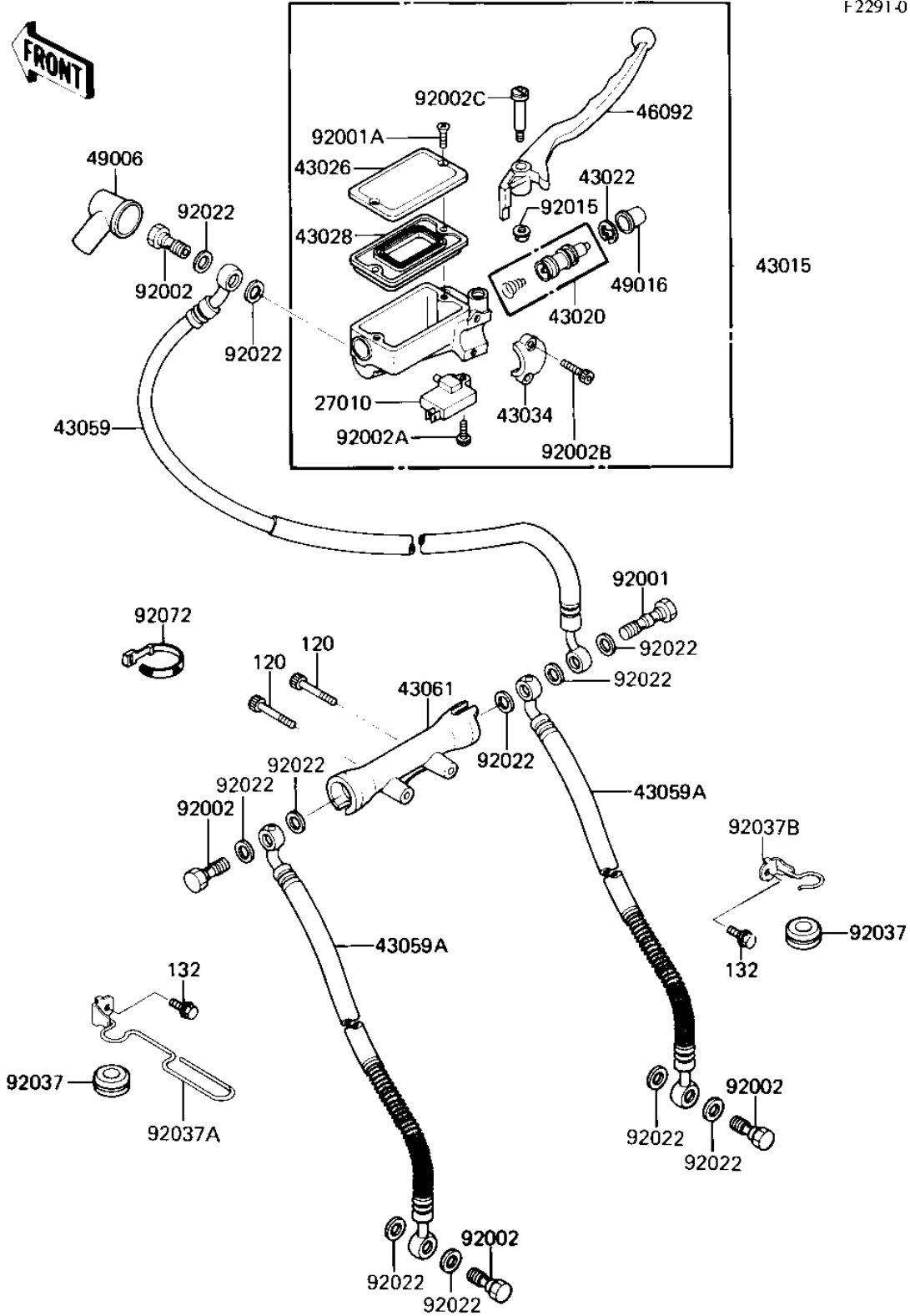

1986 Eliminator PARTS LIST

FRONT MASTER CYLINDER

ITEM NAME	PART NUMBER	QUANTITY
SWITCH,BRAKE (Ref # 27010)	27010-1170	1
CYLINDER-ASSY-MASTER, (Ref # 43015)	43015-1293	1
PISTON-COMP-BRAKE,FR (Ref # 43020)	43020-1054	1
STOPPER-BRAKE,PISTON (Ref # 43022)	43022-1010	1
CAP-BRAKE,FR (Ref # 43026)	43026-1052	1
DIAPHRAGM,MASTER CYLI (Ref # 43028)	43028-1058	1
HOLDER-BRAKE,MASTER C (Ref # 43034)	43034-1053	1
HOSE-BRAKE (Ref # 43059)	43059-1305	1
HOSE-BRAKE (Ref # 43059A)	43059-1306	2
JOINT-BRAKE (Ref # 43061)	43061-1056	1
LEVER-GRIP,FRONT BRAK (Ref # 46092)	46092-1121	1
BOOT,DUST (Ref # 49006)	49006-1041	1
COVER-SEAL,MASTER CYL (Ref # 49016)	49016-1044	1
BOLT (Ref # 92001)	92002-1909	1
BOLT,MASTER CYLINDER (Ref # 92001A)	92001-1727	2
BOLT,OIL,L=23 (Ref # 92002)	92002-1888	4
BOLT (Ref # 92002A)	92002-1323	1
BOLT,SOCKET,6X10 (Ref # 92002B)	92002-1324	1
BOLT,LEVER SET (Ref # 92002C)	92002-1561	1
NUT,FLANGED,6MM (Ref # 92015)	92015-1528	1
WASHER-OIL BOLT (Ref # 92022)	43067-001	11
DAMPER RUBBER,CYL HSE (Ref # 92037)	43064-006	2
CLAMP,BRAKE HOSE,LH (Ref # 92037A)	92037-1702	1
CLAMP,BRAKE HOSE,RH (Ref # 92037B)	92037-1703	1
BAND,WIRING HARNESS (Ref # 92072)	92072-056	1
BOLT,SOCKET,6X45 (Ref # 120)	120P0645	2
BOLT-FLANGED-SMALL (Ref # 132)	132E0612	2