

1983 KDX200 PARTS DIAGRAM

CRANKCASE

E1411-0096

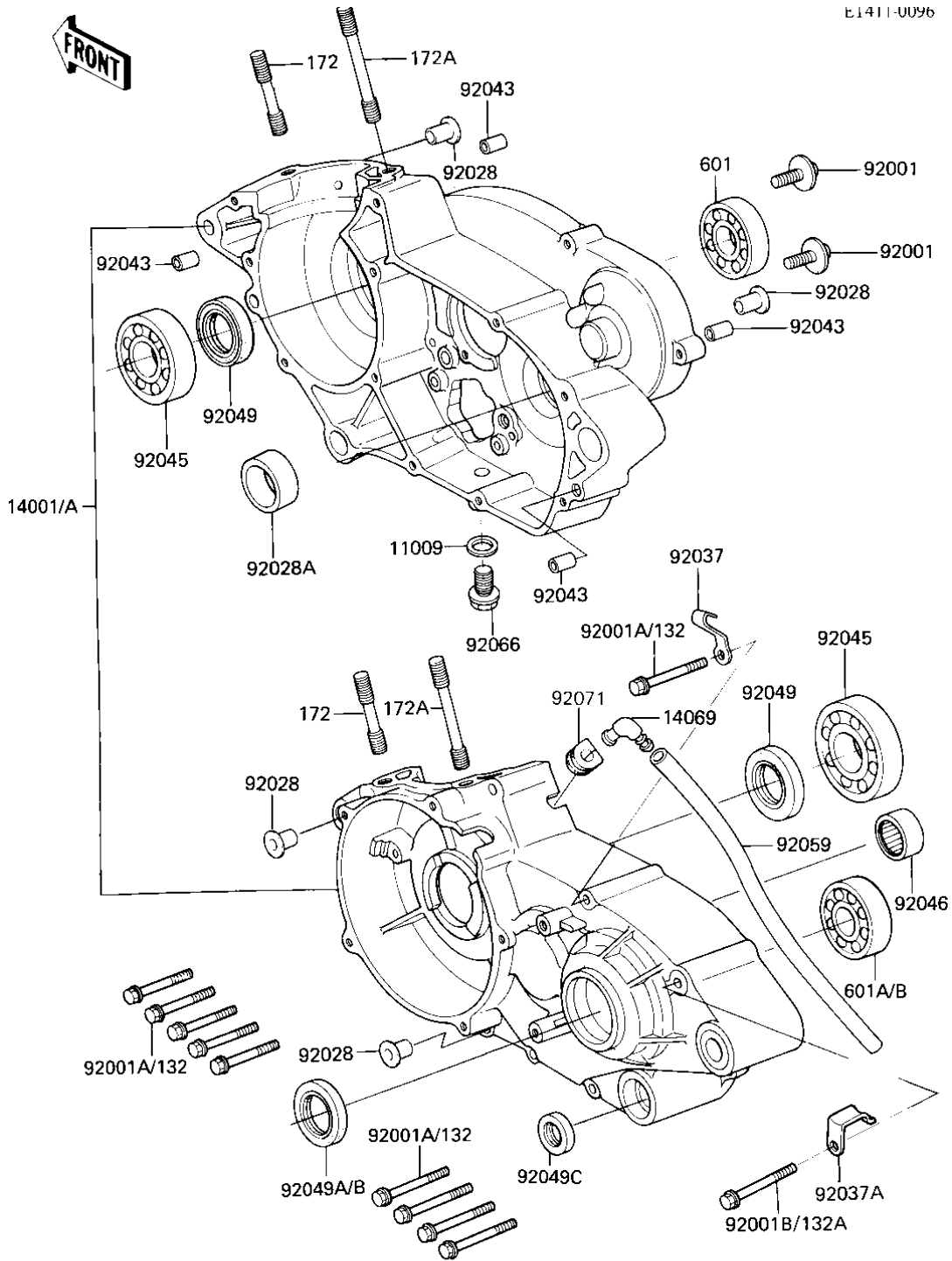

1983 KDX200 PARTS LIST

CRANKCASE

ITEM NAME	PART NUMBER	QUANTITY
GASKET CHECK VALVE (Ref # 11009)	92065-058	1
SET-CRANKCASE (Ref # 14001)	14001-5140	1
BREATHER ASSY (Ref # 14069)	14069-1001	1
BOLT,CLUTCH SPR FITT (Ref # 92001)	92001-1066	2
BOLT-FLANGED-SMALL (Ref # 92001A)	132G0640	10
BOLT-FLANGED-SMALL (Ref # 92001B)	132G0660	1
BUSHING,CRANKCASE (Ref # 92028)	92028-1133	4
BUSHING (Ref # 92028A)	92028-132	1
CLAMP CABLE (Ref # 92037)	92037-016	1
CLAMP,HARNESS (Ref # 92037A)	92037-1318	1
PIN-DOWEL (Ref # 92043)	92042-007	4
BEARING,BALL,#6305SH2 (Ref # 92045)	92045-1024	2
BEARING-NEEDLE (Ref # 92046)	92046-026	1
SEAL-OIL,TBJ25407 (Ref # 92049)	92049-1068	2
OIL SEAL SC25376 (Ref # 92049A)	92050-013	1
OIL SEAL,TB13225.5 (Ref # 92049C)	92051-005	1
TUBE,6X9X500 (Ref # 92059)	92059-1125	1
PLUG OIL DRAIN (Ref # 92066)	92067-001	1
GROMMET, BREATHER (Ref # 92071)	92071-042	1
BOLT-FLANGED-SMALL (Ref # 132)	132G0640	10
BOLT-FLANGED-SMALL (Ref # 132A)	132G0660	1
STUD,8X25 (Ref # 172)	92004-1008	2
STUD 8X60 (Ref # 172A)	172G0860	2
BEARING BALL #6204 (Ref # 601)	601B6204	1
BEARING BALL #6304 (Ref # 601B)	601B6304	1