

# 1985 Ninja<sup>®</sup> PARTS DIAGRAM

## FRONT MASTER CYLINDER

F2291-0142

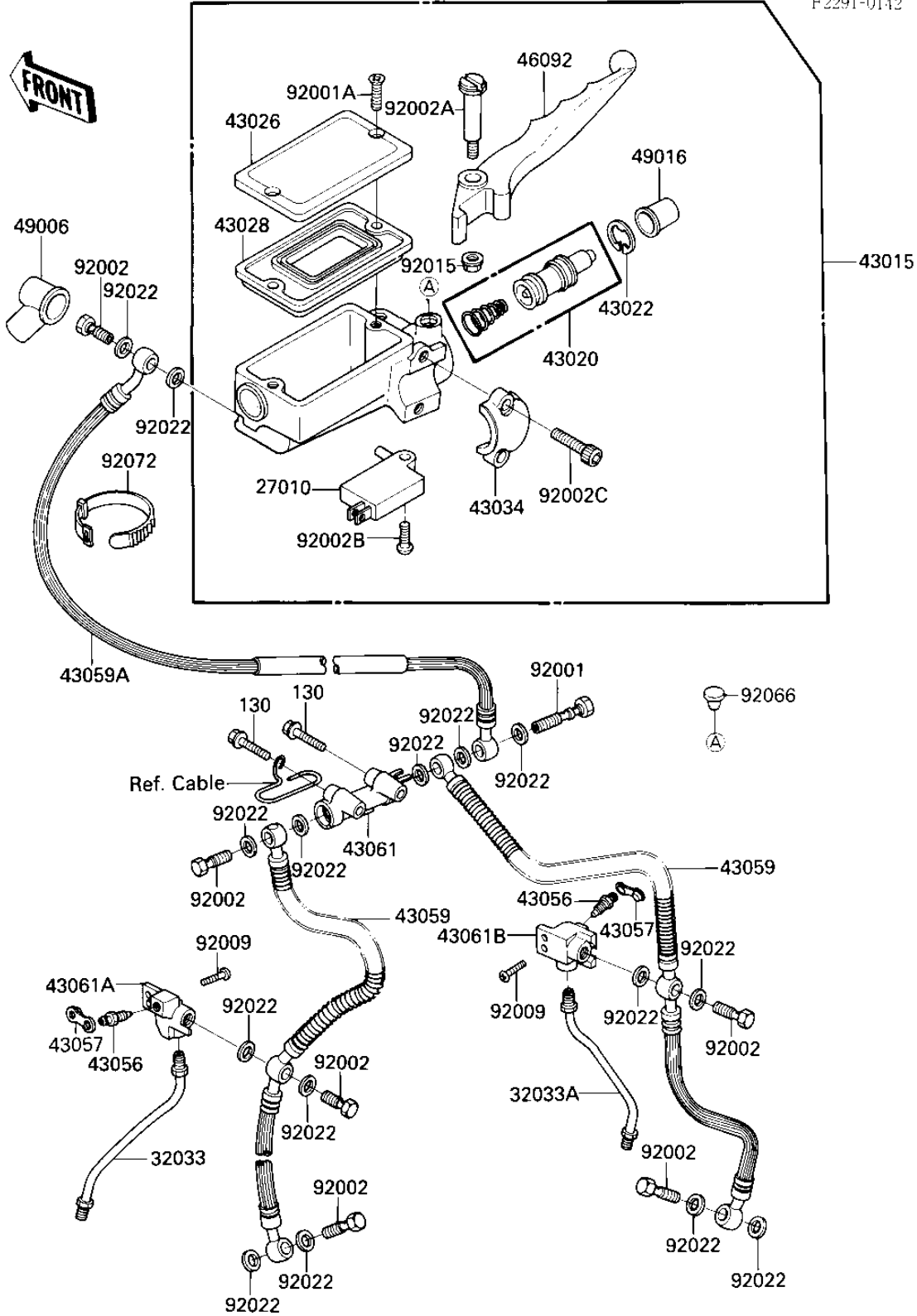

# 1985 Ninja® PARTS LIST

## FRONT MASTER CYLINDER

ITEM NAME	PART NUMBER	QUANTITY
SWITCH,BRAKE (Ref # 27010)	27010-1170	1
PIPE,BRAKE,FR,LH (Ref # 32033)	32033-1240	1
PIPE,BRAKE,FR,RH (Ref # 32033A)	32033-1241	1
CYLINDER-ASSY-MASTER, (Ref # 43015)	43015-1260	1
PISTON-COMP-BRAKE,FR (Ref # 43020)	43020-1054	1
STOPPER-BRAKE,PISTON (Ref # 43022)	43022-1010	1
CAP-BRAKE,FR (Ref # 43026)	43026-1052	1
DIAPHRAGM,MASTER CYLI (Ref # 43028)	43028-1058	1
HOLDER-BRAKE,MASTER C (Ref # 43034)	43034-1053	1
BREATHER-BRAKE (Ref # 43056)	43056-1051	2
CAP-BREATHER (Ref # 43057)	43057-1001	2
HOSE-BRAKE,FR,L=505 (Ref # 43059)	43059-1259	2
HOSE-BRAKE,FR,L=340 (Ref # 43059A)	43059-1260	1
JOINT BRAKE (Ref # 43061)	43061-1004	1
JOINT-BRAKE,FR,LH (Ref # 43061A)	43061-1051	1
JOINT-BRAKE,FR,RH (Ref # 43061B)	43061-1052	1
LEVER-GRIP,FRONT BRAK (Ref # 46092)	46092-1112	1
BOOT,DUST (Ref # 49006)	49006-1041	1
COVER-SEAL,MASTER CYL (Ref # 49016)	49016-1044	1
BOLT (Ref # 92001)	92002-1909	1
BOLT,MASTER CYLINDER (Ref # 92001A)	92001-1727	2
BOLT,OIL,L=23 (Ref # 92002)	92002-1888	6
BOLT,LEVER SET (Ref # 92002A)	92002-1322	1
BOLT (Ref # 92002B)	92002-1323	1
BOLT,SOCKET,6X10 (Ref # 92002C)	92002-1324	2
SCREW,6X14 (Ref # 92009)	92009-1349	2
NUT,FLANGED,6MM (Ref # 92015)	92015-1233	1
WASHER-OIL BOLT (Ref # 92022)	43067-001	15
PLUG,9.5X8 (Ref # 92066)	92066-1077	1

# 1985 Ninja® PARTS LIST

## FRONT MASTER CYLINDER

ITEM NAME	PART NUMBER	QUANTITY
BAND,WIRING HARNESS (Ref # 92072)	92072-056	1
BOLT-FLANGED,6X60 (Ref # 130)	130G0660	2