

1985 GPz 750 Turbo PARTS DIAGRAM

CANISTER

E1650-0001

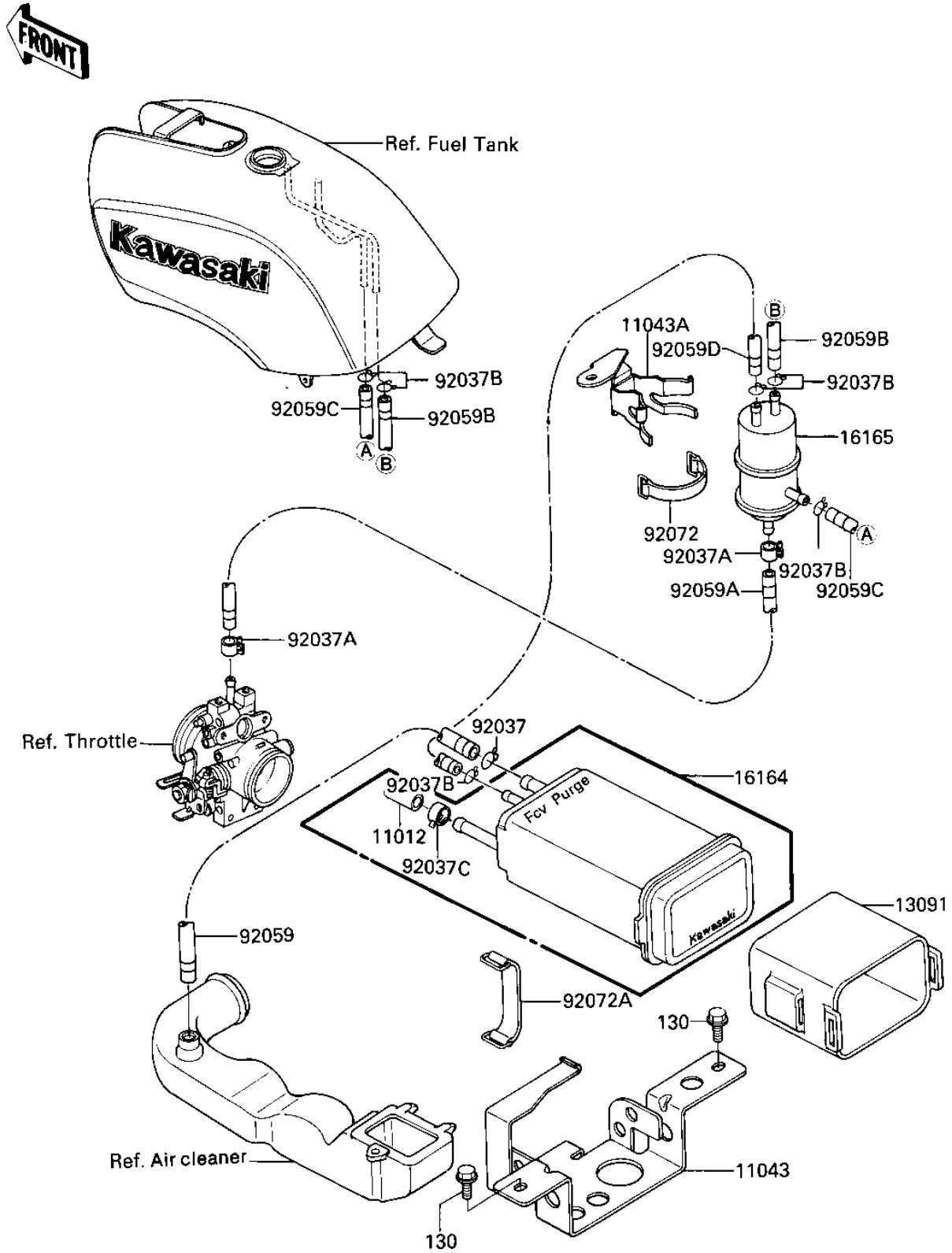

1985 GPz 750 Turbo PARTS LIST

CANISTER

| ITEM NAME | PART NUMBER | QUANTITY |
|------------------------------------|-------------|----------|
| CAP,CANISTER (Ref # 11012) | 11012-1388 | 1 |
| BRACKET,CANISTER (Ref # 11043) | 11043-1455 | 1 |
| BRACKET,SEPARATOR (Ref # 11043A) | 11043-1491 | 1 |
| HOLDER,CANISTER (Ref # 13091) | 13091-1176 | 1 |
| CANISTER (Ref # 16164) | 16164-1054 | 1 |
| SEPARATOR (Ref # 16165) | 16165-1001 | 1 |
| CLAMP-HOSE (Ref # 92037) | 92037-1104 | 1 |
| CLAMP,TUBE (Ref # 92037A) | 92037-1461 | 2 |
| CLAMP,CHAIN OILER (Ref # 92037B) | 92037-147 | 6 |
| CLAMP,CANISTER (Ref # 92037C) | 92037-1512 | 1 |
| TUBE,7X12X1060,GREEN (Ref # 92059) | 92059-1421 | 1 |
| TUBE,4X9X470 (Ref # 92059A) | 92059-1402 | 1 |
| TUBE,5X10X660,RED (Ref # 92059B) | 92059-1502 | 1 |
| TUBE,5X10X230,RED (Ref # 92059C) | 92059-1497 | 1 |
| TUBE,5X10X660,RED (Ref # 92059D) | 92059-1502 | 1 |
| BAND,TOOL (Ref # 92072) | 92072-066 | 1 |
| BAND (Ref # 92072A) | 92072-1006 | 1 |
| BOLT-FLANGED (Ref # 130) | 130D0608 | 2 |