

1985 GPz 750 Turbo PARTS DIAGRAM

FRONT FORK

F2340-0213

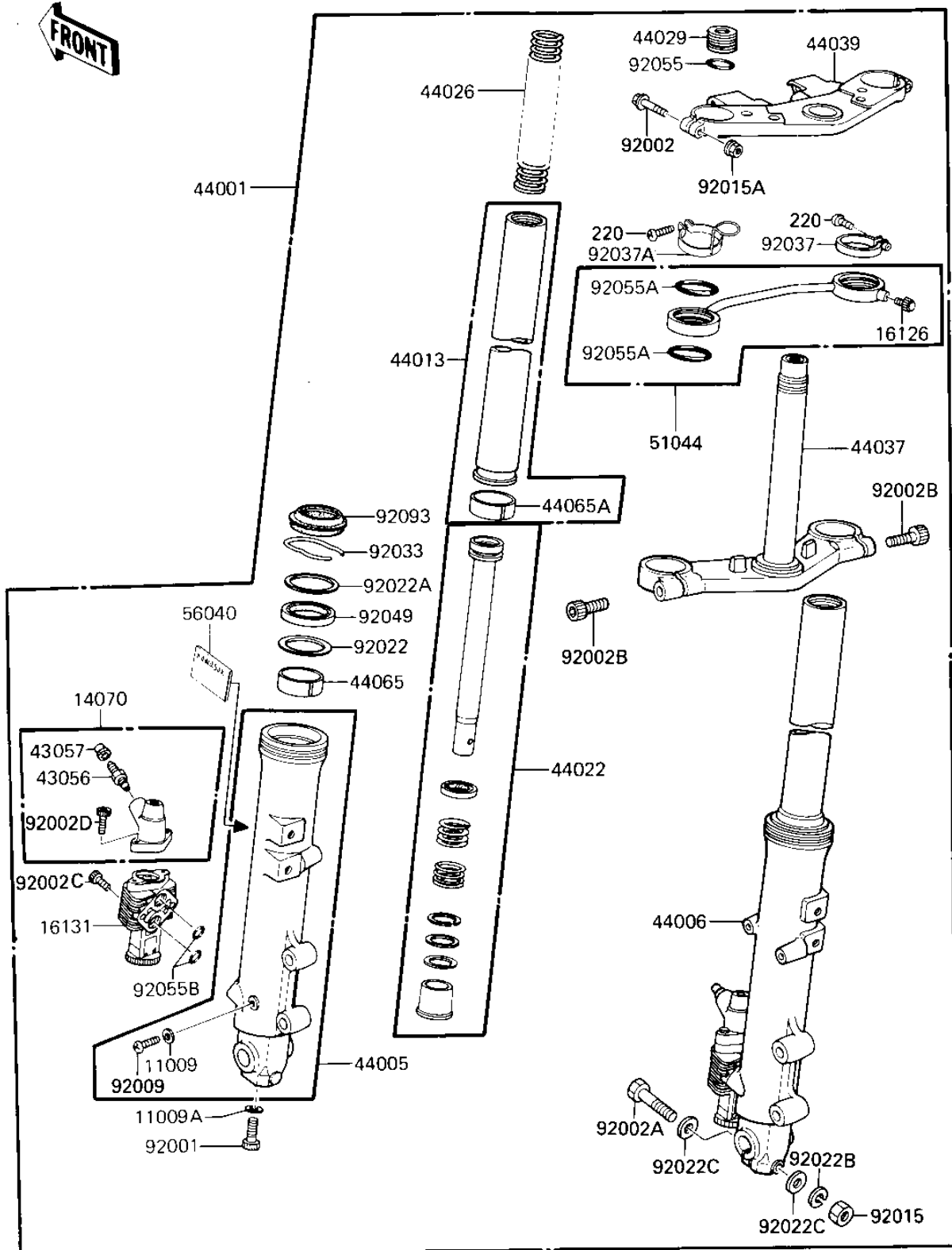

1985 GPz 750 Turbo PARTS LIST

FRONT FORK

| ITEM NAME | PART NUMBER | QUANTITY |
|-------------------------------------|-------------|----------|
| GASKET FORK DRAIN PLG (Ref # 11009) | 44045-002 | 2 |
| GASKET,FORK CYLINDER (Ref # 11009A) | 44045-057 | 2 |
| BODY-BREATHER,FORK (Ref # 14070) | 14070-1055 | 2 |
| VALVE AIR (Ref # 16126) | 16126-1052 | 1 |
| BODY-VALVE,RELIEF (Ref # 16131) | 16131-1054 | 2 |
| BREEDER (Ref # 43056) | 43056-003 | 2 |
| CAP,BREEDER (Ref # 43057) | 43057-003 | 2 |
| FORK-FRONT (Ref # 44001) | 44001-1504 | 1 |
| PIPE-LEFT FORK OUTER (Ref # 44005) | 44005-1130 | 1 |
| PIPE-RIGHT FORK OUTER (Ref # 44006) | 44006-1130 | 1 |
| PIPE-FORK INNER (Ref # 44013) | 44013-1208 | 2 |
| CYLINDER-FORK (Ref # 44022) | 44022-1157 | 2 |
| SPRING-FRONT FORK (Ref # 44026) | 44026-1263 | 2 |
| SEAT-FORK SPRING (Ref # 44029) | 44029-1035 | 2 |
| HOLDER-FORK UNDER (Ref # 44037) | 44037-1154 | 1 |
| HOLDER-FORK UPPER (Ref # 44039) | 44039-1073 | 1 |
| BUSHING-FRONT FORK (Ref # 44065) | 44065-1051 | 2 |
| BUSHING-FRONT FORK (Ref # 44065A) | 44065-1058 | 2 |
| TUBE-ASSY,AIR,FORK (Ref # 51044) | 51044-1027 | 1 |
| LABEL-WARNING,FRONT F (Ref # 56040) | 56040-1030 | 1 |
| BOLT-FORK CYLINDER (Ref # 92001) | 44041-040 | 2 |
| BOLT,FLANGED,8X55 (Ref # 92002) | 92002-1158 | 2 |
| BOLT,8X60 (Ref # 92002A) | 92002-1163 | 1 |
| BOLT,SOCKET,12X30 (Ref # 92002B) | 92002-1164 | 2 |
| BOLT,SOCKET,6X16 (Ref # 92002C) | 92002-1166 | 4 |
| BOLT,SOCKET,5X12 (Ref # 92002D) | 92002-1289 | 4 |
| SCREW,4X8 (Ref # 92009) | 92009-1324 | 2 |
| NUT,8MM (Ref # 92015) | 92015-1400 | 1 |
| NUT,FLANGED,8MM (Ref # 92015A) | 92015-1408 | 2 |

1985 GPz 750 Turbo PARTS LIST

FRONT FORK

| ITEM NAME | PART NUMBER | QUANTITY |
|--------------------------------------|-------------|----------|
| WASHER,FORK OUTER PIP (Ref # 92022) | 92022-1455 | 2 |
| WASHER,FORK OUTER PIP (Ref # 92022A) | 92022-1524 | 2 |
| BOLT,THROTTLE STOP SC (Ref # 92002B) | 92002-1552 | 1 |
| WASHER,PLAIN,8MM (Ref # 92002C) | 92022-1554 | 1 |
| SNAP RING,FORK OUTER (Ref # 92033) | 92033-1047 | 2 |
| CLAMP,FRONT FORK (Ref # 92037) | 92037-1454 | 1 |
| CLAMP,LH (Ref # 92037A) | 92037-1499 | 1 |
| SEAL-OIL,FORK OUTER T (Ref # 92049) | 92049-1372 | 2 |
| RING-O,FORK SPRING SE (Ref # 92055) | 92055-1132 | 2 |
| RING-O,TUBE ASSY (Ref # 92055A) | 92055-1164 | 4 |
| RING-O,ANTI-DIVE UNIT (Ref # 92055B) | 92055-1201 | 4 |
| SEAL,FORK OUTER TUBE (Ref # 92093) | 92093-1314 | 2 |
| SCREW-PAN-CROS (Ref # 220) | 220C0412 | 2 |