

# 1986 KLT110 PARTS DIAGRAM

HANDLEBAR (KLT110-A2)

F2310-0344

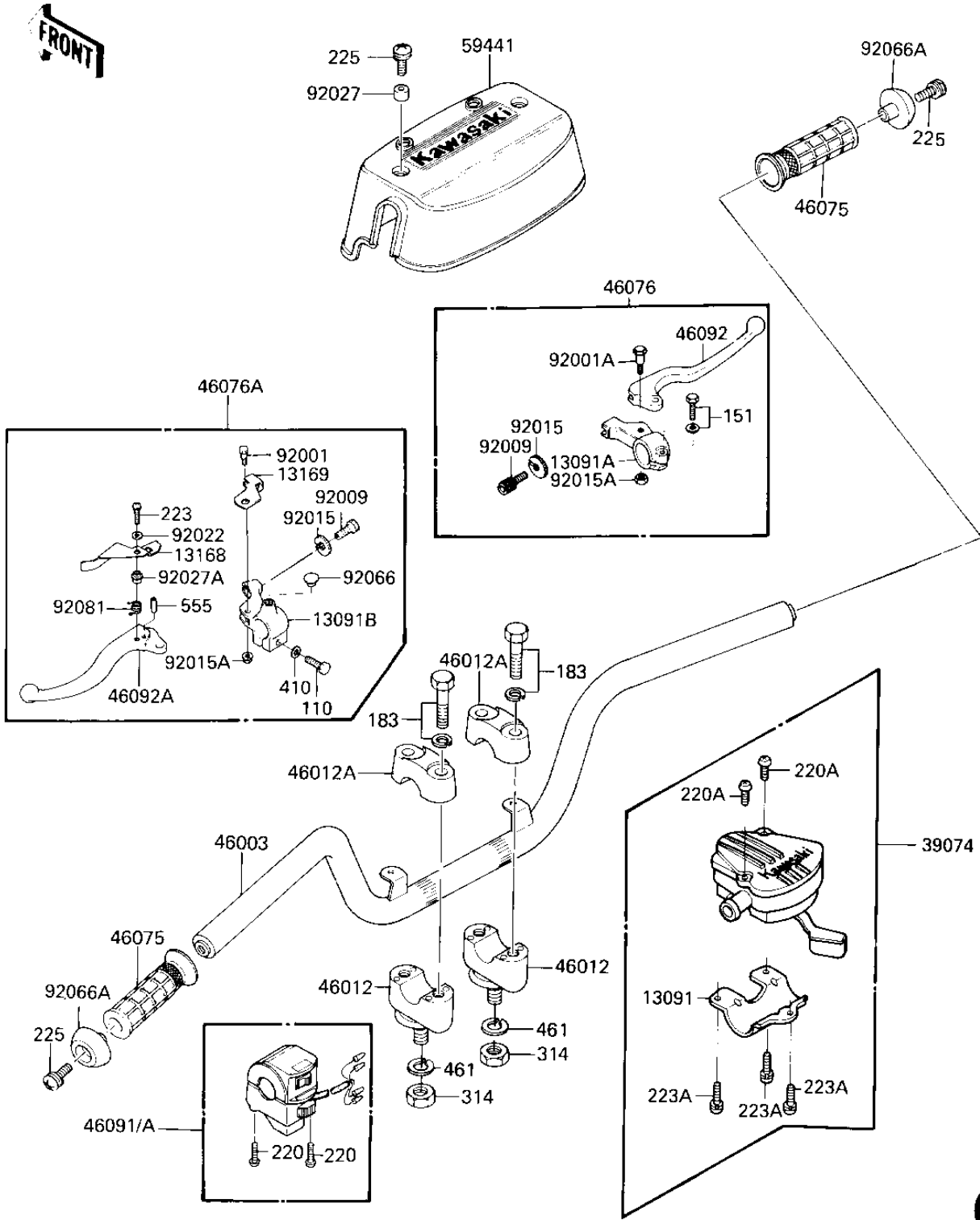

# 1986 KLT110 PARTS LIST

## HANDLEBAR (KLT110-A2)

ITEM NAME	PART NUMBER	QUANTITY
HOLDER,THROTTLE (Ref # 13091)	13091-1294	1
HOLDER,FR LEVER,F.BLK (Ref # 13091A)	46060-011-21	1
HOLDER-CLUTCH LEV,BLK (Ref # 13091B)	46094-011-21	1
LEVER,LOCK (Ref # 13168)	13168-1224	1
PLATE,CLUTCH LOCK (Ref # 13169)	13169-1398	1
LEVER-ASSY-THROTTLE (Ref # 39074)	39074-1051	1
HANDLEBAR,BLACK (Ref # 46003)	46003-4006	1
HOLDER,HANDLEBAR,BUFF (Ref # 46012)	46012-002-80	2
HOLDER UPPER HANDLEBAR (Ref # 46012A)	46012-004	2
GRIP,RH (Ref # 46075)	46075-4003	2
LEVER ASSY,FRONT BRK (Ref # 46076)	46076-1010	1
LEVER-ASSY-GRIP,CLUTC (Ref # 46076A)	46076-1115	1
HOUSING-ASSY-CONTROL, (Ref # 46091)	46091-1392	1
HOUSING-ASSY-CONTROL, (Ref # 46091A)	46091-1392	1
LEVER,FRONT BRAKE (Ref # 46092)	46092-1014	1
LEVER-GRIP,CLUTCH (Ref # 46092A)	46092-1107	1
COVER-HANDLEBAR (Ref # 59441)	59441-4001	1
BOLT,5MM (Ref # 92001)	92007-039	1
BOLT,HEX HEAD,5X22 (Ref # 92001A)	92007-046	1
SCREW CABLE ADJUST (Ref # 92009)	46055-003	2
NUT-LOCK (Ref # 92015)	46056-005	2
NUT-LOCK,5MM (Ref # 92015A)	92019-014	2
WASHER,4X12X1 (Ref # 92022)	92022-1245	1
COLLAR,6.8X10X8.5 (Ref # 92027)	92027-129	2
COLLAR,RETURN SPRING (Ref # 92027A)	92027-1336	1
PLUG,9.5X8 (Ref # 92066)	92066-1077	1
PLUG,HANDLE (Ref # 92066A)	92066-1191	2
SPRING,CLUTCH LOCK RE (Ref # 92081)	92081-1358	1
BOLT HEX HEAD 6X25 (Ref # 110)	110N0625	1

# 1986 KLT110 PARTS LIST

## HANDLEBAR (KLT110-A2)

ITEM NAME	PART NUMBER	QUANTITY
BOLT-WP (Ref # 151)	151N0625	1
BOLT-UPSET-WS-SMALL (Ref # 183)	183B0835	4
SCREW-PAN-CROS (Ref # 220)	220B0535	4
SCREW-PAN-CROS,5X12,B (Ref # 220A)	220C0512	2
SCREW-PAN-WS-CROS (Ref # 223)	223B0420	1
SCREW-PAN-WS-CROS (Ref # 223A)	223C0512	3
SCREW-PAN-WSP-CROS,6X (Ref # 225)	225C0620	4
NUT,10MM (Ref # 314)	314B1000	2
WASHER PLAIN 6MM (Ref # 410)	410B0600	1
WASHER SPRING 10MM (Ref # 461)	461F1000	2
PIN-SPRING,3X16 (Ref # 555)	555A0316	1