

# 1986 KLT185 PARTS DIAGRAM

## GEAR CHANGE DRUM & FORKS

D.1002.0400

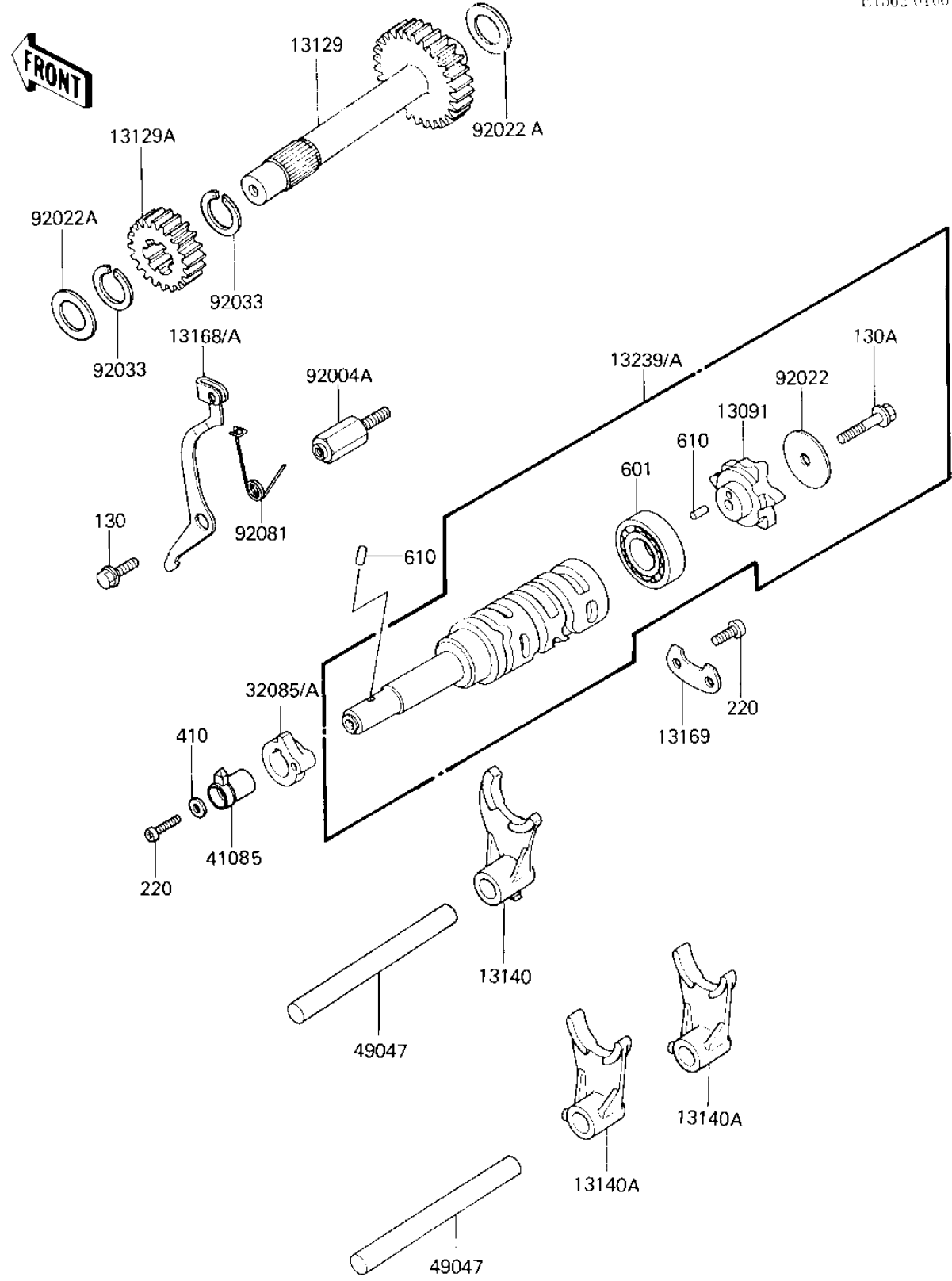

# 1986 KLT185 PARTS LIST

## GEAR CHANGE DRUM & FORKS

ITEM NAME	PART NUMBER	QUANTITY
HOLDER (Ref # 13091)	13091-1434	1
GEAR,REVERSE (Ref # 13129)	13129-1549	1
GEAR,REVERSE,21T (Ref # 13129A)	13129-1550	1
FORK-SHIFT (Ref # 13140)	13140-1106	1
FORK-SHIFT (Ref # 13140A)	13140-1137	2
LEVER,REVERSE (Ref # 13168)	13168-1296	1
PLATE (Ref # 13169)	13169-1749	1
DRUM-ASSY-CHANGE (Ref # 13239)	13239-1127	1
UNAVAILABLE IN PRICE BOOK (Ref # 32085)	32085-1166	1
INDICATOR,CHAGE DRUM (Ref # 41085)	41085-1055	1
ROD-SHIFT (Ref # 49047)	49047-1073	2
STUD (Ref # 92004)	92004-1138	1
WASHER,6.2X38X1.2 (Ref # 92022)	92022-1500	1
WASHER,THRUST,15MM (Ref # 92022A)	92022-279	2
CIRCLIP,18MM (Ref # 92033)	92033-029	2
SPRING (Ref # 92081)	92081-1966	1
BOLT,FLANGED,6X12 (Ref # 130)	130G0612	1
BOLT,FLANGED,6X35 (Ref # 130A)	130H0635	1
SCREW-PAN-CROS,5X25 (Ref # 220)	220B0525	1
SCREW PAN HEAD 6X14 (Ref # 220A)	220B0614	2
WASHER PLAIN 5MM (Ref # 410)	410B0500	1
BEARING BALL #6004 (Ref # 601)	601B6004	1
PIN-DOWEL,4X6 (Ref # 610)	610A0406	2