

1987 Ninja® 1000R PARTS DIAGRAM

CLUTCH

E1359-0125

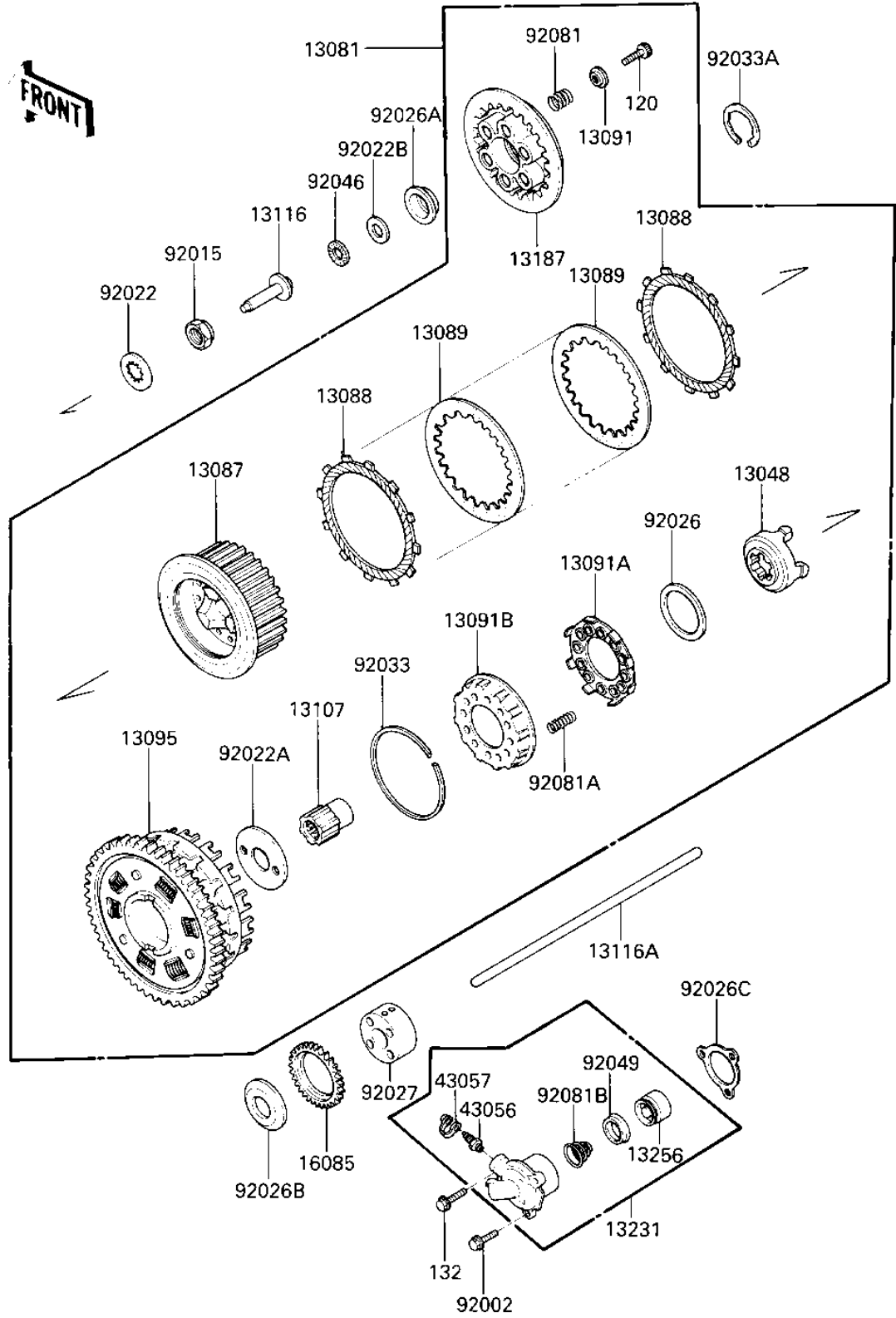

1987 Ninja® 1000R PARTS LIST

CLUTCH

ITEM NAME	PART NUMBER	QUANTITY
DAMPER (Ref # 13048)	13048-1007	1
CLUTCH-ASSY (Ref # 13081)	13081-1208	1
HUB,CLUTCH (Ref # 13087)	13087-1009	1
PLATE-FRICTION (Ref # 13088)	13088-1051	9
PLATE,CLUTCH,STEEL (Ref # 13089)	13089-1004	8
HOLDER,CLUTCH,SPRING (Ref # 13091)	13091-1041	6
HOLDER,CLUTCH SPRING (Ref # 13091A)	13091-1042	1
HOLDER,CLUTCH SPRING (Ref # 13091B)	13091-1043	1
HOUSING-COMP-CLUTCH (Ref # 13095)	13095-1146	1
SHAFT,CLUTCH (Ref # 13107)	13107-1024	1
ROD-PUSH,CLUTCH (Ref # 13116)	13116-1102	1
ROD-PUSH,CLUTCH (Ref # 13116A)	13116-1115	1
PLATE,CLUTCH OPERATNG (Ref # 13187)	13187-1004	1
RELEASE-ASSY-CLUTCH (Ref # 13231)	13231-1066	1
PISTON,CLUTCH RELEASE (Ref # 13256)	13256-1051	1
GEAR,OIL PUMP (Ref # 16085)	16085-1108	1
BREATHER-BRAKE (Ref # 43056)	43056-1052	1
CAP-BREATHER (Ref # 43057)	43057-1001	1
BOLT (Ref # 92002)	92002-1613	2
NUT,20MM (Ref # 92015)	92015-1555	1
WASHER,LOCK (Ref # 92022)	92022-1114	1
WASHER,CLUTCH THRUST (Ref # 92022A)	92022-1221	1
WASHER,15.1X29X1.0 (Ref # 92022B)	92022-1463	1
SPACER,3.5X59X70 (Ref # 92026)	92026-1043	1
SPACER,CLUTCH (Ref # 92026A)	92026-1202	1
SPACER (Ref # 92026B)	92026-5001	1
SPACER,CLUTCH RELEASE (Ref # 92026C)	92026-1263	1
COLLAR (Ref # 92027)	92027-1710	1
RING,SNAP (Ref # 92033)	92033-1029	1

1987 Ninja® 1000R PARTS LIST

CLUTCH

ITEM NAME	PART NUMBER	QUANTITY
RING-SNAP (Ref # 92033A)	92033-1177	1
BEARING-NEEDLE,AXK110 (Ref # 92046)	92046-1052	1
SEAL-OIL,PISTON (Ref # 92049)	92049-1165	1
SPRING,CLUTCH (Ref # 92081)	92081-1114	6
SPRING,CLUTCH DAMPER (Ref # 92081A)	92081-1115	12
SPRING,CLUTCH RELEASE (Ref # 92081B)	92081-1644	1
BOLT-SOCKET,6X16,BLAC (Ref # 120)	120S0616	6
BOLT-FLANGED-SMALL (Ref # 132)	132J0680	1