

# 1988 JS300 PARTS DIAGRAM

Oil Tank

F3171-0003

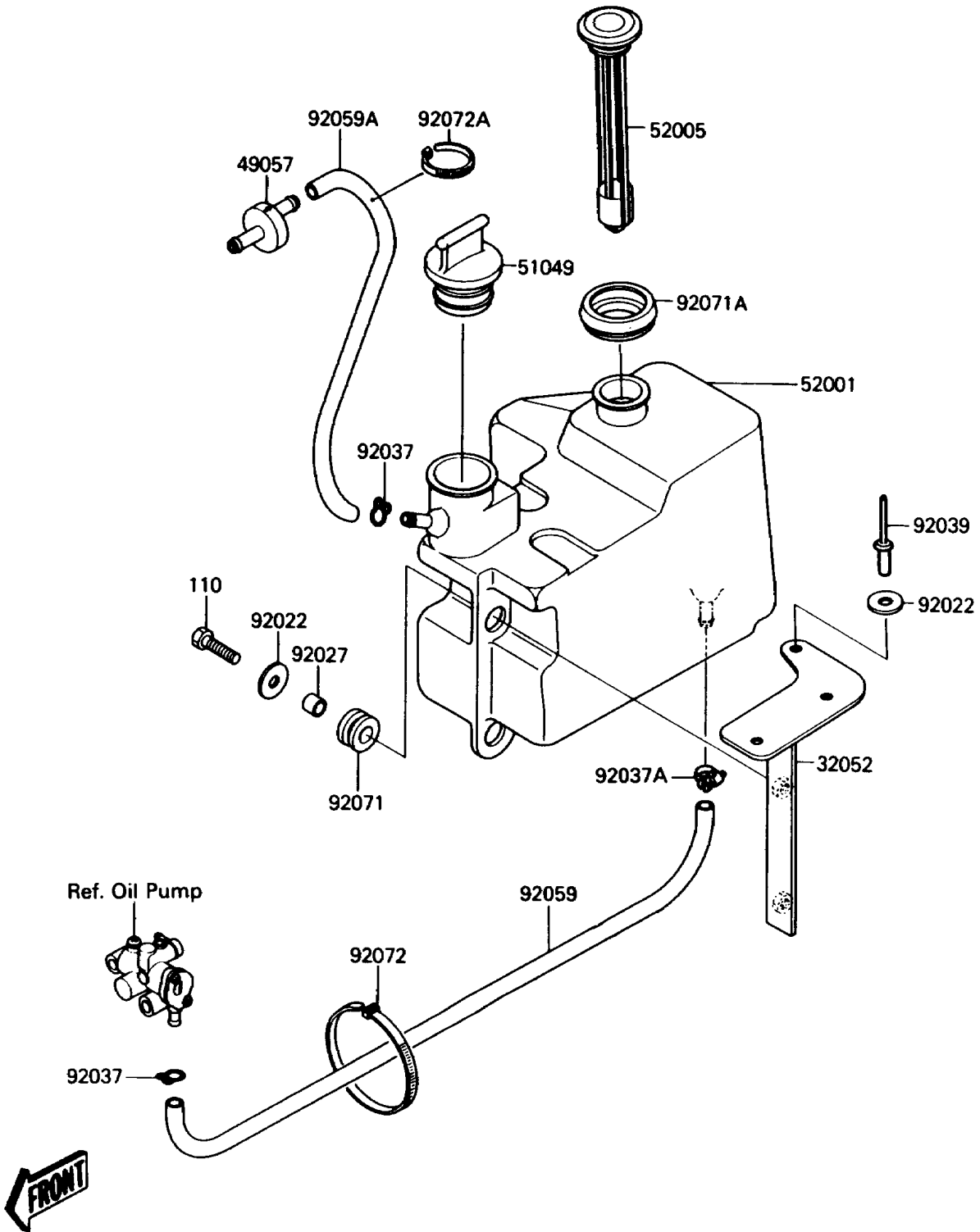

# 1988 JS300 PARTS LIST

## Oil Tank

ITEM NAME	PART NUMBER	QUANTITY
BRACKET-TANK,OIL (Ref # 32052)	32052-3702	1
VALVE-RELIEF (Ref # 49057)	49057-3001	1
CAP-TANK,OIL (Ref # 51049)	51049-3707	1
TANK-OIL (Ref # 52001)	52001-3702	1
GAUGE (Ref # 52005)	52005-3702	1
WASHER,6.2X20X2 (Ref # 92022)	92022-3714	5
COLLAR,6.2X10X10 (Ref # 92027)	92027-3705	2
CLAMP,11MM (Ref # 92037)	92037-3723	2
CLAMP (Ref # 92037A)	92037-3726	1
RIVET,4.8MM (Ref # 92039)	92039-3719	3
TUBE (Ref # 92059)	92059-3764	1
TUBE,5.8X10.8X280 (Ref # 92059A)	92059-3819	1
GROMMET (Ref # 92071)	92071-3716	2
GROMMET (Ref # 92071A)	92071-3750	1
BAND,L=123 (Ref # 92072)	92072-030	1
BAND,L=149 (Ref # 92072A)	92072-031	1
BOLT,6X25 (Ref # 110)	110R0625	2