

# 1986 JS550 PARTS DIAGRAM

## CRANKCASE

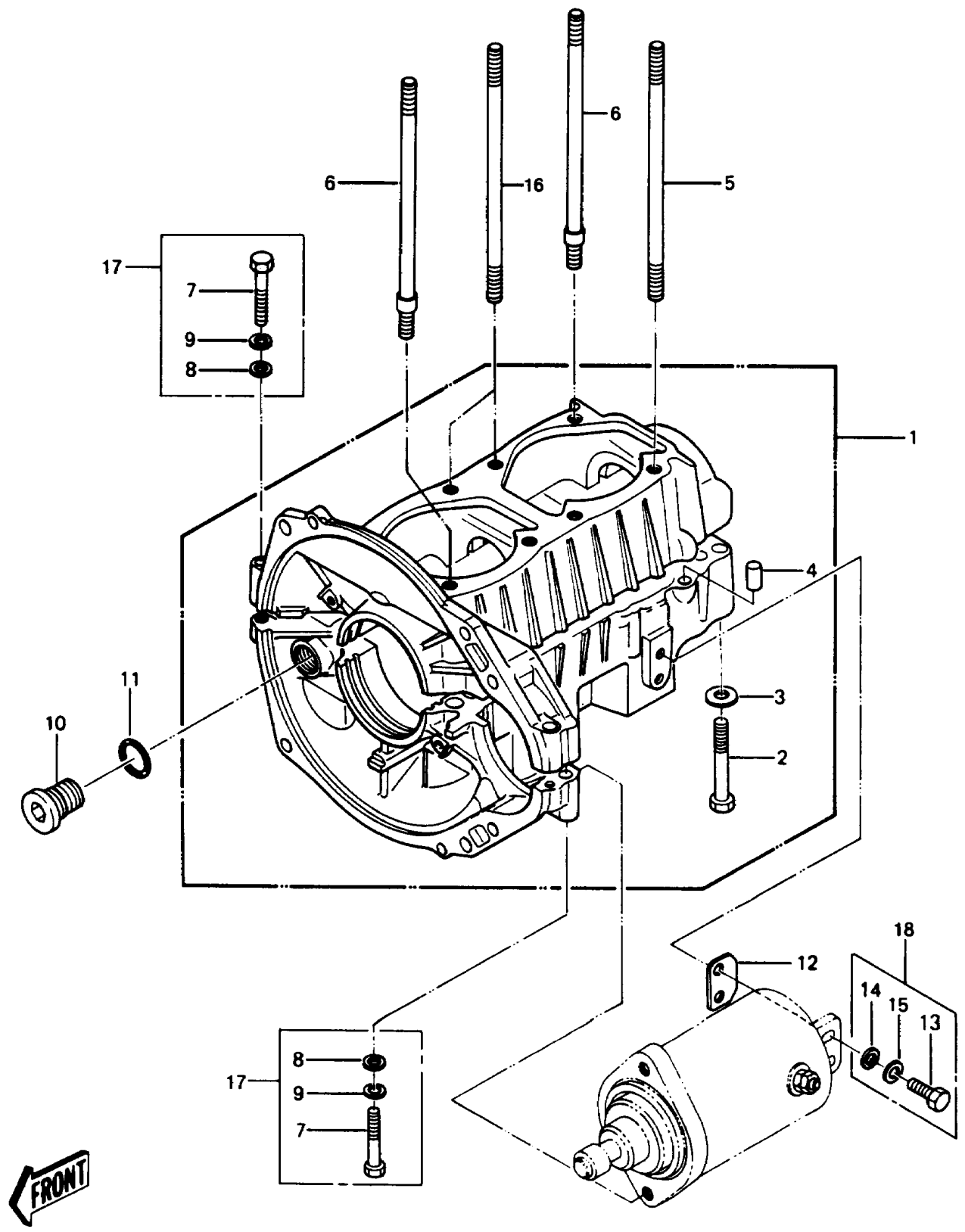

# 1986 JS550 PARTS LIST

## CRANKCASE

| ITEM NAME                         | PART NUMBER   | QUANTITY |
|-----------------------------------|---------------|----------|
| JOINT (Ref # 10)                  | 59071-516     | 1        |
| O RING,16MM (Ref # 11)            | 670B2016      | 1        |
| SHIM,STARTER,T=0.6 (Ref # 12A)    | 92025-3013    | AR       |
| SHIM,STARTER,T=0.8 (Ref # 12B)    | 92025-3014    | AR       |
| SHIM,STARTER,T=0.4 (Ref # 12)     | 92025-3012    | AR       |
| BOLT,6X20 (Ref # 13)              | 110R0620      | 2        |
| WASHER-PLAIN-SMALL,6MM (Ref # 14) | 410S0600      | 2        |
| WASHER-SPRING,6MM (Ref # 15)      | 461S0600      | 2        |
| STUD,8X170 (Ref # 16)             | 92004-2084    | 2        |
| SET-CRANKCASE (Ref # 1)           | 14001-3027-YR | 1        |
| BOLT,8X60 (Ref # 2)               | 92001-3033    | 10       |
| WASHER-PLAIN-SMALL,8MM (Ref # 3)  | 410S0800      | 10       |
| PIN,DOWEL,6.3X8X14 (Ref # 4)      | 92042-007     | 2        |
| STUD,8X167 (Ref # 5)              | 92004-507     | 4        |
| STUD,8X167 (Ref # 6)              | 92004-3020    | 2        |
| BOLT,6X40 (Ref # 7)               | 110R0640      | 3        |
| WASHER-PLAIN-SMALL,6MM (Ref # 8)  | 410S0600      | 3        |
| WASHER-SPRING,6MM (Ref # 9)       | 461S0600      | 3        |