

1980 KV75 PARTS DIAGRAM

HANDLEBAR ('76-'80)

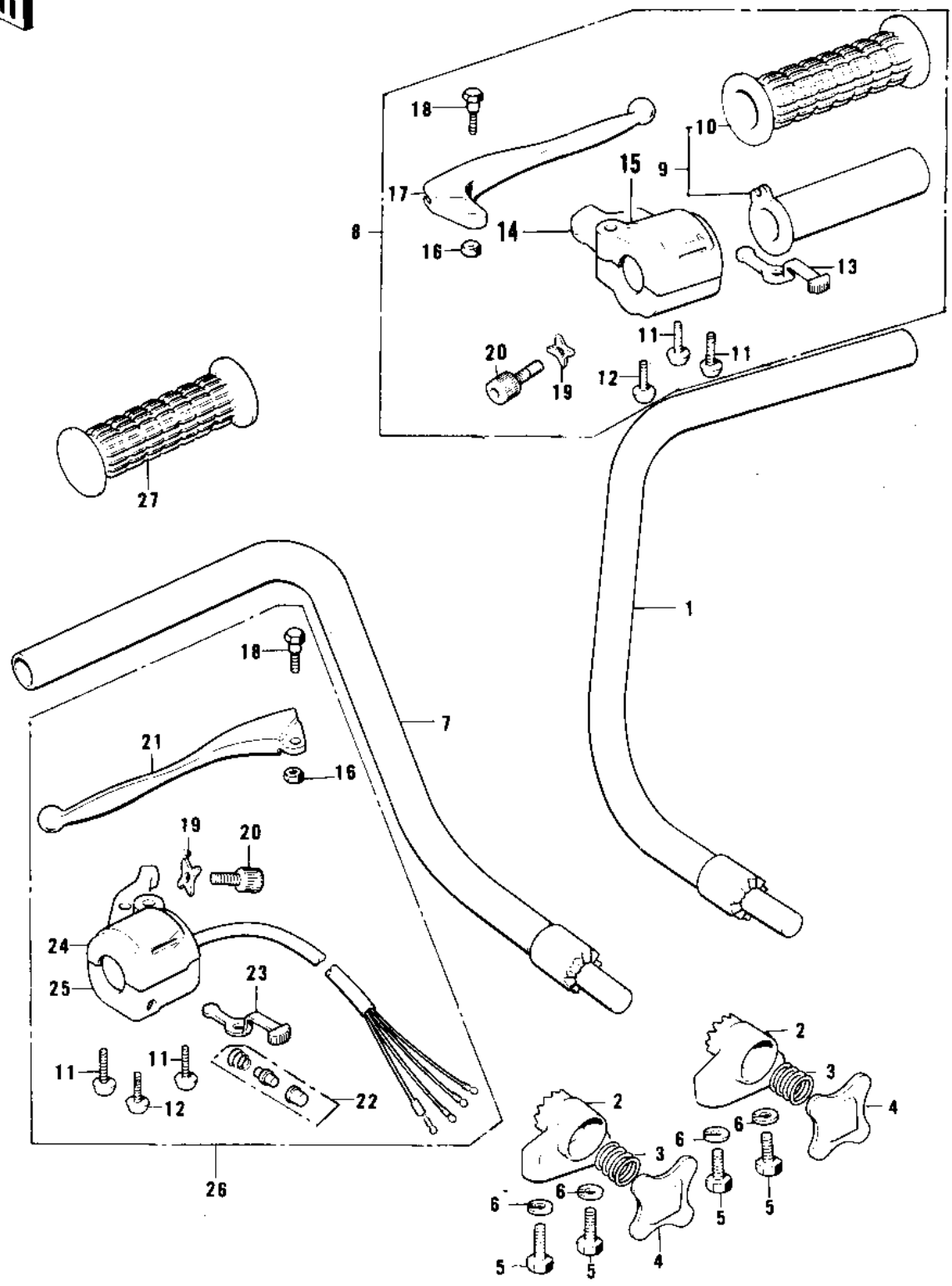

1980 KV75 PARTS LIST

HANDLEBAR ('76-'80)

| ITEM NAME | PART NUMBER | QUANTITY |
|----------------------------------|-------------|----------|
| HANDLEBAR,RH (Ref # 1) | 46007-010 | 1 |
| HOLDER-HANDLEBAR (Ref # 2) | 46012-009 | 2 |
| SPRING (Ref # 3) | 92081-090 | 2 |
| KNOB-HANDLEBAR HOLDER (Ref # 4) | 46129-001 | 2 |
| BOLT,HEX HEAD,10X18 (Ref # 5) | 113G1018 | 4 |
| WASHER SPRING 10MM (Ref # 6) | 461F1000 | 4 |
| HANDLEBAR,LH (Ref # 7) | 46007-011 | 1 |
| GRIP ASSY,R.H (Ref # 8) | 46017-077 | 1 |
| GRIP ASSY,R.H (Ref # 8) | 46017-1009 | 1 |
| GRIP ASSY,THROTTLE (Ref # 9) | 46019-024 | 1 |
| GRIP ASSY,THROTTLE (Ref # 9) | 46019-041 | 1 |
| RUBBER,R.H.GRIP (Ref # 10) | 46061-015 | 1 |
| SCREW PAN HEAD 5X20 (Ref # 11) | 220B0520 | 4 |
| SCREW PAN HEAD 5X18 (Ref # 12) | 220B0518 | 2 |
| KNOB ASSY R.H SWITCH (Ref # 13) | 46043-002 | 1 |
| CASE R.H SWITCH LOWER (Ref # 14) | 46022-012 | 1 |
| CASE,R.H LOWER (Ref # 14) | 46022-017 | 1 |
| GRIP-ASSY,RH (Ref # 15) | 46017-1071 | 1 |
| CASE,R.H. UPPER (Ref # 15) | 46040-015 | 1 |
| NUT-LOCK,5MM (Ref # 16) | 92019-014 | 2 |
| LEVER FRONT BRAKE (Ref # 17) | 46058-004 | 1 |
| BOLT,HEX HEAD,5X22 (Ref # 18) | 92007-046 | 2 |
| NUT LOCK ADJUST SCREW (Ref # 19) | 46056-001 | 2 |
| SCREW CABLE ADJUST (Ref # 20) | 46055-003 | 2 |
| LEVER-CLUTCH (Ref # 21) | 46092-015 | 1 |
| SWITCH ASSY LH BUTTON (Ref # 22) | 46078-003 | 1 |
| KNOB ASSY L.H SWITCH (Ref # 23) | 46088-001 | 1 |
| CASE L.H SWITCH UPPER (Ref # 24) | 46086-007 | 1 |
| CASE,L.H UPPER (Ref # 24) | 46086-025 | 1 |

1980 KV75 PARTS LIST

HANDLEBAR ('76-'80)

| ITEM NAME | PART NUMBER | QUANTITY |
|----------------------------------|-------------|----------|
| CASE L.H SWITCH LOWER (Ref # 25) | 46077-008 | 1 |
| CASE, L.H. LOWER (Ref # 25) | 46077-026 | 1 |
| 46074-092 (Canada) (Ref # 26) | 46074-067 | 1 |
| GRIP ASSY,L.H (Ref # 26) | 46074-092 | 1 |
| GRIP ASSY,L.H. (Ref # 26) | 46074-1005 | 1 |
| RUBBER,L.H GRIP (Ref # 27) | 46075-020 | 1 |
| RUBBER,L.H GRIP (Ref # 27) | 46075-028 | 1 |
| DUST COVER (Ref # 28) | 49016-1028 | 1 |