

1979 KV75-A8 PARTS DIAGRAM

FUEL TANK/OIL TANK/LABELS ('76-'80)

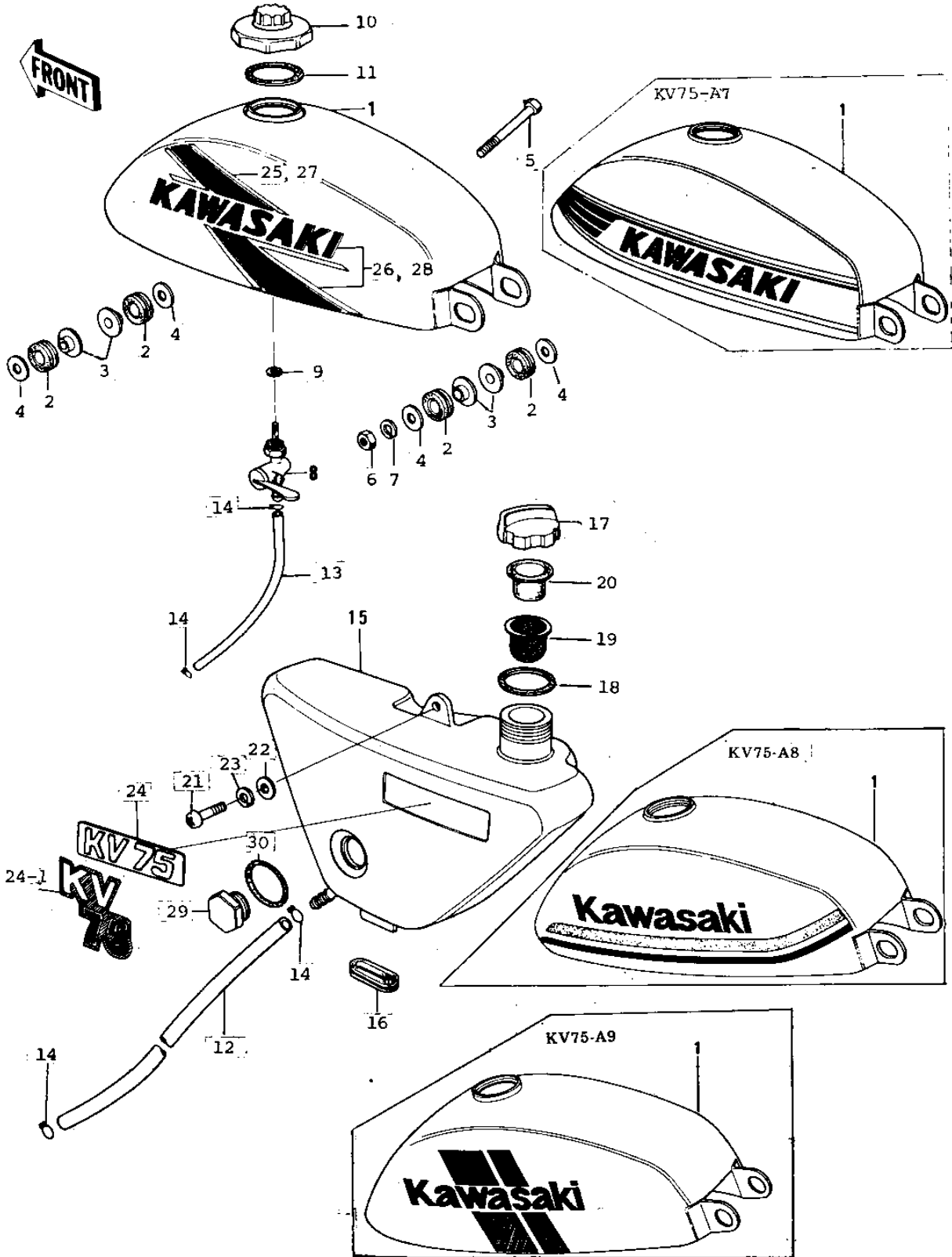

1979 KV75-A8 PARTS LIST

FUEL TANK/OIL TANK/LABELS ('76-'80)

ITEM NAME	PART NUMBER	QUANTITY
TANK-FUEL,C.S.RED (Ref # 1)	51001-064-3R	1
TANK-FUEL,CERULEAN BL (Ref # 1)	51001-064-4M	1
TANK-FUEL,POPPY RED (Ref # 1)	51001-064-4P	1
TANK-FUEL,C.WHITE (Ref # 1)	51001-5007-7R	1
TANK-FUEL,CRM.ORANGE (Ref # 1)	51001-064-D1	1
DAMPER RUBB TANK FRNT (Ref # 2)	92075-019	4
COLLAR (Ref # 3)	92027-080	4
WASHER,8X26X2.3 (Ref # 4)	92022-1564	6
BOLT,HEX HEAD,8X85 (Ref # 5)	92001-1226	1
NUT,8MM (Ref # 6)	311B0800	1
WASHER SPRING 8MM (Ref # 7)	461F0800	1
COCK ASSY,FUEL (Ref # 8)	51023-030	1
GASKET-FUEL COCK JONT (Ref # 9)	92065-075	1
CAP-FUEL TANK (Ref # 10)	51048-005	1
GASKET FUEL TANK CAP (Ref # 11)	51059-003	1
GASKET,FUEL TANK CAP (Ref # 11)	51059-006	1
PIPE-OIL (Ref # 12)	92059-072	1
TUBE (Ref # 13)	92059-074	1
CLAMP FUEL PIPE (Ref # 14)	92037-010	4
TANK,OIL,BLACK (Ref # 15)	52001-046-6Z	1
TANK,OIL,BLACK (Ref # 15)	52001-046-6Z	1
TANK,OIL,BLACK (Ref # 15)	52001-046-6Z	1
TANK,OIL,BLACK (Ref # 15)	52001-1007-6Z	1
DAMPER RUBBER (Ref # 16)	92075-070	1
CAP-OIL TANK (Ref # 17)	52002-002	1
GASKET-OIL TANK CAP (Ref # 18)	92065-079	1
CASE-TANK CAP RUBBER (Ref # 19)	52004-007	1
RUBBER-OIL TANK CAP (Ref # 20)	52004-008	1
SCREW PAN HEAD 6X16 (Ref # 21)	220B0616	1

1979 KV75-A8 PARTS LIST

FUEL TANK/OIL TANK/LABELS ('76-'80)

ITEM NAME	PART NUMBER	QUANTITY
WASHER PLAIN (Ref # 22)	92022-024	1
WASHER SPRING 6MM (Ref # 23)	461F0600	1
EMBLEM,OIL TANK (Ref # 24)	56018-216	1
MARK,OIL TANK (Ref # 24-1)	56018-1048	1
MARK,OIL TANK (Ref # 24-1)	56018-1130	1
DECAL,FL TK,L.H UPP (Ref # 25)	56027-342-SP	1
*** N.L.A.*** (Canada) (Ref # 25)	56029-030-SP	1
DECAL,FL TK,L.H LOW (Ref # 26)	56027-343-SP	1
*** N.L.A.*** (Canada) (Ref # 26)	56029-031-SP	1
DECAL,FL TK,R.H UPP (Ref # 27)	56027-344-SP	1
*** N.L.A.*** (Canada) (Ref # 27)	56029-032-SP	1
DECAL,FL TK,R.H LOW (Ref # 28)	56027-345-SP	1
*** N.L.A.*** (Canada) (Ref # 28)	56029-033-SP	1
GUAGE-OIL LEVEL (Ref # 29)	52015-002	1
"O" RING,20MM (Ref # 30)	92055-051	1