

1975 MT1C PARTS DIAGRAM

FUEL TANK/OIL TANK/LABELS ('76-'80)

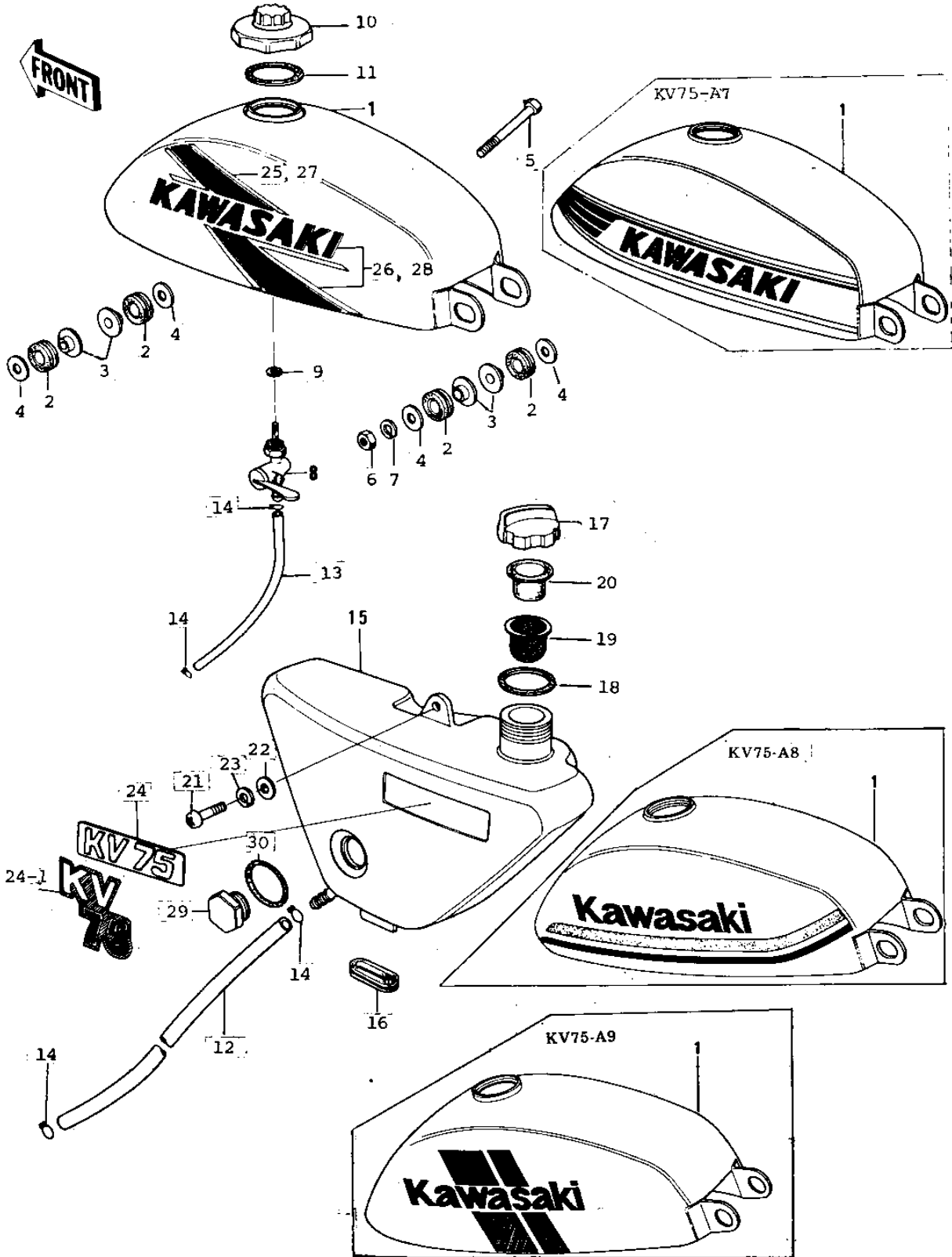

1975 MT1C PARTS LIST

FUEL TANK/OIL TANK/LABELS ('76-'80)

ITEM NAME	PART NUMBER	QUANTITY
TANK-FUEL,C.S.RED (Ref # 1)	51001-064-3R	
TANK-FUEL,CERULEAN BL (Ref # 1)	51001-064-4M	
TANK-FUEL,POPPY RED (Ref # 1)	51001-064-4P	
TANK-FUEL,C.WHITE (Ref # 1)	51001-5007-7R	
TANK-FUEL,CRM.ORANGE (Ref # 1)	51001-064-D1	
DAMPER RUBB TANK FRNT (Ref # 2)	92075-019	
COLLAR (Ref # 3)	92027-080	
WASHER,8X26X2.3 (Ref # 4)	92022-1564	
BOLT,HEX HEAD,8X85 (Ref # 5)	92001-1226	
NUT,8MM (Ref # 6)	311B0800	
WASHER SPRING 8MM (Ref # 7)	461F0800	
COCK ASSY,FUEL (Ref # 8)	51023-030	
GASKET-FUEL COCK JONT (Ref # 9)	92065-075	
CAP-FUEL TANK (Ref # 10)	51048-005	
GASKET FUEL TANK CAP (Ref # 11)	51059-003	
GASKET,FUEL TANK CAP (Ref # 11)	51059-006	
PIPE-OIL (Ref # 12)	92059-072	
TUBE (Ref # 13)	92059-074	
CLAMP FUEL PIPE (Ref # 14)	92037-010	
TANK,OIL,BLACK (Ref # 15)	52001-046-6Z	
TANK,OIL,BLACK (Ref # 15)	52001-046-6Z	
TANK,OIL,BLACK (Ref # 15)	52001-046-6Z	
TANK,OIL,BLACK (Ref # 15)	52001-1007-6Z	
DAMPER RUBBER (Ref # 16)	92075-070	
CAP-OIL TANK (Ref # 17)	52002-002	
GASKET-OIL TANK CAP (Ref # 18)	92065-079	
CASE-TANK CAP RUBBER (Ref # 19)	52004-007	
RUBBER-OIL TANK CAP (Ref # 20)	52004-008	
SCREW PAN HEAD 6X16 (Ref # 21)	220B0616	

1975 MT1C PARTS LIST

FUEL TANK/OIL TANK/LABELS ('76-'80)

ITEM NAME	PART NUMBER	QUANTITY
WASHER PLAIN (Ref # 22)	92022-024	
WASHER SPRING 6MM (Ref # 23)	461F0600	
EMBLEM,OIL TANK (Ref # 24)	56018-216	
MARK,OIL TANK (Ref # 24-1)	56018-1048	
MARK,OIL TANK (Ref # 24-1)	56018-1130	
UNAVAILABLE IN PRICE BOOK (Ref # 25-28)		
DECAL,FL TK,L.H UPP (Ref # 25)	56027-342-SP	
*** N.L.A.*** (Canada) (Ref # 25)	56029-030-SP	
DECAL,FL TK,L.H LOW (Ref # 26)	56027-343-SP	
*** N.L.A.*** (Canada) (Ref # 26)	56029-031-SP	
DECAL,FL TK,R.H UPP (Ref # 27)	56027-344-SP	
*** N.L.A.*** (Canada) (Ref # 27)	56029-032-SP	
DECAL,FL TK,R.H LOW (Ref # 28)	56027-345-SP	
*** N.L.A.*** (Canada) (Ref # 28)	56029-033-SP	
GUAGE-OIL LEVEL (Ref # 29)	52015-002	
"O" RING,20MM (Ref # 30)	92055-051	