

1969 Bushmaster PARTS DIAGRAM

CRANKSHAFT/PISTON /ROTARY VALVE ('69-'73)

Re

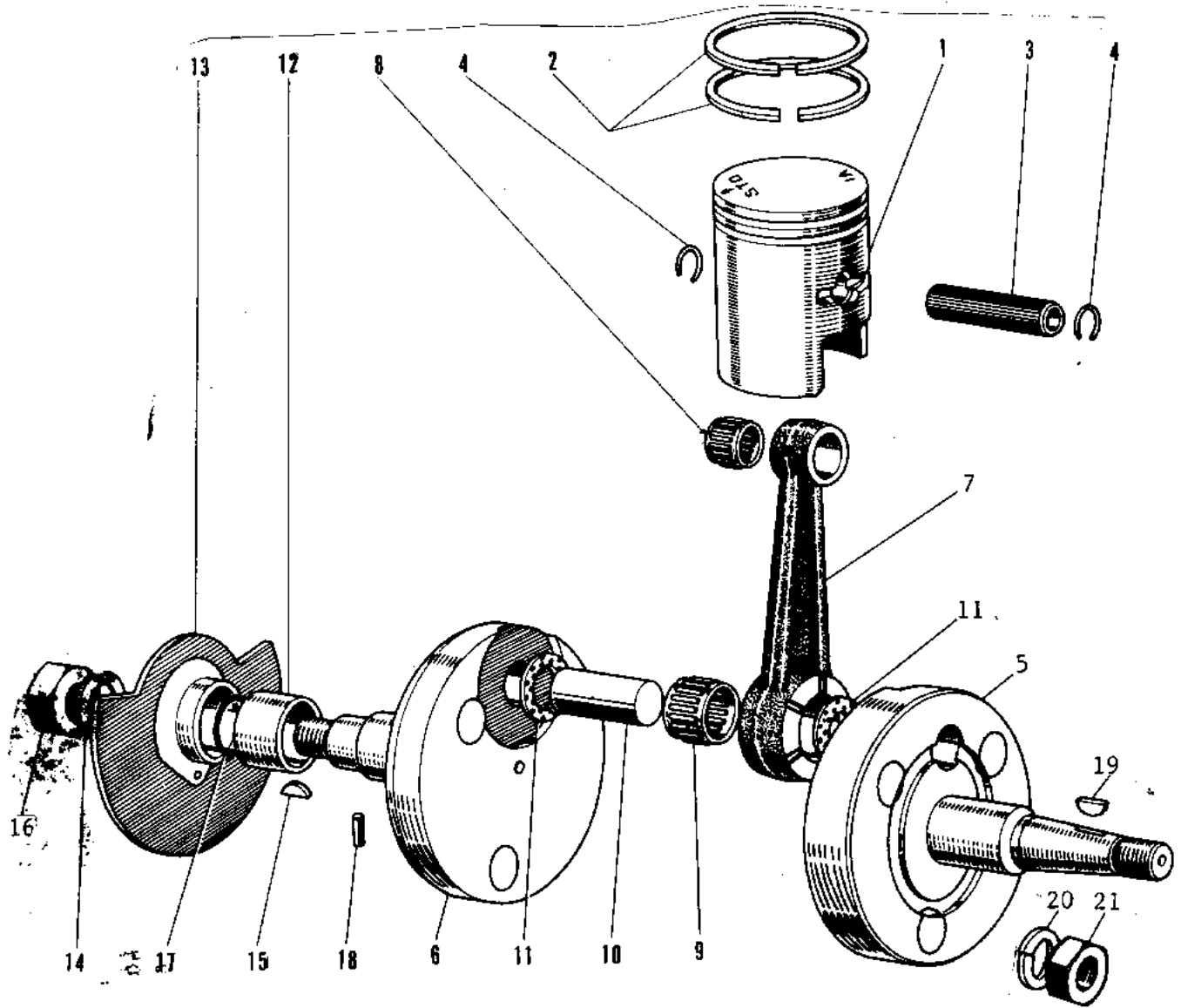

1969 Bushmaster PARTS LIST

CRANKSHAFT/PISTON /ROTARY VALVE ('69-'73)

| ITEM NAME | PART NUMBER | QUANTITY |
|-----------------------------------|-------------|----------|
| PISTON STD (Ref # 1) | 13001-015 | 1 |
| PISTON STD (Ref # 1) | 13001-037 | 1 |
| RING SET STD (Ref # 2) | 13008-011 | 1 |
| RING SET STD (Ref # 2) | 13008-023 | 1 |
| PIN-PISTON (Ref # 3) | 13002-007 | 1 |
| CIRCLIP PISTON PIN (Ref # 4) | 92036-007 | 2 |
| CRANK&CONROD ASSY (Ref # 5~11) | 13036-034 | N/ |
| CRANK&CONROD ASSY (Ref # 5~11) | 13036-034 | 1 |
| CRANKSHAFT L.H (Ref # 5) | 13037-018 | 1 |
| CRANKSHAFT,L.H (Ref # 5) | 13037-044 | 1 |
| CRANKSHAFT R.H (Ref # 6) | 13038-012 | 1 |
| CRANKSHAFT,R.H (Ref # 6) | 13038-040 | 1 |
| CONNECTING ROD SET (Ref # 7,9~11) | 13044-008 | 1 |
| CONNECTING ROD SET (Ref # 7,9~11) | 13044-019 | 1 |
| BRG N72KTV030 (Ref # 8) | 13033-028 | 1 |
| NEEDLE BEARING BG END (Ref # 9) | 13034-018 | 1 |
| NEEDLE BEARING-BG END (Ref # 9) | 13034-025 | 1 |
| CRANK PIN (Ref # 10) | 13035-008 | 1 |
| CRANK PIN (Ref # 10) | 13035-025 | 1 |
| WASHER SIDE (Ref # 11) | 92025-005 | 2 |
| WASHER-SIDE (Ref # 11) | 92025-047 | 2 |
| COLLAR CRANKSHAFT (Ref # 12) | 92027-022 | 1 |
| VALVE ROTARY DISC (Ref # 13) | 12001-004 | 1 |
| WASHER LOCK 12MM (Ref # 14) | 92024-003 | 1 |
| WOODRUFF KEY PRY PINI (Ref # 15) | 92038-003 | 1 |
| NUT 12MM (Ref # 16) | 92015-006 | 1 |
| "O" RING,16MM (Ref # 17) | 670B2016 | 1 |
| PIN DOWEL 4X8 (Ref # 18) | 610A0408 | 1 |
| WOODRUFF KEY (Ref # 19) | 510A3200 | 1 |

1969 Bushmaster PARTS LIST

CRANKSHAFT/PISTON /ROTARY VALVE ('69-'73)

| ITEM NAME | PART NUMBER | QUANTITY |
|-------------------------------|-------------|----------|
| WASHER SPRING 10MM (Ref # 20) | 461F1000 | 1 |
| NUT,10MM (Ref # 21) | 314B1000 | 1 |