

1974 G3SS-D PARTS DIAGRAM

OIL TANK/CHAIN COVER/CHAIN/SIDE COVER (

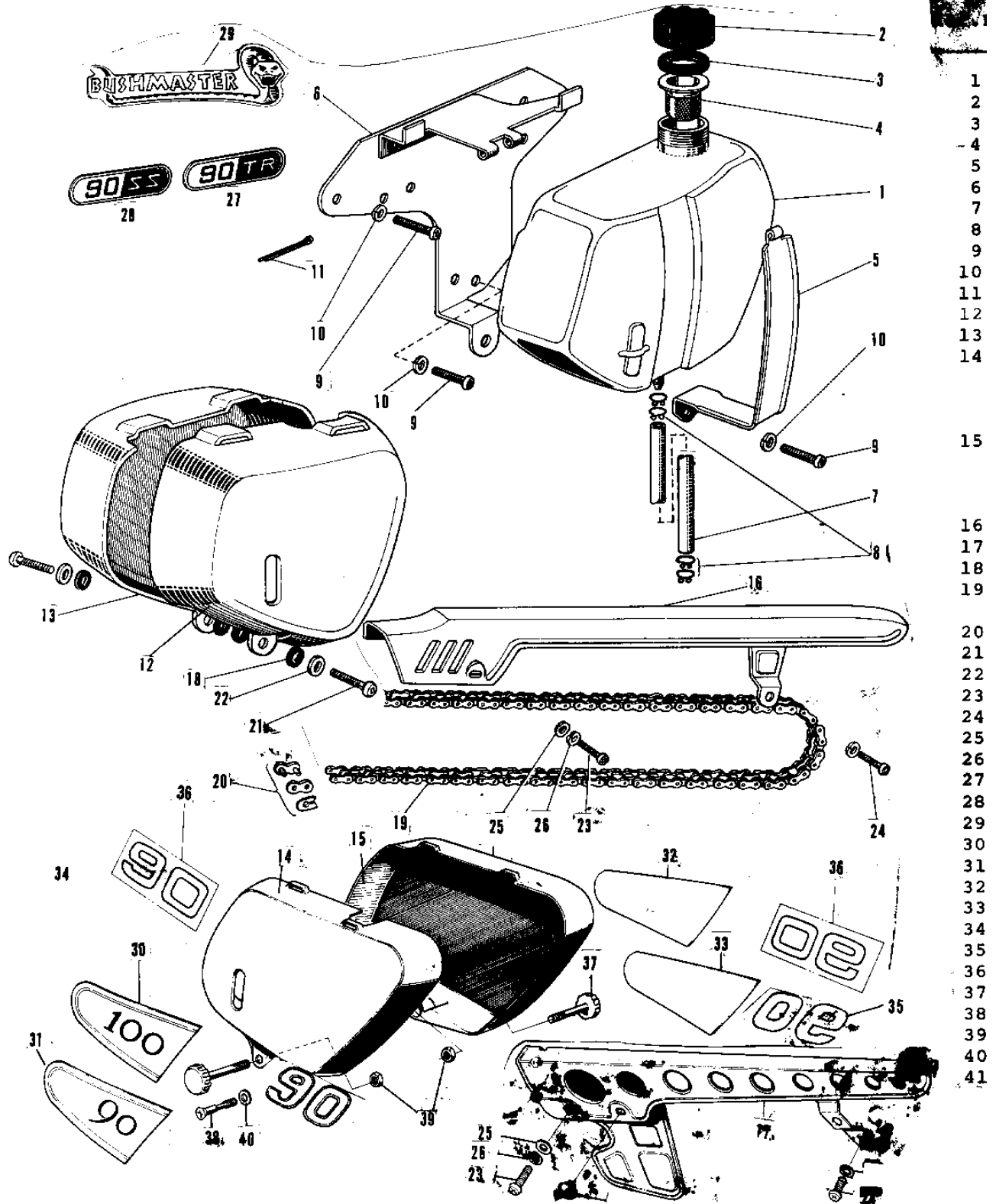

- 1
- 2
- 3
- 4
- 5
- 6
- 7
- 8
- 9
- 10
- 11
- 12
- 13
- 14
- 15
- 16
- 17
- 18
- 19
- 20
- 21
- 22
- 23
- 24
- 25
- 26
- 27
- 28
- 29
- 30
- 31
- 32
- 33
- 34
- 35
- 36
- 37
- 38
- 39
- 40
- 41

1974 G3SS-D PARTS LIST

OIL TANK/CHAIN COVER/CHAIN/SIDE COVER ('

| ITEM NAME | PART NUMBER | QUANTITY |
|----------------------------------|--------------|----------|
| TANK OIL (Ref # 1) | 52001-004 | 1 |
| CAP OIL TANK (Ref # 2) | 52003-002 | 1 |
| GASKET OIL TANK CAP (Ref # 3) | 92065-020 | 1 |
| STRAINER OIL TANK CAP (Ref # 4) | 52004-002 | 1 |
| BAND OIL TANK (Ref # 5) | 32100-007 | 1 |
| BRACKET OIL TANK (Ref # 6) | 32094-001 | 1 |
| PIPE OIL TANK (Ref # 7) | 92059-008 | 1 |
| CLAMP FUEL PIPE (Ref # 8) | 92037-010 | 4 |
| SCREW PAN HEAD 6X12 (Ref # 9) | 220B0612 | 4 |
| WASHER SPRING 6MM (Ref # 10) | 461F0600 | 4 |
| PIN COTTER 3.0X30 (Ref # 11) | 550D3030 | 1 |
| COVER L.H SIDE WHITE (Ref # 12) | 36001-013-17 | 1 |
| COVER,RH SIDE,WHITE (Ref # 13) | 36007-014-17 | 1 |
| COVER-L.H SIDE,ORANGE (Ref # 14) | 36001-026-55 | 1 |
| COVER,RH SIDE,ORANGE (Ref # 15) | 36007-023-55 | 1 |
| COVER CHAIN (Ref # 16) | 36014-024 | 1 |
| CASE-CHAIN,BLACK (Ref # 17) | 36014-037-21 | 1 |
| DAMPER RUBB SIDE COV (Ref # 18) | 92075-041 | 4 |
| DR CHAIN 428X106 (Ref # 19) | 92057-036 | 1 |
| JOINT-CHAIN (Ref # 20) | 92058-1014 | 1 |
| SCREW PAN HEAD (Ref # 21) | 92011-020 | 2 |
| WASHER PLAIN 6MM (Ref # 22) | 411B0600 | 2 |
| SCREW PAN HEAD 5X8 (Ref # 23) | 220B0508 | 1 |
| SCREW PAN HEAD 5X12 (Ref # 24) | 220B0512 | 1 |
| WASHER PLAIN 5MM (Ref # 25) | 410B0500 | 1 |
| WASHER SPRING 5MM (Ref # 26) | 461F0500 | 2 |
| EMBLEM SIDE COVER (Ref # 27) | 56018-015 | 2 |
| EMBLEM-SIDE COVER (Ref # 29) | 56018-026 | 1 |
| EMBLEM-L.H,ORANGE (Ref # 30) | 56018-066-61 | 1 |

1974 G3SS-D PARTS LIST

OIL TANK/CHAIN COVER/CHAIN/SIDE COVER ('

| ITEM NAME | PART NUMBER | QUANTITY |
|------------------------------|--------------|----------|
| EMBLEM-R.H,PURPLE (Ref # 32) | 56018-067-61 | 1 |
| KNOB (Ref # 37) | 92077-019 | 1 |
| SCREW-PAN HEAD (Ref # 38) | 92011-021 | 1 |
| NUT 6MM (Ref # 39) | 312B0600 | 2 |
| WASHER PLAIN (Ref # 40) | 92022-024 | 1 |
| PLUG-RUBBER (Ref # 41) | 92074-018 | 1 |