

# 1969 Bushmaster PARTS DIAGRAM

CHASSIS ELECTRICAL EQUIPMENT (G3SS-C) ('

Re

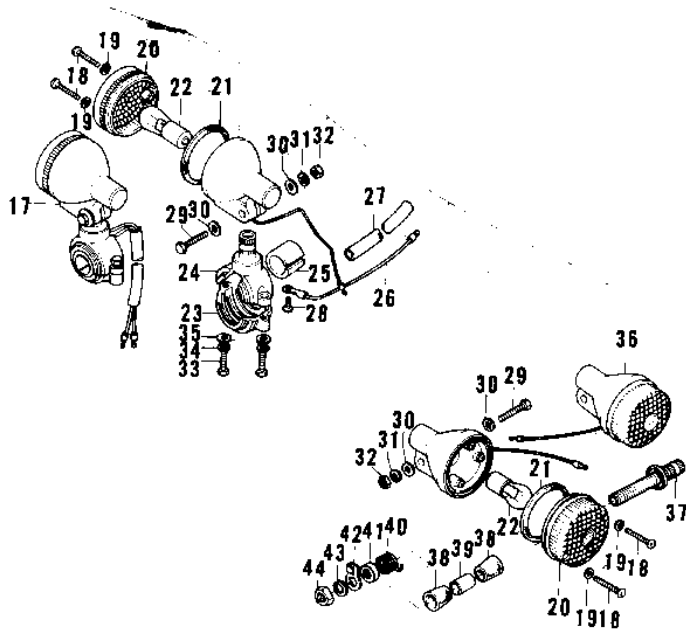
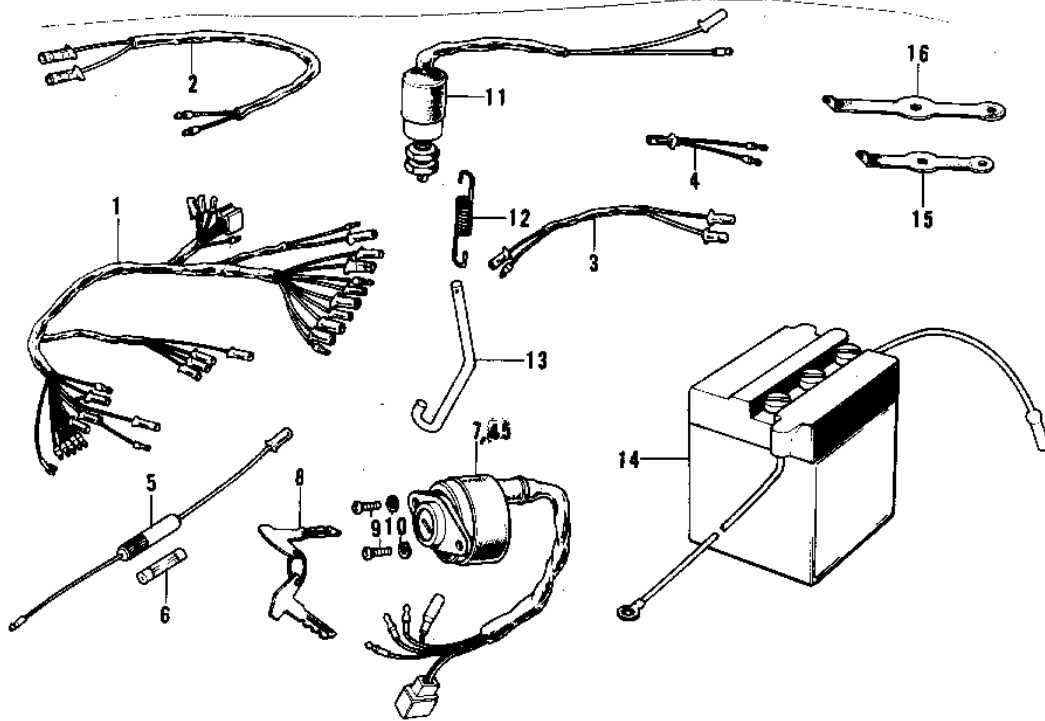

# 1969 Bushmaster PARTS LIST

## CHASSIS ELECTRICAL EQUIPMENT (G3SS-C) (

ITEM NAME	PART NUMBER	QUANTITY
WIRING HARNESS-MAIN (Ref # 1)	26001-079	1
WIRING HARNESS REAR (Ref # 2)	26002-007	1
LEAD WIRE (Ref # 3)	26011-042	1
WIRE-LEAD (Ref # 4)	26011-058	1
FUES ASSY (Ref # 5,6)	26004-008	1
FUSE 10A (Ref # 6)	26006-003	2
SWITCH ASSY,IGNITION (Ref # 7,8)	27005-1016	1
KEY SET NO.321 (Ref # 8)	27008-034-21	1
KEY SET NO.322 (Ref # 8)	27008-034-22	1
KEY SET NO.323 (Ref # 8)	27008-034-23	1
KEY SET NO.324 (Ref # 8)	27008-034-24	1
KEY SET NO.235 (Ref # 8)	27008-034-35	1
KEY SET NO.236 (Ref # 8)	27008-034-36	1
KEY SET NO.237 (Ref # 8)	27008-034-37	1
KEY SET NO.238 (Ref # 8)	27008-034-38	1
KEY SET NO.239 (Ref # 8)	27008-034-39	1
SCREW PAN HEAD 5X12 (Ref # 9)	220B0512	2
WASHER SPRING 5MM (Ref # 10)	461F0500	2
SWITCH-BRAKE LAMP (Ref # 11)	27010-018	1
SPRING BRAKE LAMP SW (Ref # 12)	27011-006	1
SPRING BRAKE LAMP SW (Ref # 13)	27012-005	1
YUA BAT 6N4-2A-5 (Ref # 14)	K26012-020	1
BAND,MIDDLE (Ref # 15)	92072-031	3
BAND,LONG (Ref # 16)	92072-032	3
LAMP ASY-FR TURN SIG (Ref # 17)	23037-005	2
SCREW-PAN HEAD,4X20 (Ref # 18)	220E0420A	8
WASHER-PLAIN,4MM (Ref # 19)	23058-002	8
LENS,TURN SIGNAL LAMP (Ref # 20)	23048-1001	4
GASKET-SIG LAMP LENS (Ref # 21)	23050-003	4

# 1969 Bushmaster PARTS LIST

## CHASSIS ELECTRICAL EQUIPMENT (G3SS-C) (

ITEM NAME	PART NUMBER	QUANTITY
BULB,6V 21CP (Ref # 22)	92069-056	4
BRACKET,SIGNAL LAMP (Ref # 23)	23051-1013	2
BRACKET,FRNT TURN SIG (Ref # 24)	23051-1004	2
DAMPER RUBBER (Ref # 25)	23066-003	2
WIRE-TURN SIGNAL LEAD (Ref # 26)	26011-061	2
COVER-WIRING HARNESS (Ref # 27)	26009-004	2
SCREW PAN HEAD 3X5 (Ref # 28)	220B0305A	2
BOLT-UPSET (Ref # 29)	112G0630	4
WASHER PLAIN 6MM (Ref # 30)	410B0600	8
WASHER SPRING 6MM (Ref # 31)	461F0600	4
NUT 6MM (Ref # 32)	311B0600	4
BOLT (Ref # 33)	110N0516	4
WASHER SPRING 5MM (Ref # 34)	461F0500	2
WASHER-PLAIN,5MM (Ref # 35)	410D0500	4
LAMP-REAR TURN SIGNAL (Ref # 36)	23040-033	2
BRACKET-TURN SIG LAMP (Ref # 37)	23051-041	2
DAMPER RUBBER (Ref # 38)	92075-148	4
COLLAR 12.7X17.3X30 (Ref # 39)	92027-168	2
SPRING (Ref # 40)	92081-111	2
WASHER CUP 12.5X35X4T (Ref # 41)	92022-235	2
CLAMP-RR SIGNAL LAMP (Ref # 42)	92037-087	2
WASHER SPRING 12MM (Ref # 43)	461F1200	2
NUT-HEX-FINE,12MM (Ref # 44)	315B1200	2
KEY,BLANK (Ref # 45)	27008-1016	1
KEY,BLANK (Ref # 45)	27008-1017	1
KEY,BLANK (Ref # 45)	27008-1018	1
KEY,BLANK (Ref # 45)	27008-1019	1